

3M™ TEXTTOOL™ RECEPTACLES FOR DIP SOCKETS

RECEPTACLE PART NUMBER	DIM. "A"	DIM. "B"	DIM. "C"	DIM. "D"	DIM. "E"	DIM. "F"	DIM. "G"	DIM. "H"	DIM. "J"	DIM. "K"	DIM. "M"	RECEPTACLE PART NUMBER	
214-3339-XX	1.00 [25.4]	.60 [15.2]	1.28 [32.6]	.82 [20.8]	.300 [7.62]	.60 [15.2]	.100 [2.54]	.40 [10.2]	.025 [0.64]	.27 [6.8]	.09 [2.3]	214-3339-XX	
216-3340-XX	.95 [24.1]	.55 [14.0]	1.37 [34.9]	.77 [19.7]		.70 [17.8]						216-3340-XX	
218-3341-XX	.95 [24.1]	.55 [14.0]	1.48 [37.5]	.77 [19.6]		.80 [20.3]						218-3341-XX	
220-3342-XX	.100 [25.4]	.60 [15.2]	1.58 [40.2]	.82 [20.8]		.90 [22.8]						220-3342-XX	
222-3343-XX	1.06 [26.9]	.65 [16.5]	1.69 [42.9]	.87 [22.1]	.400 [10.16]	1.00 [25.5]						222-3343-XX	
224-1275-XX	1.26 [32.0]	.86 [21.9]	1.77 [45.0]	1.08 [27.5]	.600 [15.24]	1.10 [27.9]		.41 [10.4]	.020 [0.50]	.29 [7.3]	.11 [2.9]	224-1275-XX	
224-5248-XX	.96 [24.4]	.56 [14.2]		.77 [19.6]	.300 [7.62]			.40 [10.2]	.025 [0.64]	.27 [6.8]	.09 [2.3]	224-5248-XX	
228-1277-XX	1.26 [32.0]	.86 [21.9]	1.98 [50.4]	1.08 [27.5]	.600 [15.24]	1.30 [33.0]		.41 [10.4]	.020 [0.50]	.29 [7.3]	.11 [2.9]	228-1277-XX	
228-4817-XX	1.06 [26.9]	.66 [16.8]		.88 [22.5]	.400 [10.16]	1.30 [33.0]		.40 [10.2]	.025 [0.64]	.27 [6.8]	.09 [2.3]	228-4817-XX	
228-1290-XX	1.09 [27.9]	.70 [17.8]	1.59 [40.5]	.92 [23.4]		.97 [24.7]	.070 [1.78]	.41 [10.4]	.024 × .010 [0.60 × 0.25]	.29 [7.3]	.11 [2.9]	228-1290-XX	
232-1285-XX	1.25 [32.0]	.86 [21.9]	2.17 [55.2]	1.08 [27.5]	.600 [15.24]	1.50 [38.2]	.100 [2.54]	.41 [10.4]	.020 [0.50]	.29 [7.3]	.11 [2.9]	232-1285-XX	
240-3639-XX	1.66 [42.2]	1.26 [32.0]	2.58 [65.6]	1.48 [37.6]	1.000 [25.40]	1.90 [48.3]		.40 [10.2]	.025 [0.64]	.27 [6.8]	.09 [2.3]	240-3639-XX	
240-1280-XX	1.26 [32.0]	.86 [21.9]		1.08 [27.5]	.600 [15.24]	1.90 [48.3]	.070 [1.78]	.41 [10.4]	.020 [0.50]	.29 [7.3]	.11 [2.9]	240-1280-XX	
242-1293-XX	1.30 [33.0]	.89 [22.5]	2.06 [52.3]	1.12 [28.5]	.600 [15.24]	1.46 [37.1]		.41 [10.4]	.024 × .010 [0.60 × 0.25]			242-1293-XX	
242-1281-XX	1.26 [32.0]	.86 [21.9]	2.68 [68.1]	1.08 [27.5]	.600 [15.24]	2.0 [50.8]	.100 [2.54]	.41 [10.4]	.020 [0.50]			242-1281-XX	
248-1282-XX	1.26 [32.0]		2.98 [75.8]	1.08 [27.5]	.600 [15.24]	2.50 [63.5]		.41 [10.4]	.020 [0.50]			248-1282-XX	
264-1300-XX	1.52 [38.5]	1.11 [28.3]	2.85 [72.5]	1.34 [34.0]	.815 [20.70]	2.23 [56.7]	.070 [1.78]	.41 [10.4]	.024 × .010 [0.60 × 0.25]	.25 [6.4]	.09 [2.3]	264-1300-XX	
264-4493-XX	1.70 [43.2]	1.30 [33.0]	3.95 [100.3]	1.52 [38.6]	.900 [22.86]	3.24 [82.4]	.100 [2.54]	.40 [10.2]	.025 [0.64]			264-4493-XX	
290-1294-XX	1.61 [40.8]	1.19 [30.2]	3.77 [95.7]	1.42 [36.0]		3.15 [79.9]	.070 [1.78]	.41 [10.4]	.024 × .010 [0.60 × 0.25]	.29 [7.3]	.11 [2.9]	290-1294-XX	

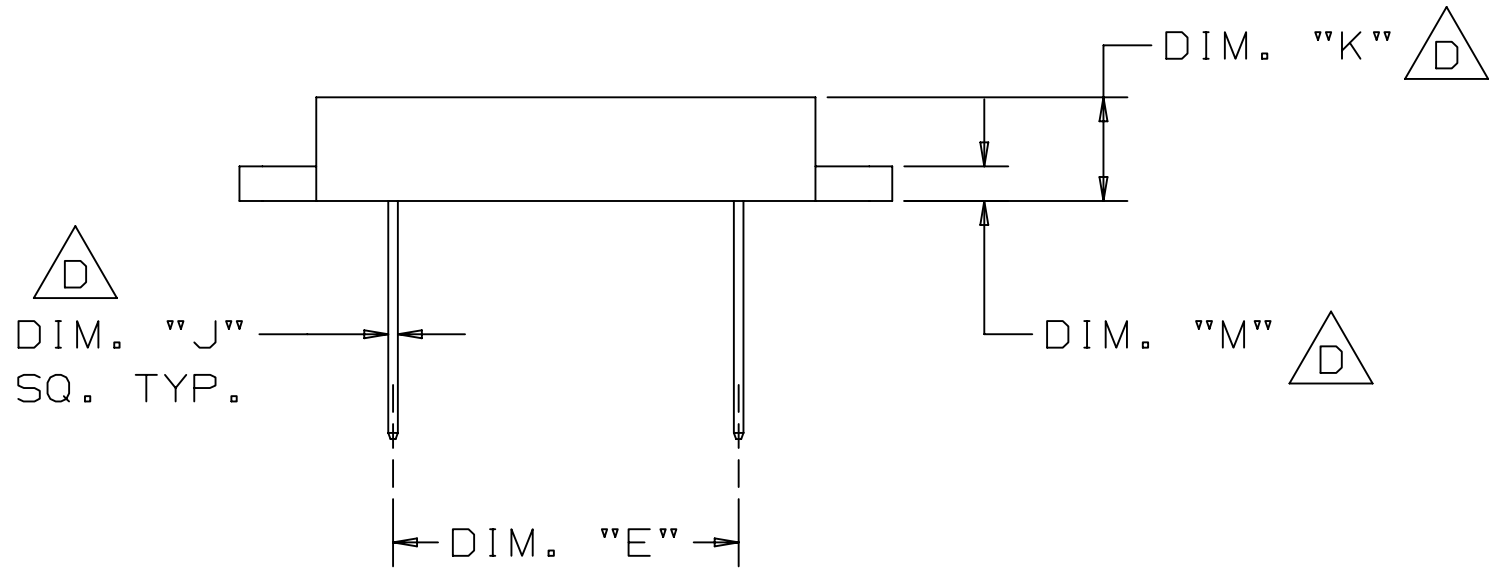
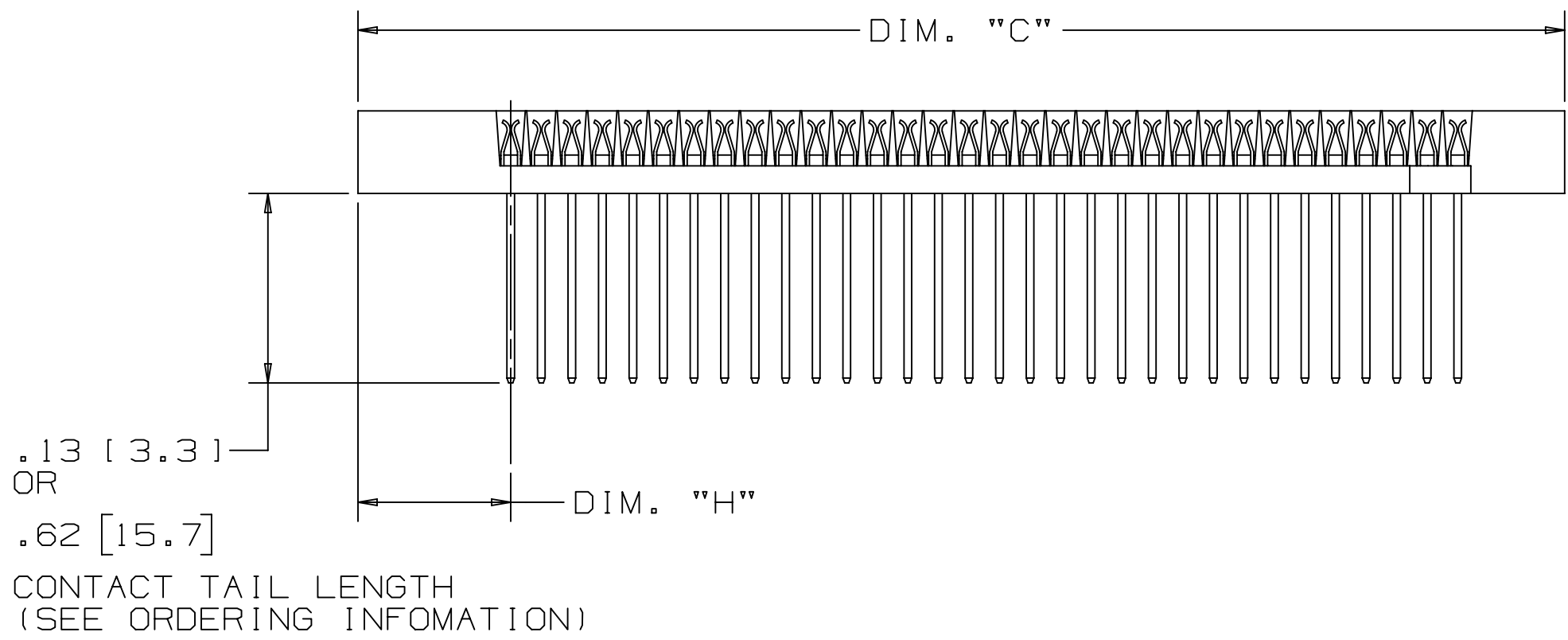
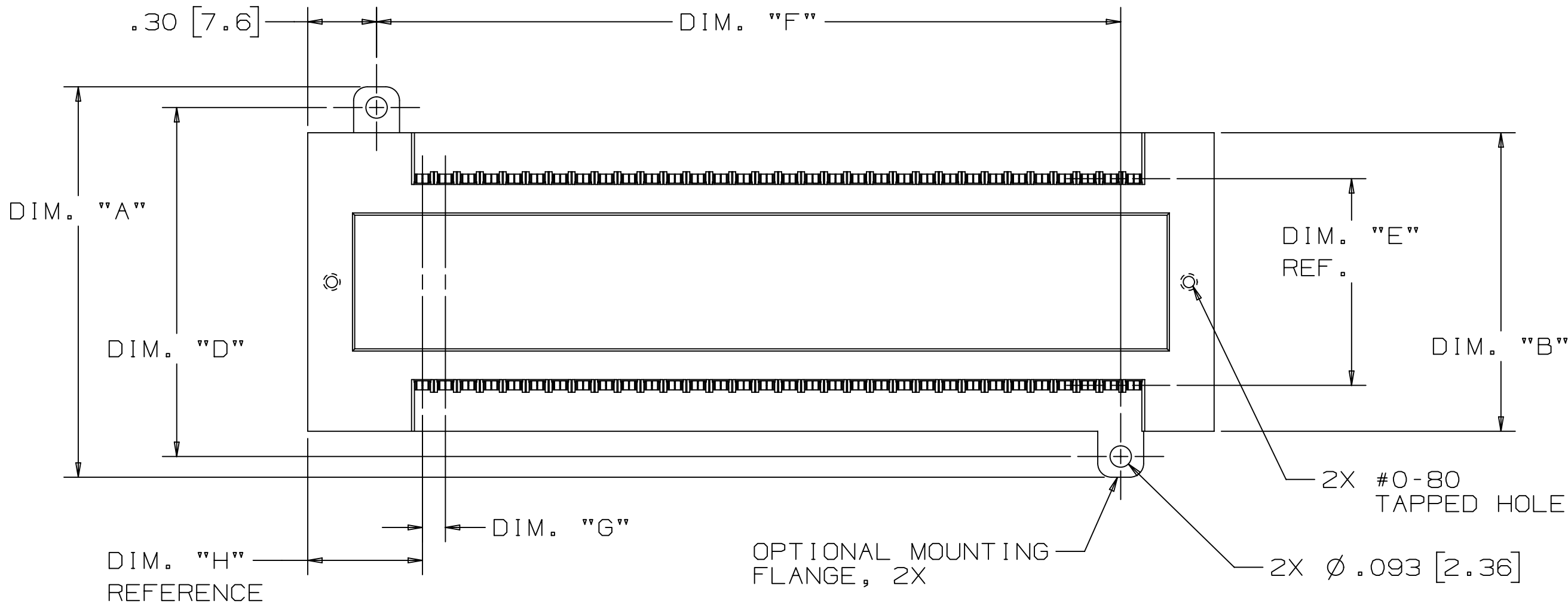

3M ELECTRONICS MATERIALS SOLUTIONS DIVISION
INTERCONNECT SOLUTIONS
<http://www.3M.com/interconnect>

3M IS A TRADEMARK OF 3M COMPANY.
FOR TECHNICAL, SALES OR ORDERING
INFORMATION CALL 800-225-5373

DESIGN REFERENCE	NEXT ASSEMBLY
ACROSS CODES	
DIVISION	DIVISION CODE EMSD
DO NOT SCALE DRAWING	SCALE 2 1
THIRD ANGLE PROJECTION	TOLERANCES EXCEPT AS NOTED
INTERPRET PER ASME Y14.5 - 2018	INCHES 0 ± .01 .000 ± .005 .0000 ±
MAX. SURFACE ROUGHNESS ALL SURFACES MARKED ONLY	MILLIMETERS 0 ± .3 .00 ± 0.13 .000 ±

D	125779	OCT 06,2025 REVISED TAB CHART	JNC	FJR
C	111457	FEB 12,2024 REVISED AND REDRAWN	JNC	FJR
B	42662	OCT 08,2012 REVISE OPERATING TEMP.	LDS	ARM
A	----	JUL 31,2012 RELEASED TO REV A REVISED	LDS	LDS
REV	ECO	ISSUE DATE AND DESCRIPTION	DRFT	CHKD
DRFT	CATTIGLIONE	DATE FEB 12,2024	MFG	DATE
CHKD		DATE	APPRV. F. RODRIGUEZ	DATE FEB 12,2024
3M 3M Center St. Paul, MN 55144				
© 3M COPYRIGHT 2025 This document and the information it contains are 3M property and may not be reproduced or further distributed without 3M permission, or used or disclosed other than for 3M authorized purposes. All rights reserved.				
TITLE TEXTTOOL RECEPTACLES FOR DIP SOCKETS				
CAGE NUMBER	SIZE	DRAWING NO.	REV.	
D	78-5100-0454-8	D		
MODEL	DET.	LISTS	YES	NO
			SHT 2 OF 3	

