

THIS INFORMATION IS CONFIDENTIAL AND IS DISCLOSED TO YOU ON CONDITION THAT NO FURTHER DISCLOSURE IS MADE BY YOU TO OTHER THAN AMP PERSONNEL WITHOUT WRITTEN AUTHORIZATION FROM AMP (TAIWAN) LTD. DIMENSIONS IN MILLIMETERS. DO NOT SCALE PRINT.

NUMBER
C-788754

3RD ANGLE PROJECTION

METRIC

PRINT DIST
DW

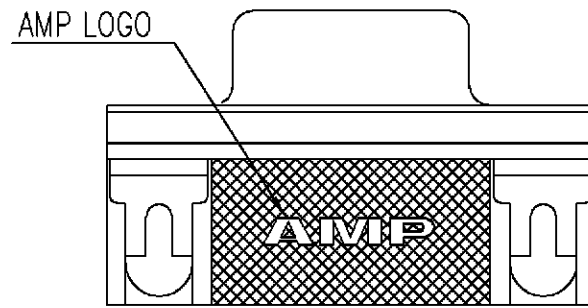
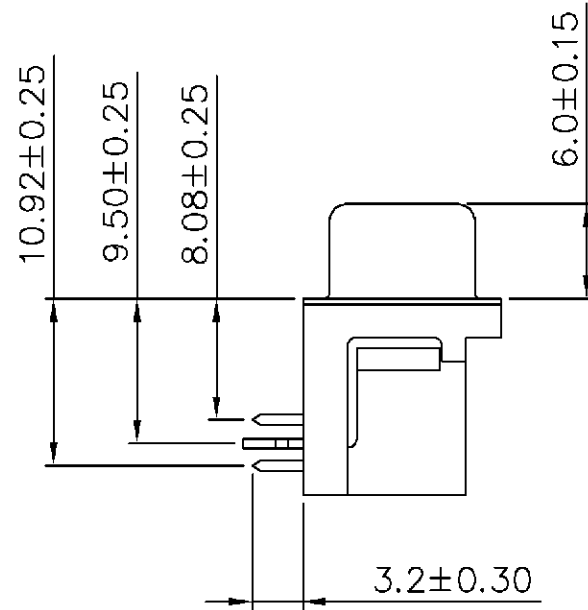
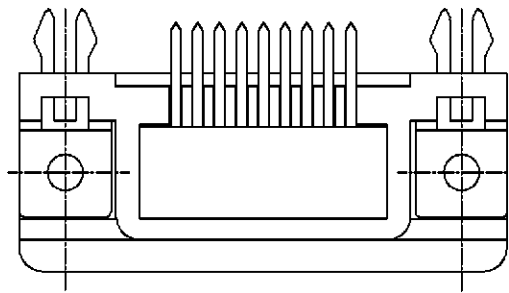
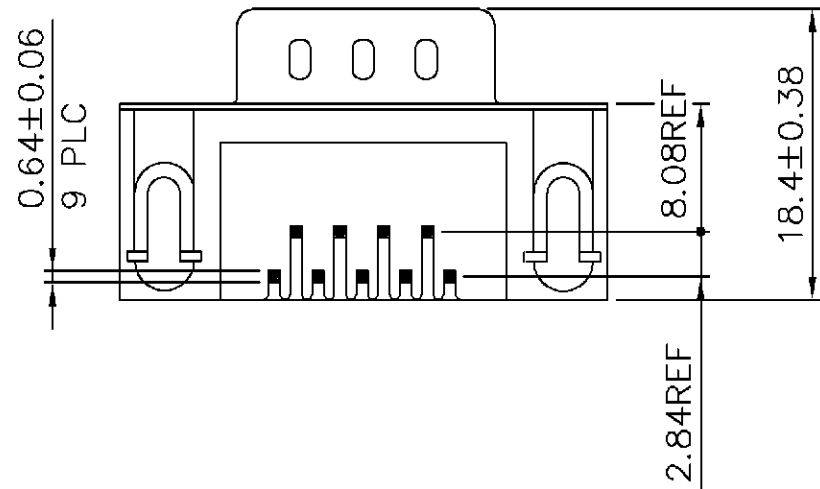
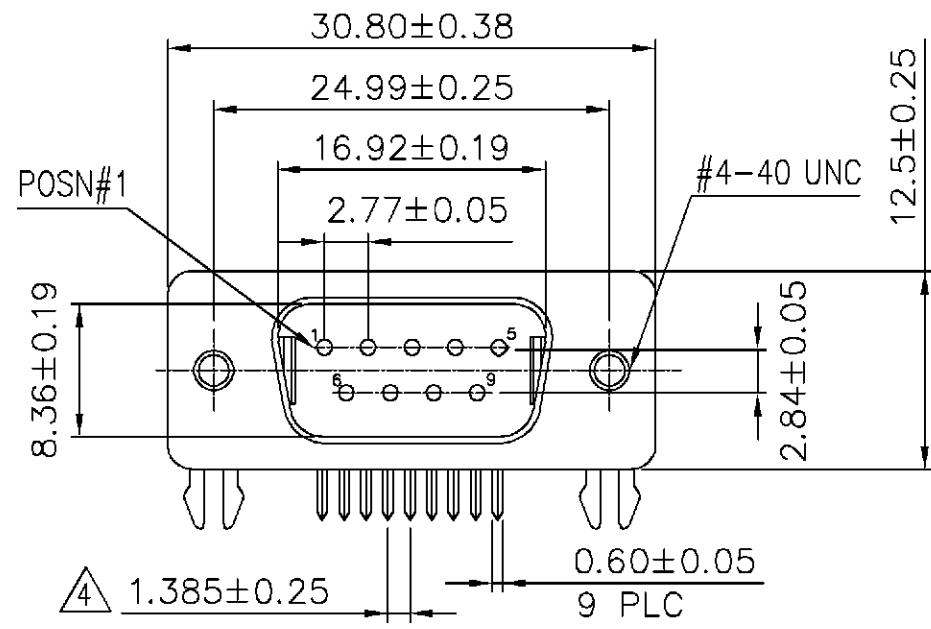

C	ADD PART NUMBER	FZ00-D144-03	OH AW	27JUN 2003
LTR	REVISION RECORD	ECN	DWN CHK	DATE

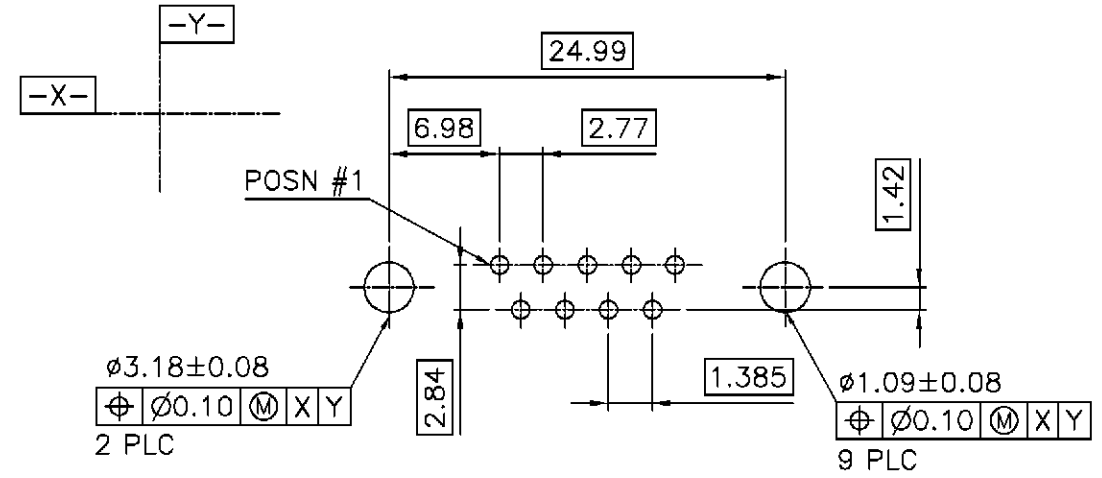

RECOMMENDED PCB LAYOUT (TOP VIEW)
(PC BOARD THICKNESS: 1.57[.062])

- 1 HOUSING: PBT, UL 94V-0 RATED, COLOR: BLACK.
CONTACTS: BRASS
SHELL: STEEL.
BOARDLOCKS: BRASS.
THREADED INSERTS: BRASS.
- 2 CONTACTS: GOLD PLATED (SEE TABLE) ON MATING END, 2.54um[.000100in] MIN TIN-LEAD ON SOLDER TAILS ALL OVER 1.27um[.000050in] MIN NICKEL ON ENTIRE CONTACT.
SHELL: NICKEL PLATED.
BOARDLOCK: SEE TABLE.
THREADED INSERT: NICKEL PLATED 0.76um[.000030in].
- 3 SPECIFICATIONS:
CURRENT RATING: 2 AMPS. (SIGNAL APPLICATION ONLY)
VOLTAGE RATING: 250 VAC.
DIELECTRIC WITHSTANDING VOLTAGE: 500 VAC(RMS).
INSULATION RESISTANCE: 1000 MEGOHMS MIN.
CONTACT RESISTANCE: 20 MILLIOHMS MAX.
OPERATING TEMPERATURE: -55° TO 105°C.
- 4 DIMENSION IS NON-CUMULATIVE.
- 5. SPECIFICATIONS SUBJECT TO CHANGES WITHOUT NOTICE.
CONTACT AMP FOR THE LATEST SPECIFICATIONS.

TRAY	0.25um[.000010in] TIN-LEAD	GOLD FLASH	788754-5
TUBE		0.25um[.000010in]	788754-4
TRAY	0.25um[.000010in] TIN OR TIN-LEAD	0.25um[.000010in]	788754-3
		0.38um[.000015in]	788754-2
		GOLD FLASH	788754-1
PACKAGING	BOARDLOCK PLATED	GOLD PLATING	PART NUMBER

TOLERANCES UNLESS OTHERWISE SPECIFIED: 0 PLC ± 1 PLC ± 0.30 2 PLC ± 0.20 3 PLC ± 0.10 ANGLES ±	DWN O. HU 23-JUN-2003 CHK A. WU 23-JUN-2003	tyco Electronics TYCO HOLDINGS (BERMUDA) VII LTD. TAIWAN BRANCH
MATERIAL	APVD J. CHENG 23-JUN-2003	NAME
SEE NOTE 1	PRODUCT SPEC SEE NOTE 3	PLUG ASSEMBLY, 9 POSN, RIGHT ANGLE, 8.08mm[0.318in]
FINISH	QUALIFICATION TEST REPORT	LOC DW A3
SEE NOTE 2	WEIGHT	SIZE C-788754
		DRAWING NO C-788754
		SCALE 1:1
		REV C
		SHEET 1 OF 1