

Spec Sheet

Wire-wound Ferrite Power Inductors LLXB/LLXN/LLXP series for Medical Devices classified as GHTF Classes A or B (Japan Classes I or II)

LLXBD4040TKL220M (Previous PN: NR4018T220M)

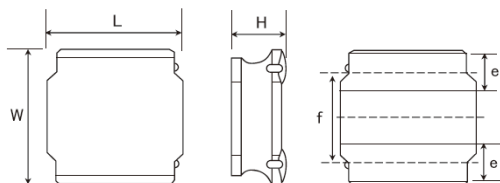

Features

- Item Summary
22uH \pm 20%, 0.59A, 4.0x4.0x1.8mm
- Lifecycle Stage
Phaseout
- Standard packaging quantity (minimum)
Taping Embossed 3500pcs

Products characteristics table

Inductance	22 uH \pm 20 %
Case Size (mm)	4.0x4.0
Rated Current (max)	0.59 A
Saturation Current (max)	0.8 A (Δ L=30%)
Temperature Rise Current (max)	0.59 A (Δ T=40°C)
DC Resistance (max)	0.432 Ω
DC Resistance (typ)	0.36 Ω
Self Resonant Frequency (min)	16 MHz
Operating Temp. Range	-25 to +120 °C (Including self-generated heat)
Temperature characteristic (Inductance change)	\pm 20 %
Measuring Frequency	100 kHz
RoHS Compliance (10 subst.)	Yes
REACH Compliance (251 subst.)	Yes
Halogen Free	Yes
Soldering	Reflow

External Dimensions

Dimension L	4.0 \pm 0.2 mm
Dimension W	4.0 \pm 0.2 mm
Dimension H	Max 1.8 mm
Dimension e	1.1 \pm 0.2 mm
Dimension f	2.5 \pm 0.2 mm

Recommended Land Patterns

【推奨ランドパターン】 実装上の注意 ・実装状態を確認の上ご使用くださいますようお願いいたします。 ・本製品のはんだ付けはリフローはんだ工法に限りま。
【Recommended Land Pattern】 Surface Mounting ・Mounting and soldering conditions should be checked beforehand. ・Applicable soldering process to these products is reflow soldering only.

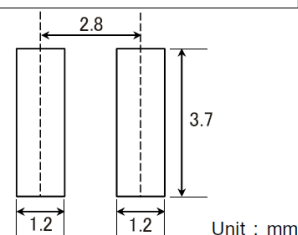

The data is reference only. Electrical characteristics vary depending on environment or measurement condition.
 TAIYO YUDEN reserves the right to make change to the Data at any time without notice.
 Before making final selection, please check product specification.

2025.11.14