

THE INFORMATION CONTAINED IN THIS DRAWING IS THE SOLE PROPERTY OF EASE ELECTRONICS. ANY REPRODUCTION IN PART OR WHOLE WITHOUT THE WRITTEN PERMISSION OF EASE ELECTRONICS IS PROHIBITED.

REV	DESCRIPTION	DATE	APPROVED
A	INITIAL RELEASE	9/10/25	CHILLY. L

D

D

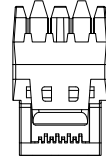
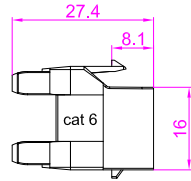

Available in Different Colors

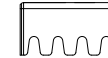
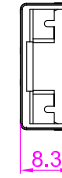
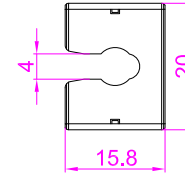
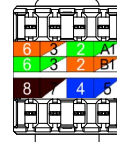
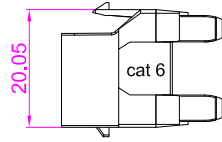
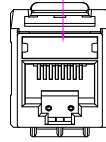

Module Clamp

C

C

#### MATERIAL

Keystone Jack Housing: PC UL94V-0  
PIN: Phosphor Bronze C5210, t=0.3mm, 50u" Gold over Contact Pin over 60u" Nickel Plating Undercoat  
PCB Board: FR-4  
Insertion Life: 750 Mating Cycles  
Insertion and Extraction Force: ≤ 20N  
IDC Housing: PC UL94V-0  
Contact Compatibility: 22 ~ 26 AWG  
IDC Contact: Phosphor Bronze C5191, t=0.4mm, Nickel Plating 100u"  
Durability: 200 Mating Cycles

#### PHYSICAL CHARACTERISTICS

Operating Temperature Range: -10 °C to 60 °C  
Storage Temperature Range: -40 °C to 68 °C  
Humidity: 10% ~ 90%

#### ELECTRICAL

Insulation Resistance: 500 mΩ  
Dielectric Withstanding Voltage: 1000 V  
DC Current Rating: 1.5 Amps  
DC Resistance: 0.1 Ω  
Contact Resistance: 20 mΩ

#### Mounting Type

Patch Panel, Faceplates/Wall Plates, Surface Mount Boxes

UNIT: MM

#### Part Number Table

PART NUMBER	DESCRIPTION	DWG. NO.
RJ45-6JUD-180BK	Cat.6 RJ45 110 Type 180° UTP Keystone Jack, Black	J0146
RJ45-6JUD-180BL	Cat.6 RJ45 110 Type 180° UTP Keystone Jack, Blue	J0147
RJ45-6JUD-180GN	Cat.6 RJ45 110 Type 180° UTP Keystone Jack, Green	J0148
RJ45-6JUD-180GY	Cat.6 RJ45 110 Type 180° UTP Keystone Jack, Gray	J0149
RJ45-6JUD-180IV	Cat.6 RJ45 110 Type 180° UTP Keystone Jack, Ivory	J0150
RJ45-6JUD-180OR	Cat.6 RJ45 110 Type 180° UTP Keystone Jack, Orange	J0151
RJ45-6JUD-180RD	Cat.6 RJ45 110 Type 180° UTP Keystone Jack, Red	J0152
RJ45-6JUD-180WT	Cat.6 RJ45 110 Type 180° UTP Keystone Jack, White	J0153
RJ45-6JUD-180YW	Cat.6 RJ45 110 Type 180° UTP Keystone Jack, Yellow	J0154

A

A

UNLESS OTHERWISE SPECIFIED, DIMENSIONS ARE IN INCHES [mm]  OVERALL CABLE LENGTH TOLERANCE: ≤12 [305] = +1 [25] / -0 >12 [305] ≤60 [1524] = +2 [51] / -0 >60 [1524] ≤120 [3048] = +4 [102] / -0 >120 [3048] ≤300 [7620] = +6 [152] / -0 >300 [7620] = +5% / -0%  ALL OTHER DIMENSIONAL TOLERANCES: .X = .3 .XX = .15  PROJECTION 	APPROVALS	DATE	<b>EASE</b> Ease Electronics Co., Limited Zone A, 2nd Floor, Bldg A, No.45, Qianjin 3rd Rd, Tanzhou, 528467 Zhongshan, Guangdong, China. +86-756-58 8881 0	
	DRAWN BY LUKE. L	8/10/2025		
	CHECKED BY TILLY. H	8/10/2025	PART NUMBER <b>RJ45-6JUD-180GN</b>	
	APPROVED BY CHILLY. L	9/10/2025	PRODUCT DESCRIPTION <b>Cat.6 RJ45 110 Type 180° UTP Keystone Jack, Green</b>	
CONFIGURATION DETAILS OF UNDIMENSIONED FEATURES MAY VARY		ID <b>J</b>	SERIES NO. <b>RJ45-J</b>	DWG. NO. <b>J0148</b>
COLOR VARIATIONS MAY OCCUR		REF	SCALE: NONE	CAD FILE: J0148
				SHEET 1 OF 1

6

5

4

3

2

1