

NOTES:

1. ALL PARTS TO BE BULK PACKED.
2. CONTACTS TO BE INSERTED INTO HOUSING
3. ALL DIMENSIONS ARE REFERENCE EXCEPT THOSE WITH A TOLERANCE

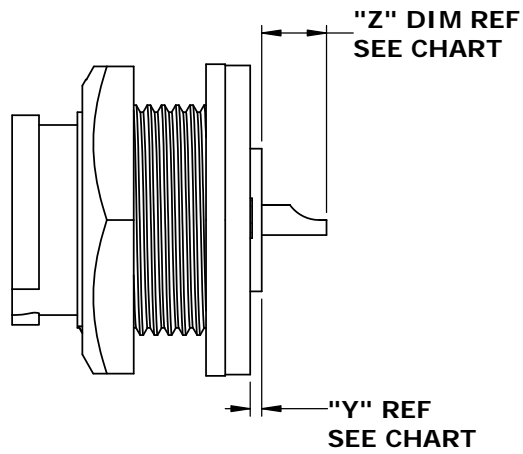

**ASSEMBLED VIEW**  
W7282-2PG-P-300 SHOWN

ASSEMBLY P/N	CONTACT QTY.	"X" REF	"Y" REF	"Z" REF
W7282-2PG-P-300	2 #20	.650 [16.5]	.030 [.8]	.169 [4.3]
W7282-3PG-P-300	3 #20	.667 [16.9]	.047 [1.2]	.152 [3.9]
W7282-4PG-P-300	4 #20	.667 [16.9]	.047 [1.2]	.152 [3.9]
W7282-5PG-P-300	5 #20	.667 [16.9]	.047 [1.2]	.152 [3.9]
W7282-6PG-P-300	6 #20	.667 [16.9]	.047 [1.2]	.152 [3.9]
W7282-7PG-P-300	7 #20	.670 [17.0]	.050 [1.3]	.149 [3.8]
W7282-8PG-P-300	8 #20	.670 [17.0]	.050 [1.3]	.149 [3.8]

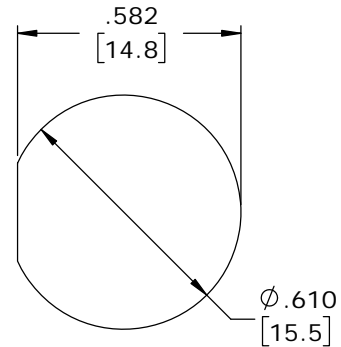

**RECOMMENDED  
PANEL CUTOUT**  
TOLERANCE ±.003 [.08]

## CUSTOMER APPROVAL

THIS DOCUMENT CONTAINS CONFIDENTIAL INFORMATION PROPRIETARY TO CONXALL CORPORATION. ANY REPRODUCTION, DISCLOSURE, OR USE OF THIS DOCUMENT /INFORMATION IS EXPRESSLY PROHIBITED UNLESS AUTHORIZED IN WRITING BY CONXALL CORPORATION.

APPROVED BY: \_\_\_\_\_

DATE: \_\_\_\_\_

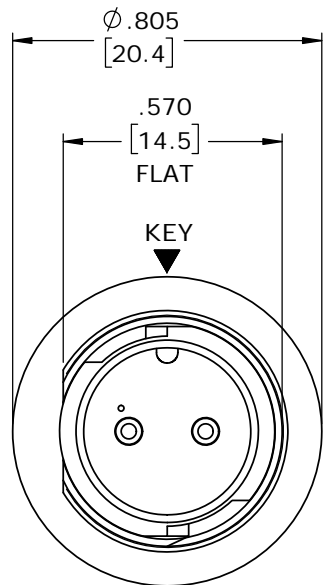

**MATING FACE**  
W7282-2PG-P-300 SHOWN

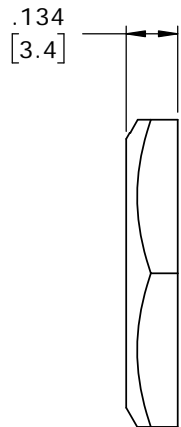

HEX NUT  
MAT'L: UV PBT, BLACK

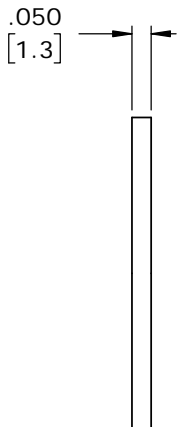

GASKET  
MAT'L: NEOPRENE, BLACK  
B

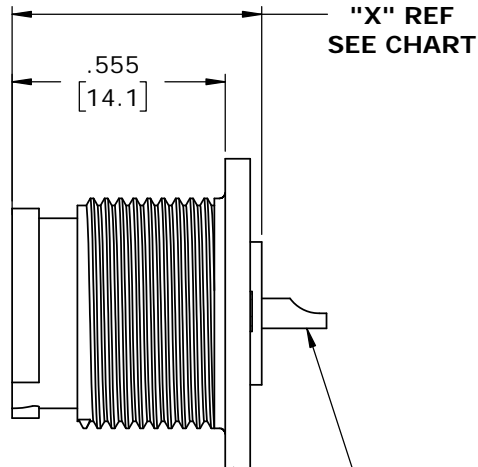

PANEL CONNECTOR, MALE  
MAT'L: UV PBT, BLACK

(2-8) #20 PIN CONTACTS, SOLDER  
MAT'L: GOLD PLATED COPPER ALLOY

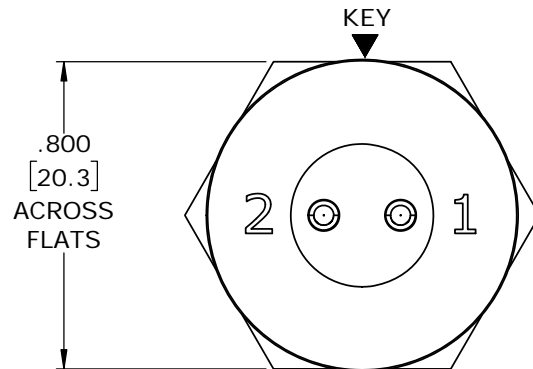

**WIRING END**  
W7282-2PG-P-300 SHOWN

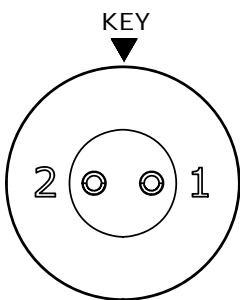

**WIRING END**  
W7282-2PG-P-300

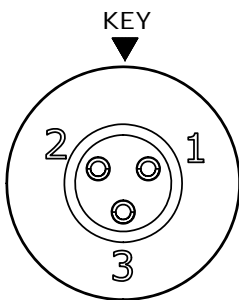

**WIRING END**  
W7282-3PG-P-300

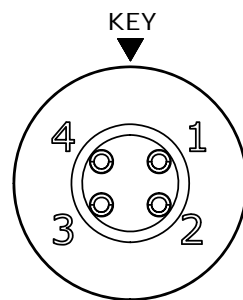

**WIRING END**  
W7282-4PG-P-300

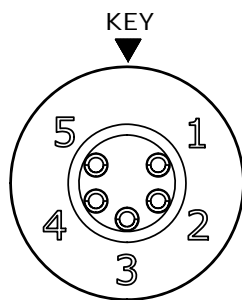

**WIRING END**  
W7282-5PG-P-300

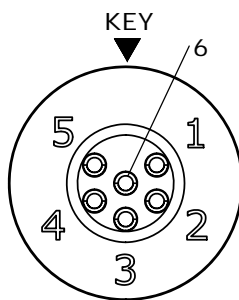

**WIRING END**  
W7282-6PG-P-300

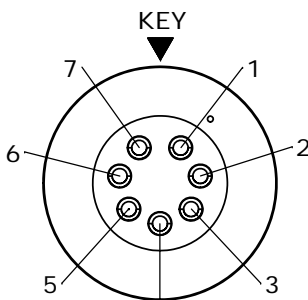

**WIRING END**  
W7282-7PG-P-300

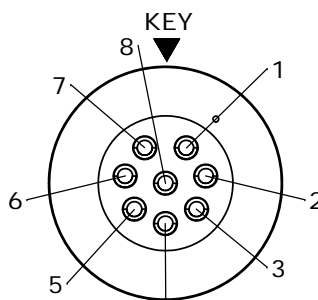

**WIRING END**  
W7282-8PG-P-300

**RoHS COMPLIANT**

B	MA	04-01-20	GASKET MATERIAL WAS NITRILE PER ECR 9512	
A	MA	01-16-20	RELEASED PER PDR 16014	
	PNK	01-08-18	DRAWING CREATED PER PDR16014	
REV.	INIT.	DATE	DESCRIPTION	
ALL INFORMATION ILLUSTRATED IS THE PROPERTY OF "CONXALL CORPORATION". UNAUTHORIZED DUPLICATION OR DISTRIBUTION OF THIS DOCUMENT IS PROHIBITED.			ORIG. DRAWN BY: PNK	DATE: 01-08-18
ALL UNITS ARE IN FEET, INCHES, FRACTION OF INCHES AND DECIMALS.			CHECKED BY:	 601 E. WILDWOOD VILLA PARK, IL 60181
			APPROVED BY:	
			SCALE: NTS SIZE: B SHEET: 1 OF 1	
			FILE: W7282-XPG-P-300 DIRECTORY: SLW	TITLE: PANEL-MOUNT ASSEMBLY (2-8) #20 PIN CONTACTS, SOLDER INSTA-CLICK™ MINI-CON-X CUSTOMER: STANDARD PRODUCT
			PART NUMBER: W7282-XPG-P-300	REV B

DIMENSIONS IN BRACKETS [ ] ARE IN MILLIMETERS