

NOTES:

- CONNECTORS TO BE PACKED IN PARTITION BOX, 200 PC PER BOX  
HEX NUT AND GASKET TO BE BULK PACKED IN A SEPARATE BAG FROM ASSEMBLY PACKAGE.
- CONTACTS TO BE INSERTED INTO HOUSING.
- BACK OF CONNECTOR TO BE FILLED WITH EPOXY
- SEE DRAWING HPMISTD FOR HOLE PATTERN.
- ALL DIMENSIONS ARE REFERENCE EXCEPT THOSE WITH A TOLERANCE

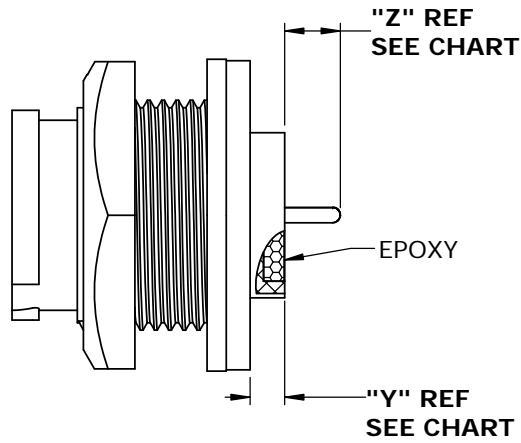

**ASSEMBLED VIEW**  
W7281-2SG-P-3ES SHOWN

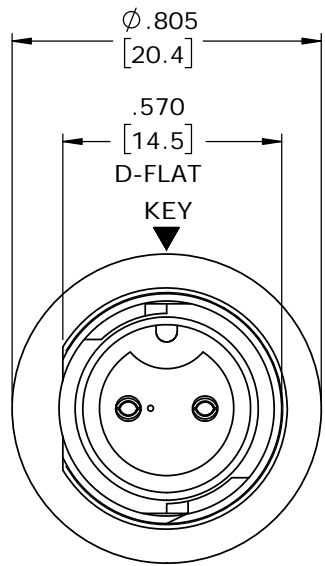

**MATING FACE**  
W7281-2SG-P-3ES SHOWN

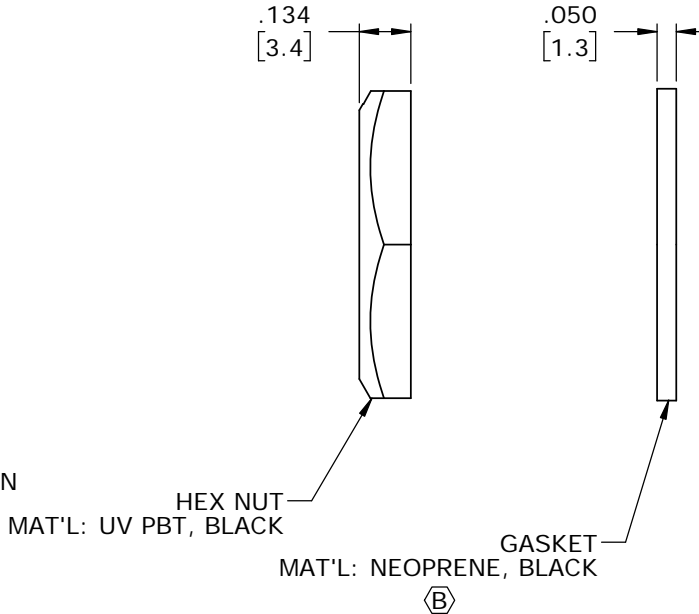

HEX NUT  
MAT'L: UV PBT, BLACK

GASKET  
MAT'L: NEOPRENE, BLACK  
B

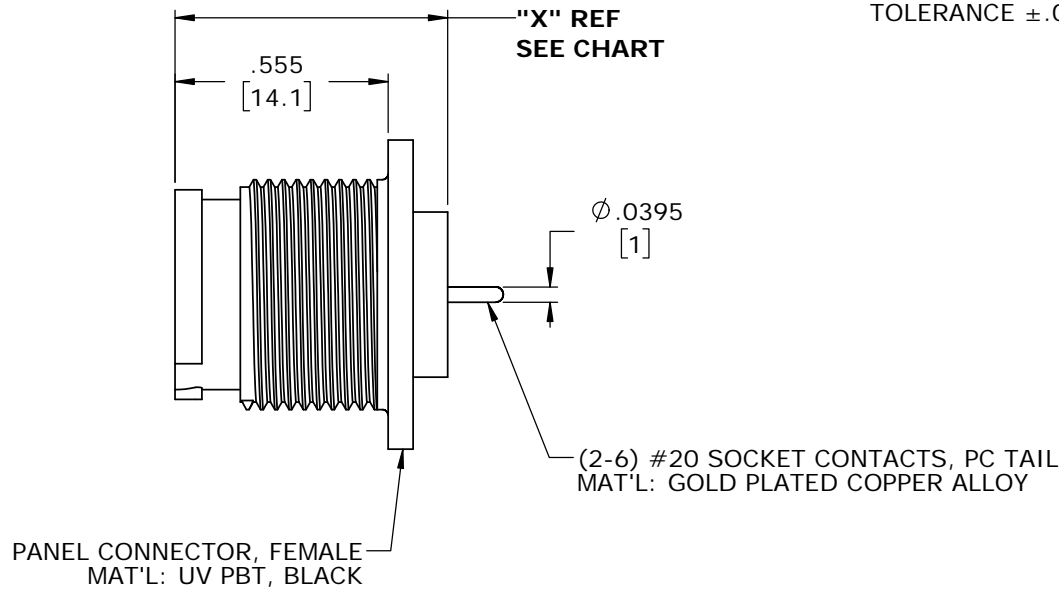

PANEL CONNECTOR, FEMALE  
MAT'L: UV PBT, BLACK

(2-6) #20 SOCKET CONTACTS, PC TAIL  
MAT'L: GOLD PLATED COPPER ALLOY

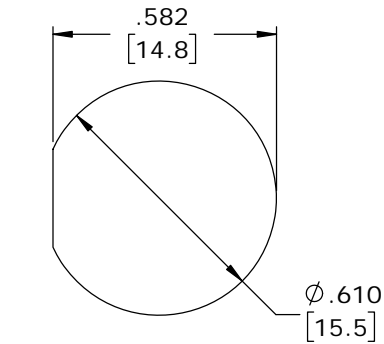

**RECOMMENDED  
PANEL CUTOUT**  
TOLERANCE ±.003 [0.08]

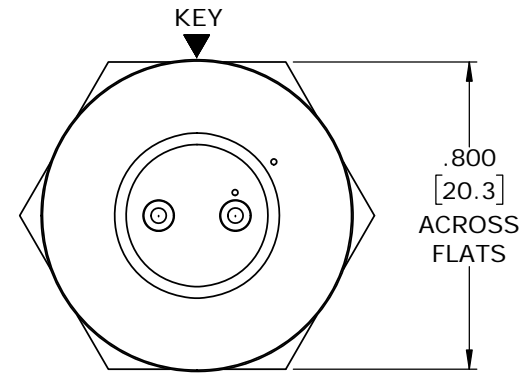

**WIRING END**  
W7281-2SG-P-3ES SHOWN

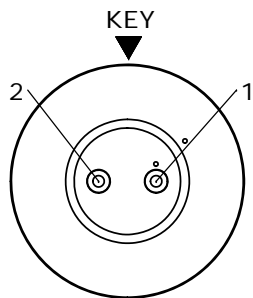

**WIRING END**  
W7281-2SG-P-3ES

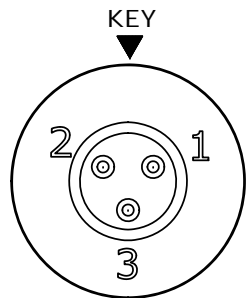

**WIRING END**  
W7281-3SG-P-3ES

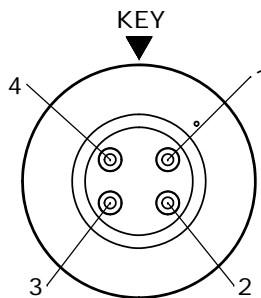

**WIRING END**  
W7281-4SG-P-3ES

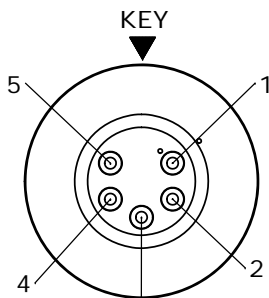

**WIRING END**  
W7281-5SG-P-3ES

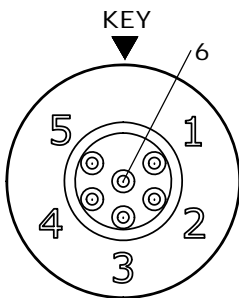

**WIRING END**  
W7281-6SG-P-3ES

DIMENSIONS IN BRACKETS [ ] ARE IN MILLIMETERS

RoHS COMPLIANT

ASSEMBLY P/N	CONTACT QTY.	"X" REF	"Y" REF	"Z" REF
W7281-2SG-P-3ES	2 #20	.710 [18.0]	.090 [2.3]	.145 [3.7]
W7281-3SG-P-3ES	3 #20	.663 [16.8]	.043 [1.1]	.192 [4.9]
W7281-4SG-P-3ES	4 #20	.710 [18.0]	.090 [2.3]	.145 [3.7]
W7281-5SG-P-3ES	5 #20	.710 [18.0]	.090 [2.3]	.145 [3.7]
W7281-6SG-P-3ES	6 #20	.663 [16.8]	.043 [1.1]	.192 [4.9]

CUSTOMER APPROVAL
THIS DOCUMENT CONTAINS CONFIDENTIAL INFORMATION PROPRIETARY TO CONXALL CORPORATION. ANY REPRODUCTION, DISCLOSURE, OR USE OF THIS DOCUMENT /INFORMATION IS EXPRESSLY PROHIBITED UNLESS AUTHORIZED IN WRITING BY CONXALL CORPORATION.
APPROVED BY: _____
DATE: _____

B	MA	04-01-20	GASKET MATERIAL WAS NITRILE PER ECR 9512
A	MA	01-17-20	RELEASED PER PDR 16014
	PNK	01-08-18	DRAWING CREATED PER PDR16014
REV.	INIT.	DATE	DESCRIPTION
			ALL INFORMATION ILLUSTRATED IS THE PROPERTY OF "CONXALL CORPORATION". UNAUTHORIZED DUPLICATION OR DISTRIBUTION OF THIS DOCUMENT IS PROHIBITED.
			ALL UNITS ARE IN FEET, INCHES, FRACTION OF INCHES AND DECIMALS.
			ORIG. DRAWN BY: PNK DATE: 01-08-18
			CHECKED BY:
			APPROVED BY:
			SCALE: NTS SIZE: B SHEET: 1 OF 1
			FILE: W7281-XSG-P-3ES DIRECTORY: SLW
			TITLE: PANEL MOUNT ASSEMBLY (2-6) #20 SOCKET CONTACTS, PC, EPOXY INSTA-CLICK™ MINI-CON-X CUSTOMER: STANDARD PRODUCT
			PART NUMBER: W7281-XSG-P-3ES REV B