

XJTM Series - Advanced Pure Sinewave Inverters

XJTM Series – XUNZEL

State of the art and easy to use design, these inverters will offer you reliable service for providing AC power and 5V USB power from battery.

True sine wave output. Ideal for operating motor loads, fine electronics and reduce stress on surge protections circuitry, meaning potentially longer equipment life.

Product features

- Pure sine wave (**True Sine Wave**) AC output, with very low Total Harmonic Distortion (THD). Ensure the correct functioning of sensitive devices.
- Converts battery DC power to AC power anywhere with high efficiency.
- Very low self-consumption. **Power Save Mode**. Get the maximum energy of your batteries. Designed for "always-on". High efficiency cooling design.
- **Silent Operation**. Lightweight and robust. **High Resistance Anodized Aluminium Case**. (excl. XJ-400W model)
- High surge capacity (2 x constant).
- With digital display and/or LED monitoring for easy and quick status reading and programming.
- Low battery alarm and shutdown protection to prevent the battery from too deep discharges. Extend the life of your batteries.
- Automatic shutdown protections integrated: overtemperature, short-circuit, overload and low/high battery conditions.
- Easy to install and use. Mounting brackets for permanent installation.
- Safe and reliable.
- **USB 5V-2100mA** "always-ON" output to feed and charge electronic devices.
- Isolation between DC input and AC output for safety.
- **Heavy duty DC input terminals** for direct, simple and secure battery connection.
- Preferred choice for powering off-grid, off-shore, onboard and back-up electronics, sensitive loads and demanding motor loads, including digital clocks, dimmers, variable speed motors, battery chargers, and telecom/audio/visual equipment.
- International output sockets available (available per country) on demand.
- **E-mark approved**
- **Full range of optional accessories available:**
 - Battery Cable Connection Kits and In-Line Fuse & Holder
 - Remote Control ON/OFF with 6-meter cable (code: **RCXJ**)
 - Automatic-Start-XJ (code: **ASXJ**)
 - Smart-StartTM-XJ: 3-positions ON/OFF/Remote (code: **SM2XJ**)
 - XJ-OnBoardTM Systems (code: **XJONBOARD**)
 - Automatic Transfer Switch (code: **TSXJ10**)

Available Models

• XJ-400W-12V-Handy	400W / 12VDC / 1x 230VAC 50Hz
• XJ-600W-12V	600W / 12VDC / 1x 230VAC 50Hz + USB 5VDC 2.1A
• XJ-1000W-12V	1000W / 12VDC / 1x 230VAC 50Hz + USB 5VDC 2.1A
• XJ-2000W-12V	2000W / 12VDC / 2x 230VAC 50Hz + USB 5VDC 2.1A
• XJTS-3000W-12V	3000W / 12VDC / 2x 230VAC 50Hz + USB 5VDC 2.1A +Transfer Switch
• XJ-500W-24V	500W / 24VDC / 1x 230VAC 50Hz + USB 5VDC 2.1A
• XJ-1000W-24V	1000W / 24VDC / 1x 230VAC 50Hz + USB 5VDC 2.1A
• XJ-2000W-24V	2000W / 24VDC / 2x 230VAC 50Hz + USB 5VDC 2.1A
• XJTS-3000W-24V	3000W / 24VDC / 2x 230VAC 50Hz + USB 5VDC 2.1A +Transfer Switch

© Copyright XUNZELTM reserves the right to make changes and improvements without prior notice. Specifications are subject to change without further notification

The design and all photos and drawings of these sheets are protected by law and may not be distributed, reproduced, in whole or in part, published or used for any purpose without the express written consent of XUNZEL. © XUNZEL - Xunzel is not responsible for possible typographical errors.



XJ-2000W-12V
XJ-2000W-24V

XJ-1000W-12V
XJ-1000W-24V

XJ-600W-12V
XJ-500W-24V

XJ-400W-12V
-HANDY



E-Mark



XJTS-3000W-12V
XJTS-3000W-24V

With **Transfer-Switch**. Integrated mains priority circuit with voltage synchronization



XJ-2000W

Digital display and USB 2.1A output
(for models XJ-1000W, 2000W and 3000W)



XJ-2000W

Heavy duty DC terminal. More Safety

Industry Leading Technology for Off-Grid, Off-Shore and Backup Power Applications



© Copyright Xunzel. Information contained in this document is subject to change without notice.



info@xunzel.com
www.xunzel.com

XU-92250814-MA

XJTM Series - Advanced Pure Sinewave Inverters

Product features

- **Maintenance Free True Sine Wave Output** is ideal for operating motors, permanent loads, and to reduce stress on surge protection circuitry, meaning potentially longer equipment life.
- Audio alarm with warning/error codes to alert user to check inverter condition before unit shutdown.
- Automatic shutdown protects overload, over temperature and low/high battery conditions.
- High surge capacity for products that require more power to start (2 x constant).
- High efficiency conversion of battery available power to AC power.

Efficient Automatic Cooling System. Hi-efficiency and silent.

Heavy duty DC battery stud connectors. More Safety.

Socket outlet with safety shutter protection offers increased contact protection and protects from dust and dirt. SCHUKO®, International and Special sockets available.



Certified for Automotive



True / Pure Sine Wave. All loads – including sensitive ones – will perform better, run cooler, and generate low harmonic distortion when connected to this waveform.



Ground lug to provide an excellent way to ground numerous high current accessories to the same point.

Anodized Aluminum Body with stainless steel screws. Installation is robust, safe, quick and easy, requiring only mounting screws for the plate and connection of the DC power.

Control Unit with Digital Display. Easy to use and program different user modes.



The design and all photos and drawings of these sheets are protected by law and may not be distributed, reproduced, in whole or in part, published or used for any purpose without the express written consent of XUNZEL. © XUNZEL - Xunzel is not responsible for possible typographical errors.

© Copyright XUNZEL™ reserves the right to make changes and improvements without prior notice.

XU-92250814-MA

Industry Leading Technology for Off-Grid, Off-Shore and Backup Power Applications



info@xunzel.com
www.xunzel.com

© Copyright Xunzel. Information contained in this document is subject to change without notice.

XJ™ Series - Advanced Pure Sinewave Inverters

Technical Specifications

MODEL	XJ-400W-12V-HANDY	XJ-600W-12V	XJ-1000W-12V	XJ-2000W-12V	XJ-500W-24V	XJ-1000W-24V	XJ-2000W-24V
XUNZEL Code	XJ4001202HCA	XJ6001202U	XJ10001202U	XJ20001202U	XJ5002402U	XJ10002402U	XJ20002402U
INVERTER							
AC Output Power Nominal / Peak at any temperature	400/800W	600/1200W	1000/2000W	2000/4000W	500/1000W	1000/2000W	2000/4000W
AC Output Current	1.74A _{AC}	2.60A _{AC}	4.35A _{AC}	8.70A _{AC}	2.17A _{AC}	4.35A _{AC}	8.70A _{AC}
AC Output Voltage / Frequency	230V _{AC} / 50Hz						
AC Output Waveform	Real Pure Sinewave Output (THD<3%)						
Peak Efficiency	> 95%						
Nominal DC Input Voltage	12.50V _{DC}				25.00V _{DC}		
DC Input Operation Range	10.5 - 15.5V _{DC}				21.0 – 31.0V _{DC}		
Power Saving Mode	N/A	YES					
No Load Current with Power Save Mode OFF/ON	<0.80A _{DC}	<0.80/0.20A _{DC}	<1.50/0.17A _{DC}		<0.50/0.10A _{DC}	<0.60/0.10A _{DC}	
Under Voltage Shutdown	10.50V _{DC}				21.00V _{DC}		
Under Voltage Recovery	12.00V _{DC}				23.60V _{DC}		
Over Voltage Shutdown	15.90V _{DC}		15.75V _{DC}		31V _{DC}		
AC Output Port	1x EU schuko socket			2x EU schuko socket	1x EU schuko socket		2x EU schuko socket
Power Save Mode OFF/ON Load Sense Threshold	N/A	≤5W / ≥10W	≤3W / ≥10W		≤5W / ≥10W	≤3W / ≥10W	
USB port	N/A	5V _{DC} -2100mA _{DC}					
Battery Minimum Capacity	> 78Ah-12V	> 120Ah-12V	> 240Ah-12V	> 480Ah-12V	> 78Ah-24V	> 120Ah-24V	> 240Ah-24V
Display	LED indicators		LCD display + LED indicators		LED indicators	LCD display + LED indicators	
SAFETY AND ENVIRONMENTAL							
Standards	CE UKCA RoHS3 and REACH Compliant WEEE Compliant EMC, LVD E-Mark						
Operating Temperature	0°C -> +40°C (+32°F -> +104°F)						
Storage Temperature	-20°C -> +60°C (-4°F -> +140°F)						
Relative Humidity	5-90%						
Operating Altitude	<3000m						
WEIGHT AND DIMENSIONS							
Weight	1.10kg	2.00kg	2.70kg	5.20kg	1.73kg	2.70kg	5.20kg
Dimensions	218x152x66mm	237x175x89mm	324x175x89mm	414x230x110mm	312x175x87mm	324x175x89mm	414x230x110mm
Case Material	High Impact Resistance ABS	High Resistance Anodized Aluminium					



© Copyright XUNZEL™ reserves the right to make changes and improvements without prior notice. Specifications are subject to change without further notification. NOT IN SCALE

XU-92250814-MA

Industry Leading Technology for Off-Grid, Off-Shore and Backup Power Applications



info@xunzel.com
www.xunzel.com

© Copyright Xunzel. Information contained in this document is subject to change without notice.

The design and all photos and drawings of these sheets are protected by law and may not be distributed, reproduced, in whole or in part, published or used for any purpose without the express written consent of XUNZEL. © XUNZEL - Xunzel is not responsible for possible typographical errors.

XJ™ Series - Advanced Pure Sinewave Inverters

Technical Specifications

MODEL	XJTS-3000W-12V		XJTS-3000W-24V	
XUNZEL Code	XJTS30001202U		XJTS30002402U	
INVERTER				
AC Output Power Nominal / Peak <i>at any temperature</i>	3000/6000W			
AC Output Current	13.0A _{AC}			
AC Output Voltage / Frequency	230V _{AC} / 50Hz			
AC Output Waveform	Pure Sinewave (THD<3%)			
Peak Efficiency	>92%			
Nominal DC Input Voltage	12.50V _{DC}		25.00V _{DC}	
DC Input Operation Range	10.5 - 15.5V _{DC}		21.0 – 31.0V _{DC}	
Power Saving Mode	Yes			
No Load Current with Power Save Mode OFF/ON	<1.50/0.17A _{DC}		<0.60/0.10A _{DC}	
Under Voltage Shutdown	10.50V _{DC} (Programable to 11.80V _{DC} for Start Battery Car)		21.00V _{DC} (Programable to 23.60V _{DC} for Start Battery Car)	
Under Voltage Recovery	12.00V _{DC} (Programable to 12.60V _{DC} for Start Battery Car)		23.60V _{DC} (Programable to 25.20V _{DC} for Start Battery Car)	
Over Voltage Shutdown	15.50V _{DC}		31.00V _{DC}	
AC Output Ports	1x EU schuko socket + 1x Hardwire			
Power Save Mode OFF/ON Load Sense Threshold	≤3W / ≥10W			
USB port	5V _{DC} - 2100mA _{DC}			
AC Transfer Switch	Transfer Time < 30ms Transfer Relay Rating 16A			
Battery Minimum Capacity	> 960Ah - 12V		> 480Ah - 24V	
Display	LCD display + LED indicators			
SAFETY AND ENVIRONMENTAL				
Standards	CE UKCA RoHs3 and REACH Compliant WEEE Compliant EMC, LVD E-Mark			
Operating Temperature	0°C -> +40°C (+32°F -> +104°F)			
Storage Temperature	-20°C -> +60°C (-4°F -> +140°F)			
Relative Humidity	5-90%			
Operating Altitude	<3000m			
WEIGHT AND DIMENSIONS				
Weight	7,00kg			
Dimensions	540x230x115mm			
Case Material	High Resistance Anodized Aluminium			



Industry Leading Technology for Off-Grid, Off-Shore and Backup Power Applications



info@xunzel.com
www.xunzel.com

XJTM Series - Advanced Pure Sinewave Inverters

Technical Drawings

XJ-400W-12V-HANDY

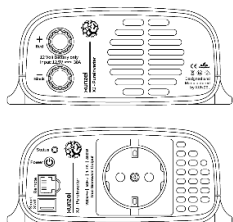

Plan View

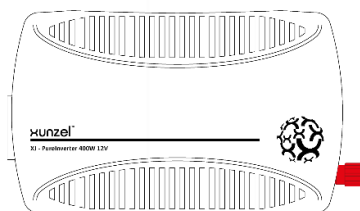

Top View



Side View

XJ-500W-24V

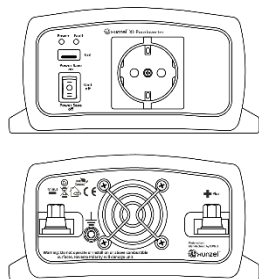

Plan View

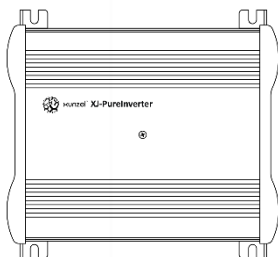

Top View

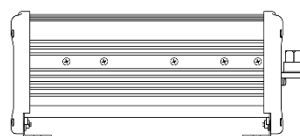

Side View

XJ-600W-12V

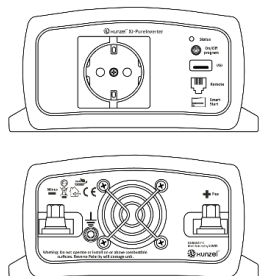

Plan View

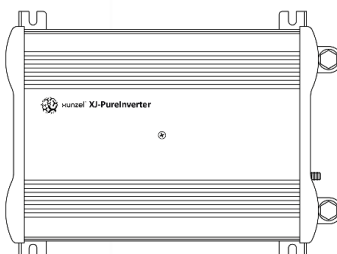

Top View

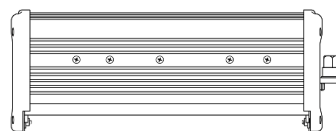

Side View

The design and all photos and drawings of these sheets are protected by law and may not be distributed, reproduced, in whole or in part, published or used for any purpose without the express written consent of XUNZEL.
© XUNZEL - Xunzel is not responsible for possible typographical errors.

© Copyright XUNZEL™ reserves the right to make changes and improvements without prior notice. Specifications are subject to change without further notification. NOT IN SCALE

XU-92250814-MA

Industry Leading Technology for Off-Grid, Off-Shore and Backup Power Applications



info@xunzel.com
www.xunzel.com

© Copyright Xunzel. Information contained in this document is subject to change without notice.

XJTM Series - Advanced Pure Sinewave Inverters

Technical Drawings

XJ-1000W-12V and XJ-1000W-24V

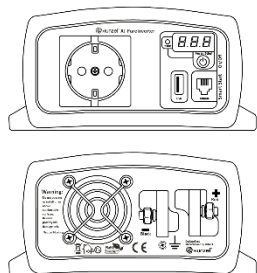

Plan View

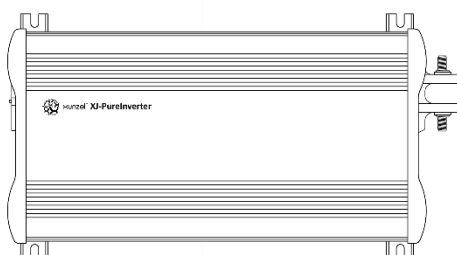

Top View

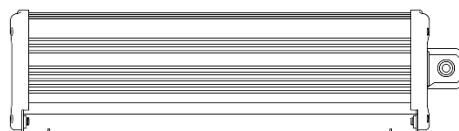

Side View

XJ-2000W-12V and XJ-2000W-24V

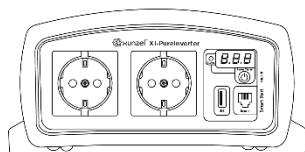

Plan View

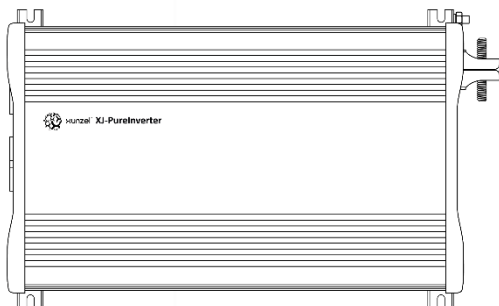

Top View



Side View

XJTS-3000W-12V and XJTS-3000W-24V

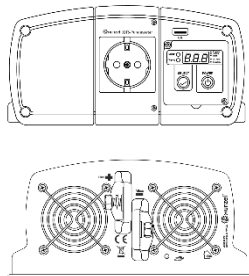

Plan View

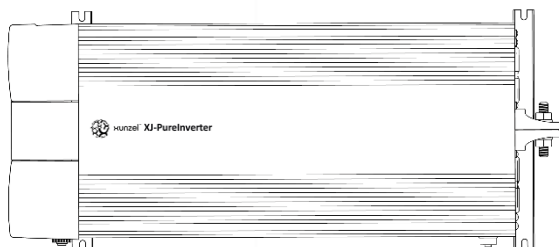

Top View



Side View

The design and all photos and drawings of these sheets are protected by law and may not be distributed, reproduced, in whole or in part, published or used for any purpose without the express written consent of XUNZEL. © XUNZEL - Xunzel is not responsible for possible typographical errors.

© Copyright XUNZEL™ reserves the right to make changes and improvements without prior notice. Specifications are subject to change without further notification. NOT IN SCALE

XU-92250814-MA

Industry Leading Technology for Off-Grid, Off-Shore and Backup Power Applications



© Copyright Xunzel. Information contained in this document is subject to change without notice.

XJ™ Series - Advanced Pure Sinewave Inverters

Models

XJ-400W-12V-HANDY



XJ-500W-24V



XJ-600W-12V



XJ-1000W-12V



XJ-1000W-24V



XJ-2000W-12V



XJ-2000W-24V



XJTS-3000W-12V



XJTS-3000W-24V



The design and all photos and drawings of these sheets are protected by law and may not be distributed, reproduced, in whole or in part, published or used for any purpose without the express written consent of XUNZEL. © XUNZEL - Xunzel is not responsible for possible typographical errors.

© Copyright XUNZEL™ reserves the right to make changes and improvements without prior notice. Specifications are subject to change without further notification. NOT IN SCALE

XU-92250814-MA

Industry Leading Technology for Off-Grid, Off-Shore and Backup Power Applications



© Copyright Xunzel. Information contained in this document is subject to change without notice.

XJ™ Series - Advanced Pure Sinewave Inverters

Other recommended accessories that can be very useful

Remote Control

p/n: RCXJ

Remote ON/OFF Controller RCXJ with 6.1-meter cable compatible with **XJ™ Series**, **XJTS™ Series** inverters and **XJC™ Series** inverters + chargers. Allows inverters to be switched on, off and remotely programmed. Easy to install and use.

IMPORTANT NOTE: For use with XJC Series inverter-chargers and XJTS-3000W Series inverters, the ISXJCS accessory (not included) is required.

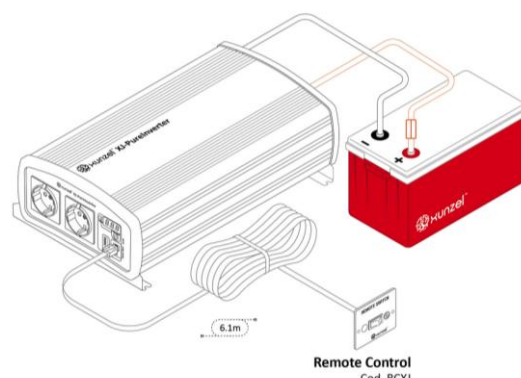

Universal Automatic Transfer Switch Relay

p/n: TSXJ10

The Automatic Transfer Switch Relay TSXJ-10 (10A – 2300W) switches safely and automatically the power supply between two sources, from the main utility grid or generator to a backup power source.

With voltage synchronization, it ensures that power is only supplied from one source at a time to avoid damaging electrical equipment or creating hazardous situations.

Plug&Play and Universal, designed and valid for all kind of pure sinewave inverters up to 2000W, including **XJ™ Series** pure sine wave inverters.

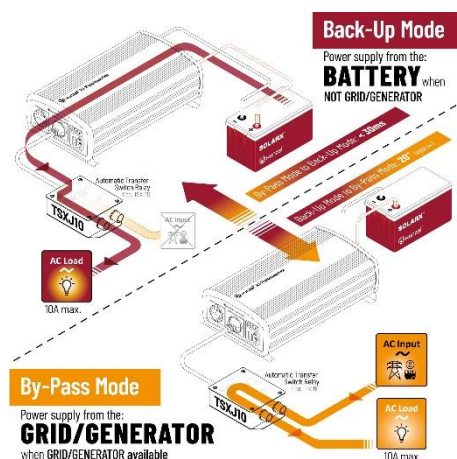

Industry Leading Technology for Off-Grid, Off-Shore and Backup Power Applications



© Copyright Xunzel. Information contained in this document is subject to change without notice.