

Product information

ASBS 2 M8-90

Industrial Connecting Solutions:Cables and Adapters:T-connectors / adaptors:M8, M12, valve plug - T-connectors/adaptors:M12-M8:T-connector, M12 male with two M8 female connectors:ASBS 2 M8-90
<https://catalog.beldensolutions.com:443/link/57078-24228-256254-57229-218892-219411-219414-219478/en/conf/ustate>

| | |
|---------------------------------------|---|
| Name | ASBS 2 M8-90 |
| |  |
| | T-connector, M12 male connector with two M8 female connectors, 3 poles, 90°-version, with self locking threaded |
| Delivery informations | |
| Availability | available |
| Product description | |
| Type | ASBS 2 M8-90 |
| Order No. | 11125 |
| Description | T-connector, M12 male connector with two M8 female connectors, 3 poles, 90°-version, with self locking threaded |
| Number of contacts | 3 |
| Color of housing | orange |
| Product characteristics | Vibration resistance, Oil resistance |
| Classification | |
| Belden brand | Lumberg-Automation |
| Environmental conditions | |
| Environmental temperature | -25 °C ... 90 °C |
| Degree of protection (IP), mounted | IP67 |
| Pollution degree | 3 |
| Materials | |
| Housing material / Molded body | TPU, self-extinguishing |
| Contact bearer material | TPU, self-extinguishing |
| Contact material | CuZn |
| Contact material - Surface refinement | pre-nickeled and 0.8 microns gold-plated |
| Knurled screw / nut material | CuZn, nickel-plated |
| Sealing material | FKM |
| Electrical data | |
| Contact resistance | ≤ 5 mΩ |
| Rated current In | 2 A per outlet / 4 A max. at 40 °C |
| Nominal voltage | 60 V |
| Rated voltage | 63 V |
| Test voltage | 1.0 kV eff./60 s |
| Insulation resistance | > 1 GΩ |

Industrial Connecting Solutions:Cables and Adapters:T-connectors / adaptors:M8, M12, valve plug - T-connectors/adaptors:M12-M8:T-connector, M12 male with two M8 female connectors:ASBS 2 M8-90
<https://catalog.beldensolutions.com:443/link/57078-24228-256254-57229-218892-219411-219414-219478/en/conf/ui/istate>

Picture

Drawing

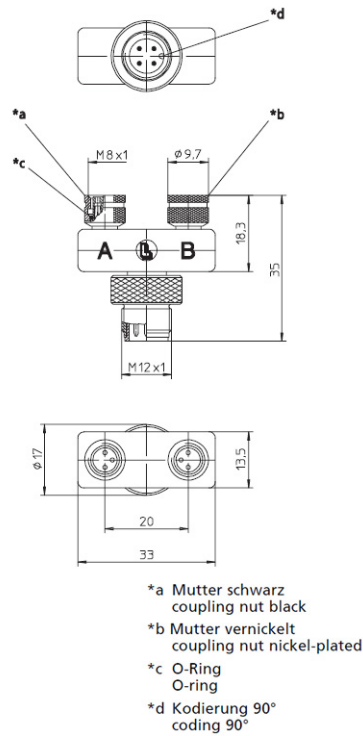

Belden Deutschland GmbH

Im Gewerbepark 2
58579 Schalksmühle
Germany
Phone: +49 7127/14-1806
E-Mail: icos-sales@belden.com

The information published in the websites has been compiled as carefully as possible. It is subject to alteration without notice in technical as well as in price-related/commercial respect. The complete information and data were available on user documentation. Mandatory information can only be obtained by a concrete query.