

19114000	<b>DATA SHEET</b>	
Valid from: 26.07.2024	<b>EPIC® H-B 24 TSB</b>	

**Description**

- Ideal for many applications due to a wide range of housings and inserts



**General Characteristics**

Series	H-B 24
Version	Hood M25 / M32 (Article 19124000)
Locking	Double lever
Gland body	Yes
Cable entry	Side
Protection (DIN EN 60529)	IP 65 (latched)
Protection (NEMA 250, UL50E)	12 (latched)
Temperature Range	-40°C to +100°C, short term up to +125°C

**Materials and Surfaces**

Housing	Aluminium alloy, powder-coated, grey
Bolt	Heat-treatable steel, zinc-plated
Lever	Steel, zinc-plated
Gland body	Brass, nickel plated

**Standard**

Safety Standard	IEC 61984
-----------------	-----------

Creator: THB01/BU-EPIC Released: IVSE1/BU-EPIC	Document: DB19114000EN Version: 02	Page 1 of 2
---	---------------------------------------	-------------

19114000	<b>DATA SHEET</b>	
Valid from: 26.07.2024	EPIC® H-B 24 TSB	

## Technical Drawings

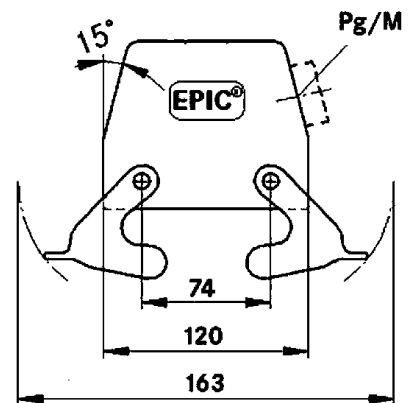
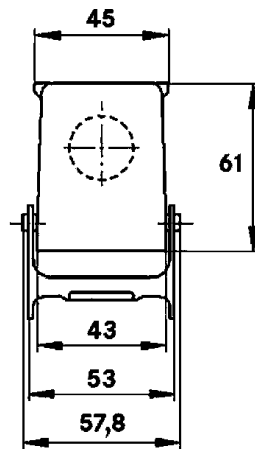

Automation

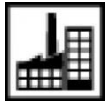

Industrial machinery and plant engineering



Mechanical resistance



Robust



Waterproof

### Info

Universal, robust metal housings size H-B 24

### Application range

Plant engineering  
Light & sound technology  
Plastics industry

### Remark

Photographs are not to scale and do not represent detailed images of the respective products.

Creator: THB01/BU-EPIC Released: IVSE1/BU-EPIC	Document: DB19114000EN Version: 02	Page 2 of 2
---	---------------------------------------	-------------