

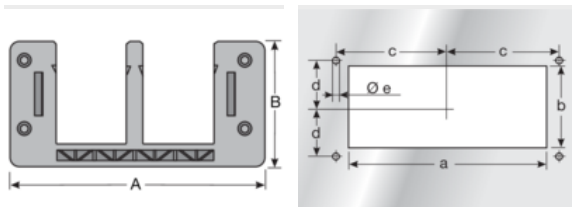

Cable entry system type KDL/E



Product information

- The cable entry systems for the insertion of pre-assembled cables with open top frame.
- Single-piece frame
- Easy and very quick assembly
- Snap in, screwing on is not necessary
- Protection class: IP 54 (with suitable grommets and cables)
- Thermal stability: -60 °C – +80 °C
- Fire classification: V0
- Material: Polyamide 6.6
- RoHS compliant
- UV resistant
- Made in Germany
- Catch hook for 1.5mm – 2.0mm plate thickness included with delivery, additional catch hooks for up to 4.0 mm plate thickness available
- Suitable for standard cut-outs for 24-pin and 16-pin industrial connectors
- Easy to realize EMC solution with discharge plate
- Suitable grommets: KDT/ZE

Information, conformities and approvals



Article	Order No.	Color	No. of openings small/large	for Ø mm	Cut-out	PU pcs.
For standard cut-out size 16						
KDL/E 16/2 1)	87121010	Black	0 / 2	16 - 31		1
KDL/E 16/4 1)	87121011	Black	4 / 0	3 - 16		1
KDL/E 16/5 1)	87121012	Black	4 / 1	3 - 31		1
KDL/E 16/8 1)	87121014	Black	8 / 0	3 - 16		1
For standard cut-out size 24						
KDL/E 24/4 2)	87121016	Black	2 / 2	3 - 31	24-pole	1
KDL/E 24/7 2)	87121018	Black	6 / 1	3 - 31	24-pole	1
KDL/E 24/10 2)	87121020	Black	10 / 0	3 - 16	24-pole	1

1) If catch hooks are used, then the width of the cut-out must be enlarged by 91 mm

2) For matching adapter plates or floor plates, see chapter "Accessories for cable entry systems and plates"



Cable entry system type KDL/E

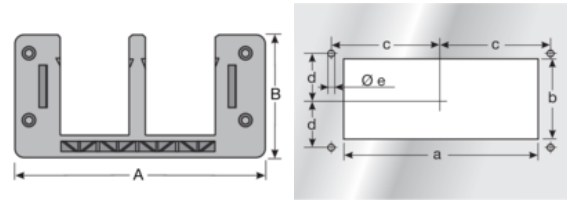

Article	Order No.	Installation height mm	A mm	B mm	a mm	b mm	c mm	d mm	e mm
KDL/E 16/2 1)	87121010	15.5	116	58	86	36	51.5	16	5.5
KDL/E 16/4 1)	87121011	15.5	116	58	86	36	51.5	16	5.5
KDL/E 16/5 1)	87121012	15.5	116	58	86	36	51.5	16	5.5
KDL/E 16/8 1)	87121014	15.5	116	58	86	36	51.5	16	5.5
For standard cut-out size 24									
KDL/E 24/4 2)	87121016	15.5	146	58	112	36	65	16	5.5
KDL/E 24/7 2)	87121018	15.5	146	58	112	36	65	16	5.5
KDL/E 24/10 2)	87121020	15.5	146	58	112	36	65	16	5.5

1) If catch hooks are used, then the width of the cut-out must be enlarged by 91 mm

2) For matching adapter plates or floor plates, see chapter "Accessories for cable entry systems and plates"

Material properties



Polyamide 6.6

Thermal properties



Temperature / temperature range -60 °C – 80 °C

Protection class



Protection class IP54 (with suitable grommets and cables)

Fire properties



Fire classification V0



Cable entry system type KDL/E

Technical information



LABS free



According to ISO 4892-2

Strain relief



Conformity



RoHS (EC Directive 2011/65/EU)

Approvals and operating permits



CSA approval



cULus approval



GL approval

Classification



ETIM 9: EC002624
ECLASS 14: 27182815
UNSPSC 26.0801: 39121312

General information



Made in Germany