

KMS Magnetic Switch

Feature

- KMS series Magnetic switching device
- Use flame retardant materials
- Bracket & Terminal cover (Sold separately)

Rated voltage	Rated current
24VDC	3A Resistive

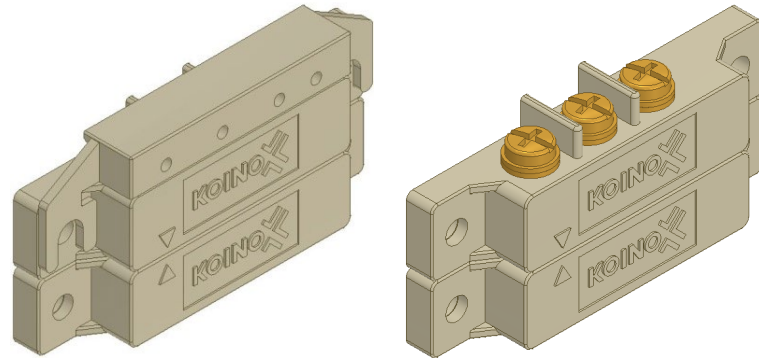

Selection guide

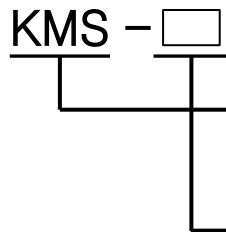

Classification	KMS	Koino Magnetic Switch
Code	C	Switch
	M	Magnet
	B	Bracket (Sold separately)
	TC	Terminal cover (Sold separately)

Specification

	KMS-C
Rated current	3A
Rated voltage	24VDC
Contact resistance	Maximum 50mΩ (initial value)
Operating Interval	Distance between Switch and Magnet: 10mm or less
Insulation Resistance	Minimum 100MΩ (DC500V Insulation Resistance Meter)
Withstand Voltage	Live part: 1,000VAC 50/60Hz, for 1 min. Dead part: 1,500VAC 50/60Hz, for 1 min.
Ambient temperature	-25°C~50°C(at non-frozen condition)
Durability	Electrical: 200K operations (1,800/h), Mechanical: 1M operations (1,800/h)

Internal circuit

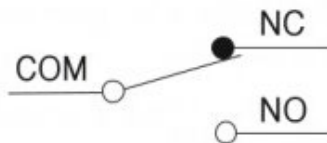

- COM ... COMMON(공통단자)
- NC(b) ... NORMAL CLOSED(상시폐로)
- NO(a) ... NORMAL OPEN(상시개로)

Operations

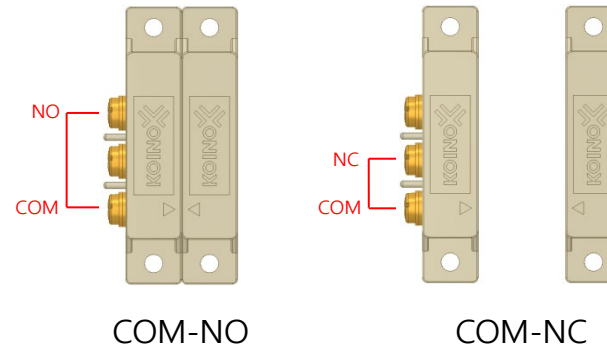

Terminals and Wires

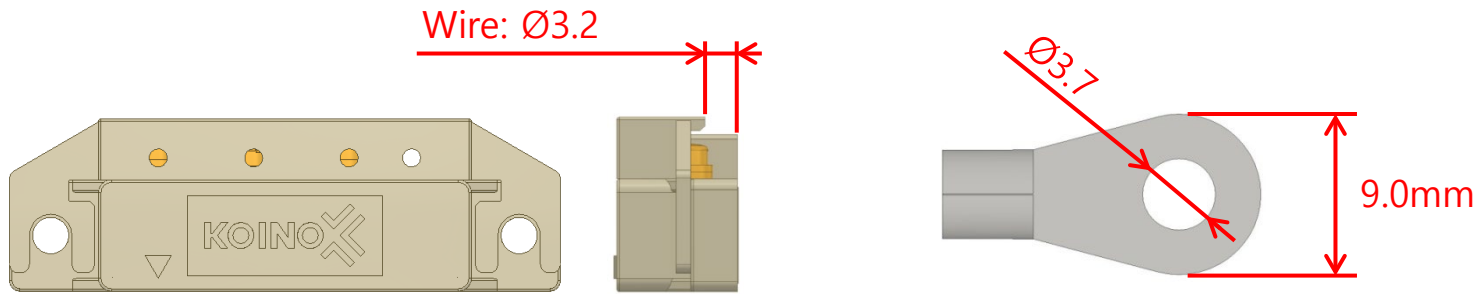

Recommended wire diameter
when using terminal covers:
Maximum $\varnothing 3.2$

Terminal width when using the
terminal lug: Maximum 9.0mm

Wiring

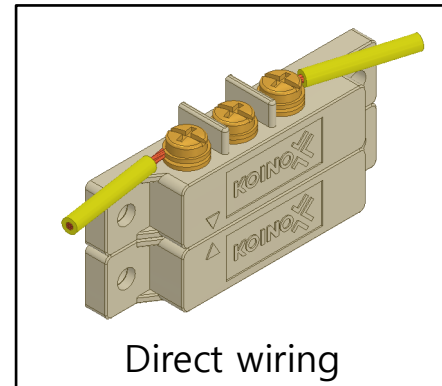
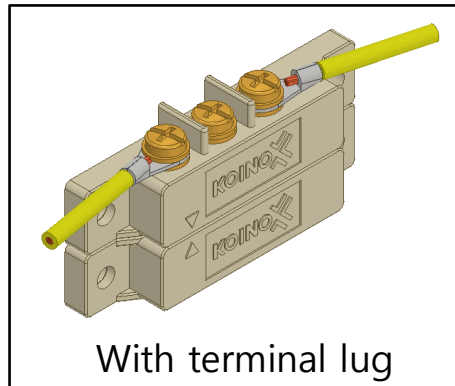

All terminals (screws) should be tightened sufficiently to prevent wobbling.

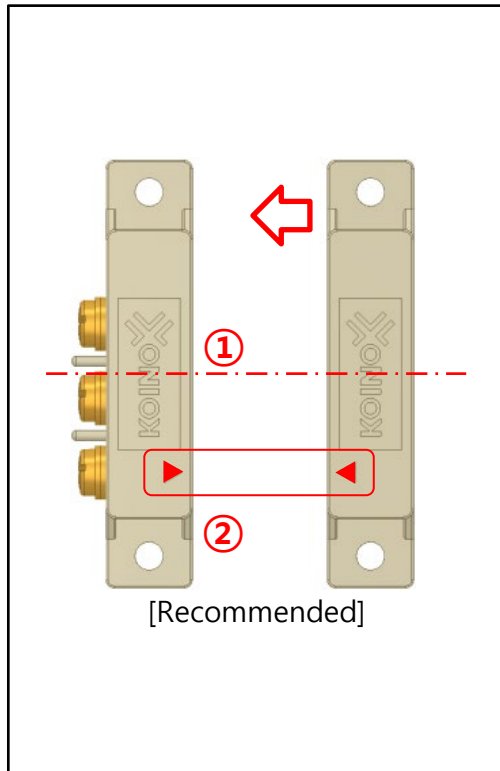

Switch/Magnet Placement Criteria

1. The switch and magnet must be aligned
2. The position of the arrow must be correct.

[Application examples]

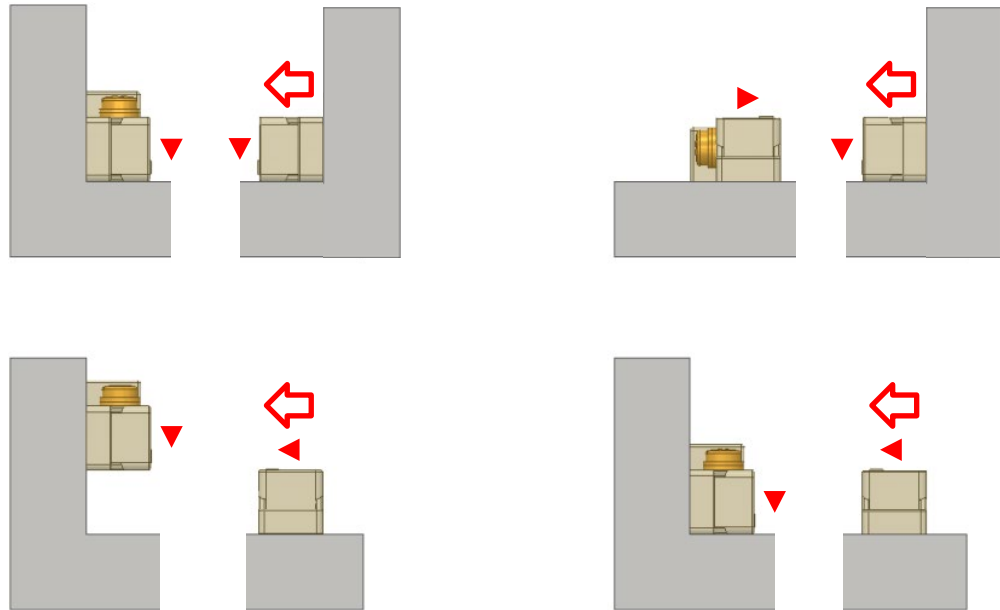

Mounting

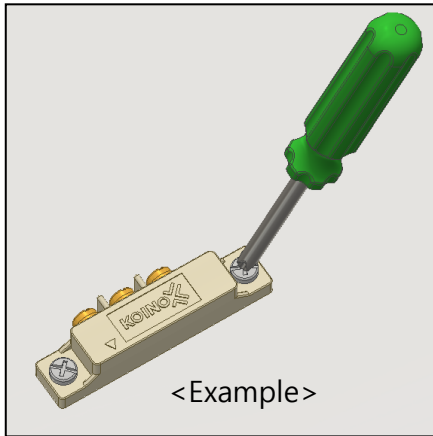

1. Prepare screws that match the product mounting dimensions ($\varnothing 4$).
2. Secure the switch by pre-drilling holes in the location where you want to secure it and tightening the screws with a hand screwdriver (Recommended)

Caution

Fastening with an electric drill may cause damage to the product due to strong torque. (9kgf - cm or less recommended)

Bracket

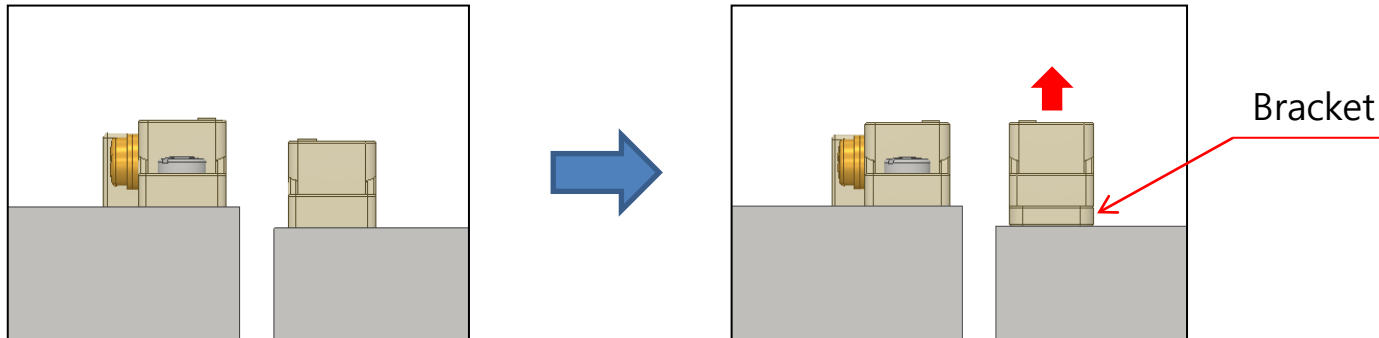

Adjust the heights between Switch & Magnet

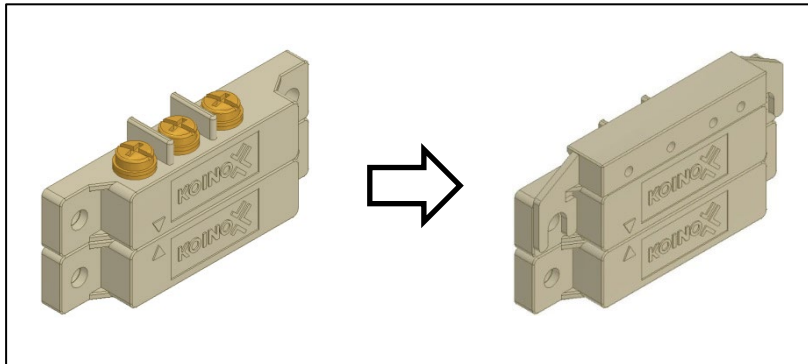

1. Protecting terminals

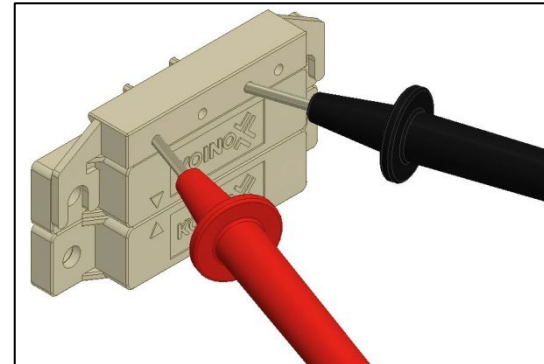

2. Checking the energized status

3. Terminal cover can be removed while switch is engaged

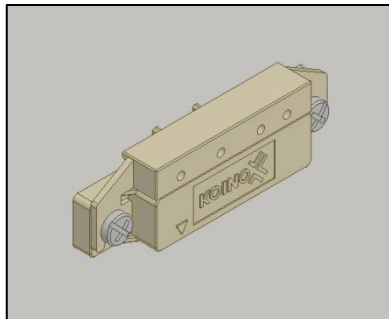

Loosen the mounting screws slightly

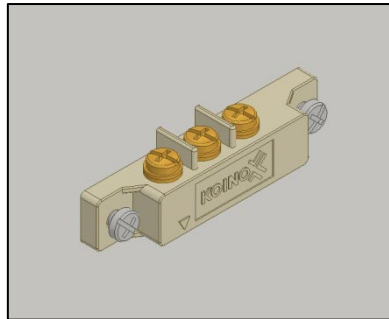

Remove the terminal cover.

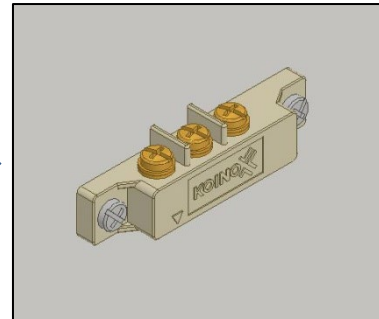

Tighten the mounting screws.

Dimension

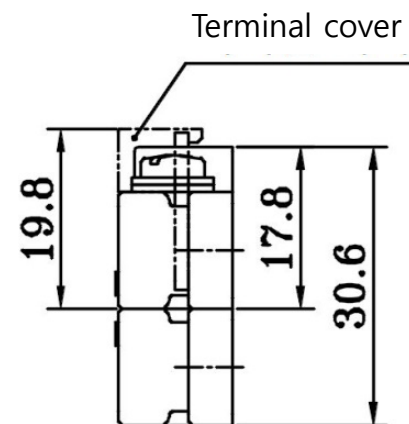
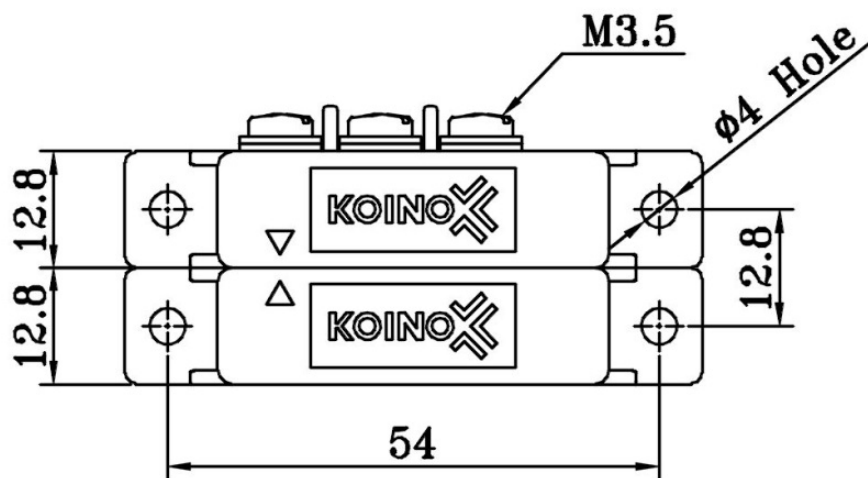
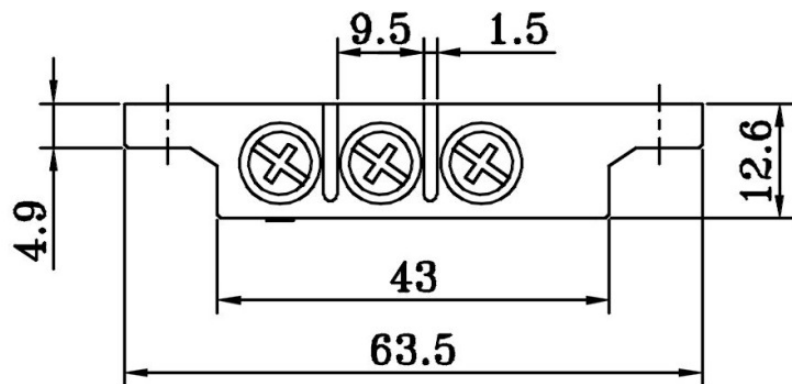

Switch – Terminal cover

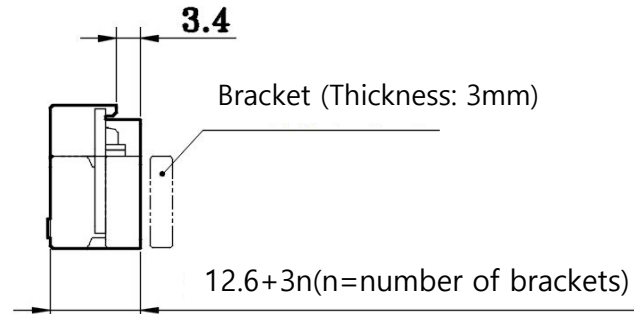
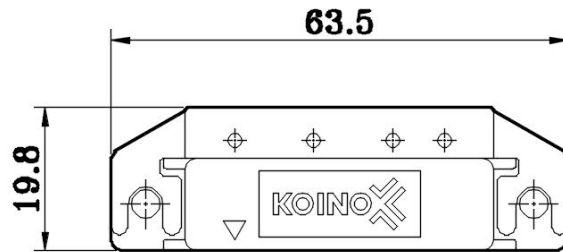

Terminal cover

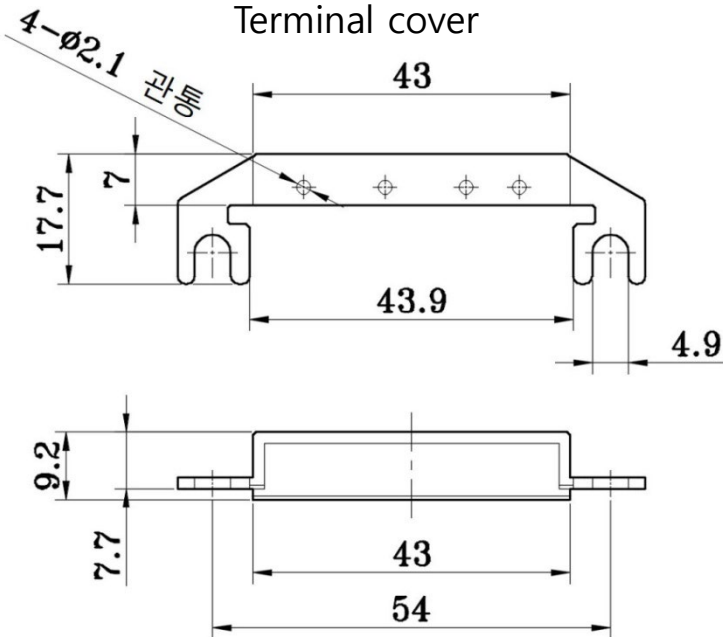

Bracket

