

PC card drilling dimensions(after plating)
(thickness 2.40±0.20mm)

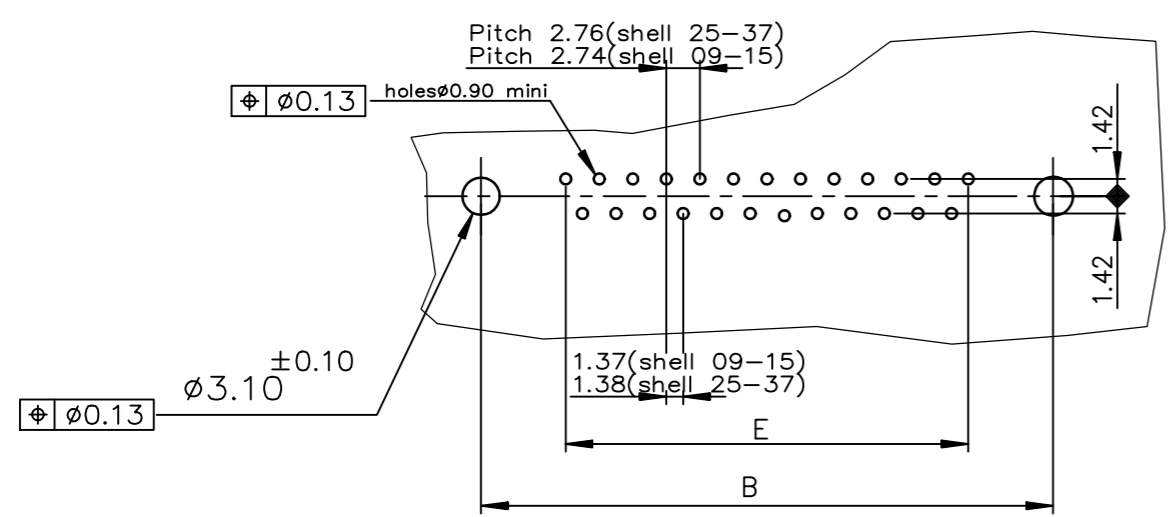

LEAD FREE PART NUMBER

SHELL	A±0.38	B±0.12	C±0.10	D±0.25	E±0.07	PART NUMBER
09	30.81	24.99	16.96	16.21	10.96	D09S24B.GV00LF
15	39.14	33.32	25.18	24.54	19.18	D15S24B.GV00LF
25	53.03	47.04	39.12	38.25	33.12	D25S24B.GV00LF
37	69.32	63.50	55.68	54.71	49.68	D37S24B.GV00LF

Performance: 4 - 200 Mating/un-mating
6 - 500 Mating/un-mating

GENERAL CHARACTERISTICS AND ROHS INFORMATIONS:
SEE DRAWING C01-8646-0000

mat'l. code		surface		tolerance		projection		product family	
		ISO 1302 ✓		ISO 406 ISO 1101		mm		D-SUB	
ltr		ecn no		dr		date		title	
G		ELX-I-42817		ACJ		2021/10/18		FEMALE CONNECTOR STD EURO	
								005/06/24	
								dwg no	
								sheet 1 of 1	
								size	
								A3	
								type	
								Product Customer Drawing	
sheet index		revision		G					
		sheet		1					