

Amphenol FCI
 2016 AFCl
 © 2016 AFCl

$0^{+0.40}$
 -0.10
 RELATIVE TO SURFACE T

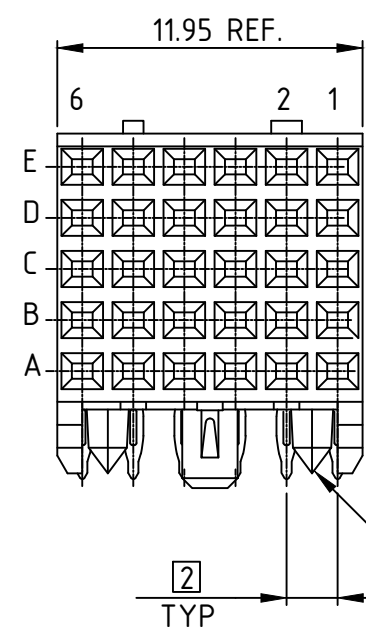
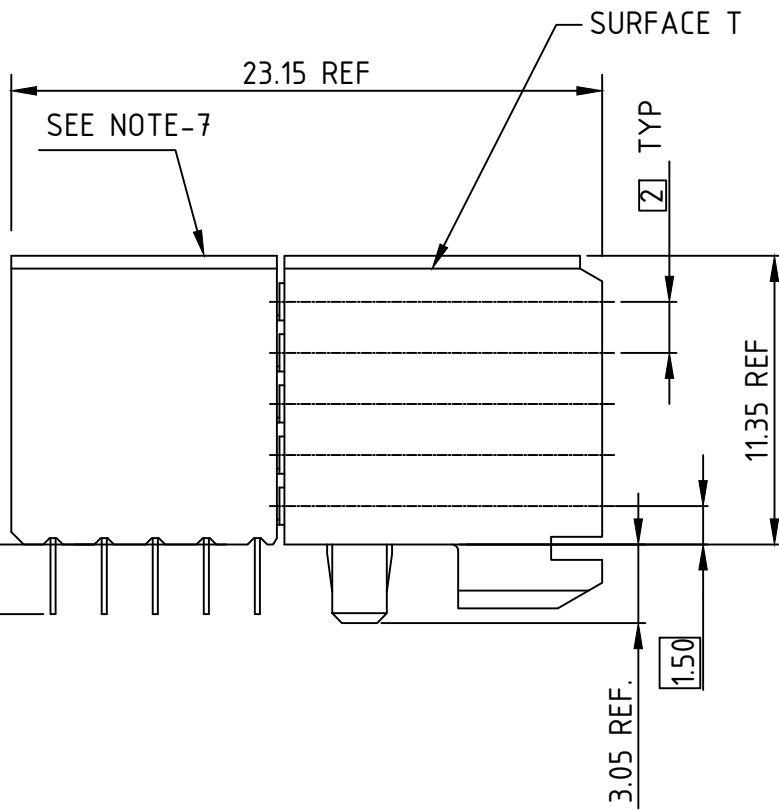

85718-XY YLF $\triangle AC$
 LEAD FREE PART NUMBER
 LOADING PATTERN
 REFER DRAWING # 10159408

PRESS-FIT TAILS SHOWN

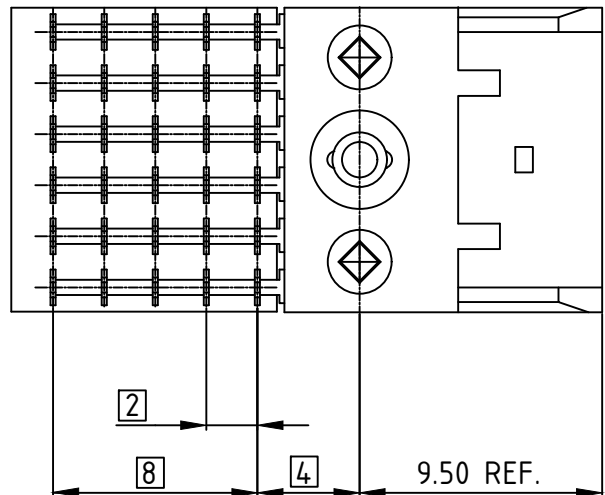
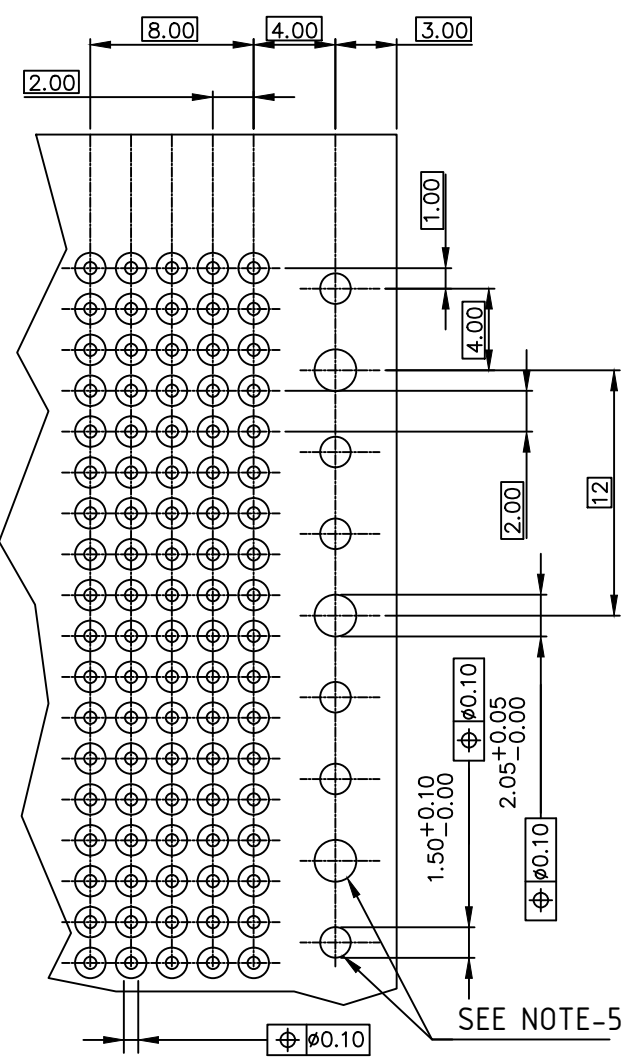

NOTES:

- MATERIAL : BODY : LCP UL94-V0
: CONTACT : COPPER ALLOY.
- FOR PLATING PERFORMANCE REFER DRAWING # 10159408 $\triangle AC$
- PRODUCT SPECIFICATION: GS-12-002
- APPLICATION SPECIFICATIONS: BUS-20-061, GS-20-001, TA-941
- INDICATED HOLES ARE UNPLATED.
- DIAMOND LOCATION PEG ARE ONLY EXISTED ON THE BOTH SIDES OF PRODUCT.
- TOP SURFACE OF PRESS BLOCK MAY EXTEND UP TO 0.4MM HIGHER THAN HOUSING. THIS MAY AFFECT THE TAIL LENGTH BEFORE APPLICATION TO A BOARD.
- VIA-HOLES MAY BE OMITTED ON CONTACT POSITIONS "NOT LOADED".
- THIS PRODUCT MEETS EUROPEAN UNION DIRECTIVES AND OTHER COUNTRY REGULATIONS AS DESCRIBED IN GS-47- 0004
- ALL PRODUCTS WILL WITHSTAND EXPOSURE TO 240° FOR 60 SECONDS IN A CONVECTION, INFRA-RED OR VAPOR PHASE REFLOW OVEN.
- A $\triangle AC$ SYMBOL WILL BE NEXT TO ANY DIMENSION, VIEW, OR NOTE WHICH HAS BEEN MODIFIED WITH THE CURRENT DRAWING REVISION.

RECOMMENDED PC BOARD LAYOUT,
 COMPONENT SIDE.
 SEE NOTE 8
 SEE DRAWING 58351 FOR PTH DETAILS

| | | | | | | | | | |
|-------------|--|-------------|--|------------------|--|-------------|--|---|--|
| mat'l. code | | surface | | tolerance | | projection | | product family | |
| | | ISO 1302 | | ISO 406 ISO 1101 | | \triangle | | METRAL | |
| ltr | | ecn no | | dr | | date | | title | |
| AA | | DG08-0171 | | TER | | 2008-03-09 | | B SERIES R/A RECEPT ASSY, 5 ROW, 1 MOD, SL, PF | |
| AB | | DG09-0068 | | CENH | | 2009-06-06 | | | |
| AC | | ELX-I-38655 | | MINI | | 2020-10-16 | | | |
| | | | | dr | | C. DAILY | | 2002-04-18 | |
| | | | | enr | | ARUN | | 2020-10-16 | |
| | | | | chr | | ALEX BABU | | 2020-10-16 | |
| | | | | appd | | SANJO | | 2020-10-16 | |
| sheet | | revision | | AC | | AC | | | |
| index | | sheet | | 1 | | 2 | | | |



Amphenol
FCI

© 2016 AFCl

1

2 3

4

5

6

| PART NUMBER: | CONFIGURATION | | | | | | | DIM "A" |
|--------------|---------------|---|---|---|---|---|---|---------|
| | ROW # | 6 | 5 | 4 | 3 | 2 | 1 | |
| 85718-X01LF | E | - | X | - | X | - | X | 2.90 |
| | D | - | - | - | - | - | - | |
| | C | - | X | - | X | - | X | |
| | B | - | - | - | - | - | - | |
| | A | - | X | - | X | - | X | |
| 85718-X02LF | E | - | X | X | X | X | X | 2.90 |
| | D | - | X | X | X | X | X | |
| | C | - | X | X | X | X | X | |
| | B | - | X | X | X | X | X | |
| | A | - | X | X | X | X | X | |
| 85718-X03LF | E | - | X | - | X | - | X | 2.90 |
| | D | - | X | - | X | - | X | |
| | C | - | - | - | - | - | - | |
| | B | - | X | - | X | - | X | |
| | A | - | X | - | X | - | X | |
| 85718-X04LF | E | - | X | - | X | - | X | 2.90 |
| | D | X | - | X | - | X | - | |
| | C | - | X | - | X | - | X | |
| | B | X | - | X | - | X | - | |
| | A | - | X | - | X | - | X | |
| 85718-X05LF | E | - | - | - | - | - | - | 2.90 |
| | D | X | X | X | X | X | X | |
| | C | X | X | X | X | X | X | |
| | B | X | X | X | X | X | X | |
| | A | X | X | X | X | X | X | |
| 85718-X06LF | E | X | - | X | - | X | - | 2.90 |
| | D | - | X | - | X | - | X | |
| | C | X | - | X | - | X | - | |
| | B | - | X | - | X | - | X | |
| | A | X | - | X | - | X | - | |
| 85718-X07LF | E | X | X | X | X | X | X | 2.90 |
| | D | X | X | X | X | X | X | |
| | C | X | X | X | X | X | X | |
| | B | X | X | - | - | - | X | |
| | A | X | X | - | X | - | X | |
| 85718-X08LF | E | X | X | X | - | X | X | 2.90 |
| | D | X | X | X | - | X | X | |
| | C | X | X | X | - | X | X | |
| | B | X | X | - | - | - | X | |
| | A | X | X | - | X | - | X | |
| 85718-X09LF | E | - | X | - | X | - | X | 3.53 |
| | D | - | - | - | - | - | - | |
| | C | - | X | - | X | - | X | |
| | B | - | - | - | - | - | - | |
| | A | - | X | - | X | - | X | |
| 85718-X10LF | E | X | X | X | X | X | X | 3.53 |
| | D | X | X | X | X | X | X | |
| | C | X | X | X | X | X | X | |
| | B | X | X | X | X | X | X | |
| | A | - | X | X | X | X | X | |

| PART NUMBER: | CONFIGURATION | | | | | | | DIM "A" |
|--------------|---------------|---|---|---|---|---|---|---------|
| | ROW # | 6 | 5 | 4 | 3 | 2 | 1 | |
| 85718-X11LF | E | X | X | X | X | X | - | 2.90 |
| | D | X | X | X | X | X | - | |
| | C | X | X | X | X | X | - | |
| | B | X | X | X | X | X | - | |
| | A | X | X | X | X | X | - | |
| 85718-X12LF | E | - | - | X | - | - | - | 2.90 |
| | D | X | - | X | X | - | X | |
| | C | X | - | X | X | - | X | |
| | B | X | - | X | X | - | - | |
| | A | - | - | X | - | X | X | |

| LOAD PATTERN | |
|--------------|------------|
| X | LOADED |
| - | NOT LOADED |

| | | | | | | | | | |
|-------------|-------------|--|------------|---|--------|---|---------|---|--|
| mat'l. code | | surface <input checked="" type="checkbox"/> ISO 1302 | | tolerance <input checked="" type="checkbox"/> ISO 406 | | projection <input checked="" type="checkbox"/> ISO 1101 | | product family METRAL | |
| ltr | ecn no | dr | date | tolerances unless otherwise specified | | title | | B SERIES R/A RECEPT ASSY, 5 ROW, 1 MOD, SL, PF | |
| AA | DG08-0171 | TER | 2008-03-09 | angles | linear | .X±0.3 | mm | dwg no 85718 sheet 2 of 2 size A3 | |
| AB | DG09-0068 | CENH | 2009-06-06 | 0°±2° | | .XX±0.13 | ← | type Product Customer Drawing | |
| AC | ELX-I-38655 | MINI | 2020-10-16 | | | .XXX±0.050 | scale - | | |
| sheet index | | revision sheet | | AC | AC | Amphenol FCI | | | |
| | | | | 1 | 2 | | | | |

1

2

3

4

5

6