

E11115



Mounting sleeve with end stop

FIXING/M18/MODUL/MS/END STOP

phase-out article
Discontinuation date: 09/30/2024

Alternative articles: E12745
When selecting an alternative article and accessories please note that technical data may differ!

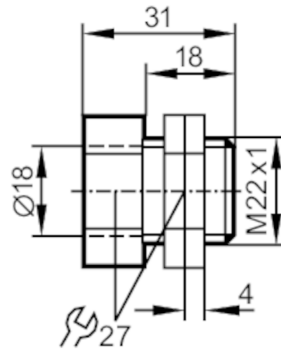

Application

Design with end stop

Mechanical data

Weight [g]	66.5
Installation instruction	align the sensing face of the sensor to the right (see scale drawing)
Dimensions [mm]	M22 x 1
Thread designation	M22 x 1
Inside diameter [mm]	18
Materials	brass white bronze coated; Nuts: brass white bronze coated
Tightening torque [Nm]	7; (lock nuts: 20)

Accessories

Items supplied Nuts: 2

Remarks

Pack quantity 1 pcs.