

# PIN RECEPTACLES

FOR .032" - .046" DIAMETER PINS

## 8206

8206-0-15-XX-34-XX-40-0

Surface mount, board edge  
Also available on 16mm wide carrier tape:  
Packaged Vertically 1,400 parts per 13" reel  
See page 194.14 for Tape & Reel details

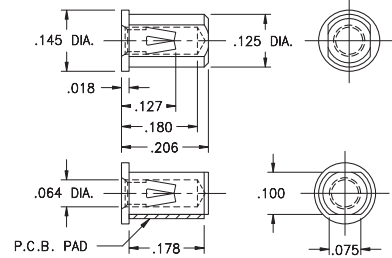

P.C.B. Layout

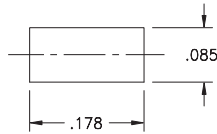

## 8369

8369-0-15-XX-34-XX-04-0

Press-fit in .084 mounting hole

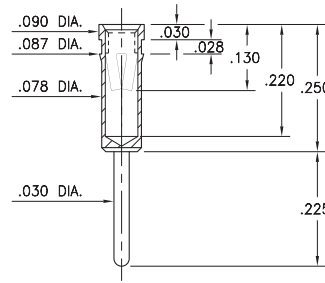

## 2166

2166-0-15-XX-34-XX-04-0

Press-fit in .080 mounting hole

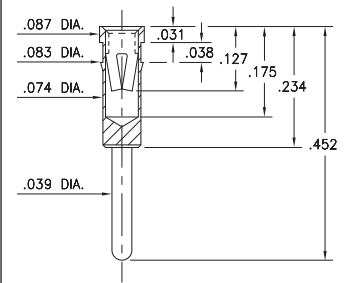

## 6800

6800-0-15-XX-34-XX-04-0

Solder mount in .080 min. mounting hole

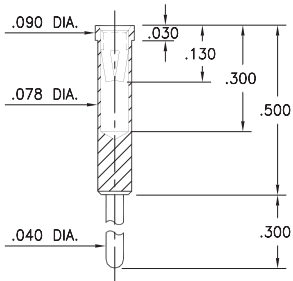

### SPECIFICATIONS:

**Shell Material:** Brass Alloy 360, 1/2 Hard

**Contact Material:** Beryllium Copper Alloy 172, HT

**Dimensions:** Inches

**Tolerances On:** Lengths: ±.005

Diameters: ±.002

Angles: ± 2°



ORDER CODE: XXXX - 0 - 15 - XX - 34 - XX - 10 - 0

BASIC PART #

SPECIFY SHELL FINISH:

- 01 200 μ" TIN/LEAD OVER NICKEL
- ◆ 80 200 μ" TIN OVER NICKEL (RoHS)
- ◆ 15 10 μ" GOLD OVER NICKEL (RoHS)

SPECIFY CONTACT FINISH:

- 01 200 μ" TIN/LEAD OVER NICKEL
- ◆ 80 200 μ" TIN OVER NICKEL (RoHS)
- ◆ 27 30 μ" GOLD OVER NICKEL (RoHS)

SELECT CONTACT:

#34 CONTACT (DATA ON PAGE 258)

(For alternate contact choices, see group E on page 248)

