

| 未注公差/General tolerances (mm) | | | | | | | | | | | | 0.1/10 | |
|------------------------------|-------|-------|-------|-------|-------|-------|-------|-------|-------|-------|-------|--------|-------|
| 0 | >3 | >6 | >10 | >18 | >30 | >50 | >80 | >120 | >180 | >250 | >315 | | >400 |
| ~3 | ~6 | ~10 | ~18 | ~30 | ~50 | ~80 | ~120 | ~180 | ~250 | ~315 | ~400 | ~500 | |
| ±0.12 | ±0.18 | ±0.22 | ±0.26 | ±0.31 | ±0.37 | ±0.57 | ±0.80 | ±0.93 | ±1.05 | ±1.15 | ±1.60 | ±2.20 | ±2.50 |

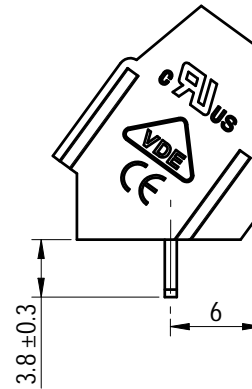
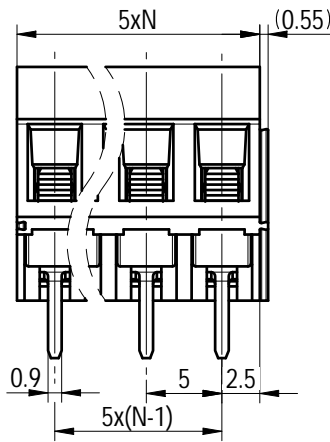
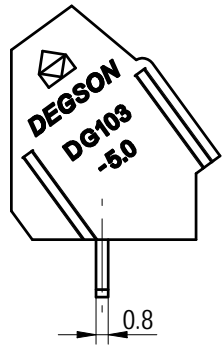
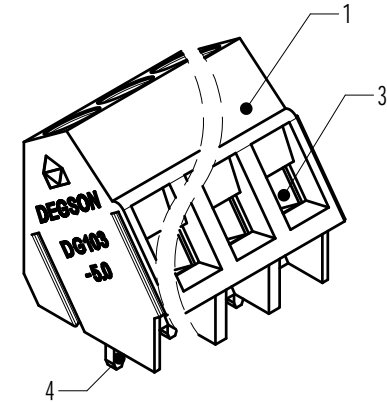
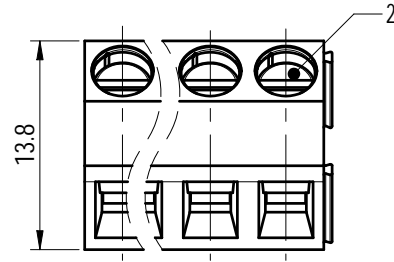
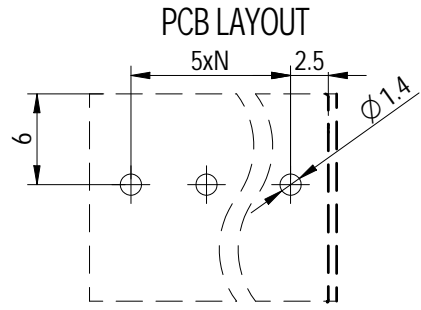

Note:
The A&Z (H) in the name means: A(H) and Z(H)

| ITEM | NAME OF PART | MATERIAL | NOTES |
|------|--------------|--------------|--------------|
| 4 | Pin header | Copper alloy | Sn_Plated |
| 3 | Cage | Copper alloy | M3/Ni_Plated |
| 2 | Screw | Steel | M3/Zn_Plated |
| 1 | Housing | PA66 | UL94V-0 |

| UL 标准/UL Standard: | B | C | D |
|---|-----------------|--------|--------|
| 额定电压/电流/Rated Voltage(V)/Current(A) | 300/20 | / | 300/10 |
| IEC 标准/IEC Standard: | | | |
| 过压类别/Overtoltage Category/污染等级/Pollution Degree | III/3 | III/2 | II/2 |
| 额定电压/电流/Rated Voltage(V)/Current(A) | / | 250/24 | / |
| 工频耐压/Withstanding Voltage(V/1Min) | AC2000 | | |
| 螺丝扭矩/Torque Tightening(N·m/Lb.in) | M3, 0.5/4.43 | | |
| 线径范围(硬线和软线)/Wire Range(rigid and flexible)(AWG) | 24~12 / 1.0~2.5 | | |
| 间距/Pitch(mm)/线数范围/Poles | 5.0/N=02~24P | | |
| 剥线长度/Stripping length(mm) | 7 | | |
| 使用温度范围/Operating temperature(°C) | -40~+105 | | |
| 符合RoHS环保要求/Conform to RoHS | Yes | | |

| | | | | | |
|------------------------|--|---------------------------|----------------|-------|-------|
| | | MATERIAL: | SURFACE/COLOR: | | |
| APPD: David 2023.03.23 | | MAT NO./REV: | MAT STATUS: 批量 | | |
| CHKD: David 2023.03.23 | | NAME | | | |
| DRFT: 曹心一 2023.03.23 | | DG103-5.0-XXP-1Y-1000L(H) | | | |
| DRAWING NO. 200156405 | | TYPE | DRAWING STATUS | SCALE | SHEET |
| A4 | | CUSTOMER DRAWING | 已发布 | 2:1 | 1/1 |

| REV | ECN | DESCRIPTION | DRFT | DATE |
|-----|-----|-------------|------|------|
| | | | | |

Transfer or duplication of this document as well as the utilization or communication of its contents are prohibited unless authorized in writing. All rights reserved for patent, utility model or design registrations. 除专利、实用新型、外观设计、发明专利、软件著作权、集成电路布图设计专有权、商业秘密和未公开信息等知识产权的所有权外，其他知识产权的所有权均归本公司所有。未经许可，不得复制或传播本文件内容。如有侵权，本公司保留追究法律责任的权利。