

THE INFORMATION CONTAINED IN THIS DRAWING IS THE SOLE PROPERTY OF AMPHENOL CABLES ON DEMAND. ANY REPRODUCTION OR DISCLOSURE TO THIRD PARTIES, IN PART OR WHOLE, WITHOUT THE EXPRESS WRITTEN PERMISSION OF AMPHENOL CABLES ON DEMAND IS PROHIBITED.

REV.	DESCRIPTION	DATE	APPROVED
A	NEW RELEASE	5/June/2017	
A1	Updated the description.	07/fev/2023	
A2	Show all the actual pin locations	08/fev/2023	
A3	Correction of the wiring error	09/fev/2023	

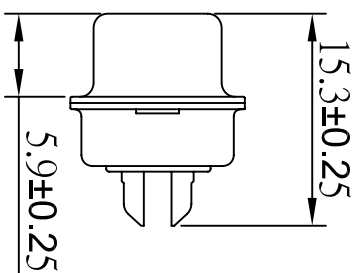
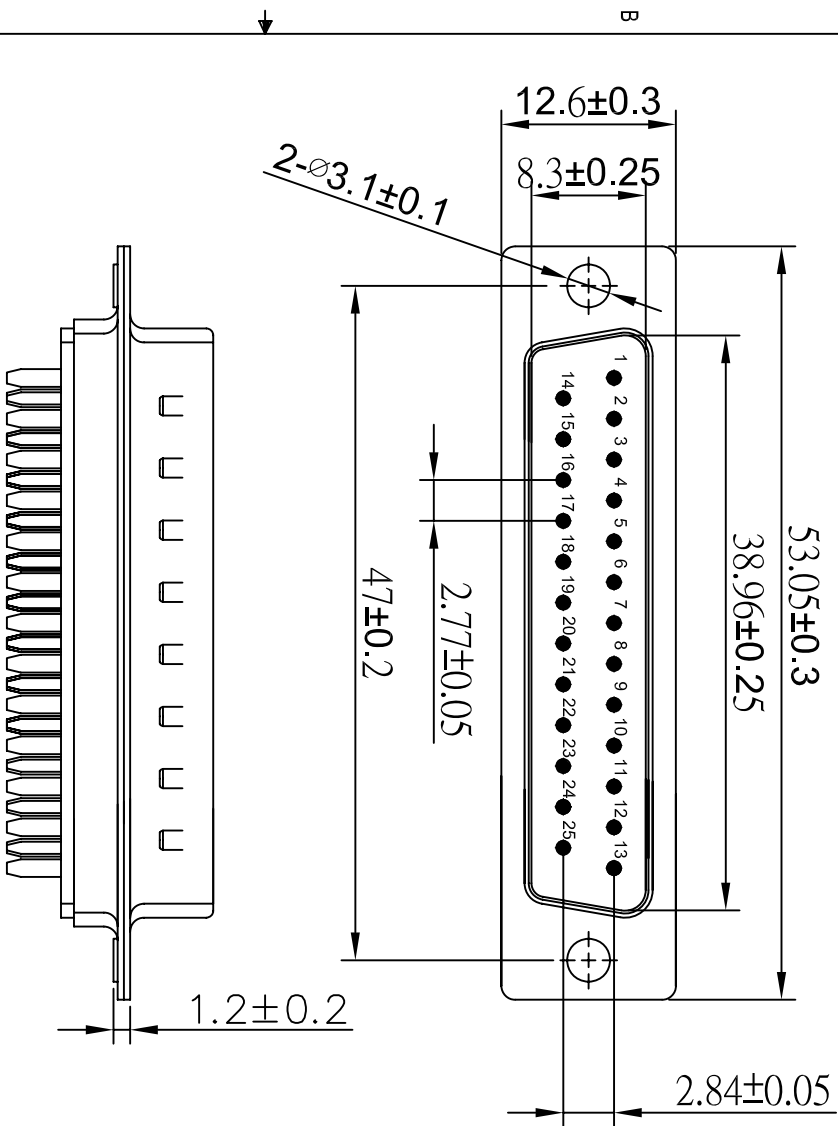

Note:

1. Material:
 - 1.1 High temperature thermoplastic PBT with 30%GF, UL94v-0
 - 1.2 Contact: Copper Alloy, thickness=0.2mm, Gold flash plated on contact area over Nickel
 - 1.3 Front Shell: Steel, thickness=0.4mm, Nickel Plated
 - Back Shell: Steel, thickness=0.4mm, Tin Plated over Nickel
2. Specification:
 - 2.1 Current rating: 1 A Max.
 - 2.2 Dielectric withstanding voltage: 500 V(ac) for 1 min.
 - 2.3 Contact resistance: 30 mΩ Max.
 - 2.4 Insulation resistance: 1000 MΩ Min.
 - 2.5 Total mating force: 7.5 Kgf Max.
 - 2.6 Total unmating force: 1.5 Kgf Min.
 - 2.7 Temperature range: -55°C-85°C
 - 2.8. Mating Cycle: 500 cycles min
3. ROHS(Directive 2011/65/EU Consolidated version of 24 June 2015) Compliant



UNLESS OTHERWISE SPECIFIED DIMENSIONS ARE IN MM TOLERANCES ARE:		EQR. NO.	
BEMAS		APPROVALS	DATE
X	±X	LF	5/June/2017
.XX	±.XX	CHECKED	BA
.XXX	±.XXX	RESP ENG	5/June/2017
THIRD ANGLE PROJECTION		WIRG ENG	
		SIZE	REV.
D-Sub Connector (Solder-Cup)		A	A3
Connector Type: DB25 Male		P/N	CN-DSUB25PIN0-000
Amphenol Cables on Demand		SCALE	SHEET
20 VALLEY ST. ENDICOTT, NY 13760			OF

NOTES: UNLESS OTHERWISE SPECIFIED