

1

2

3

4

5

6

7

A

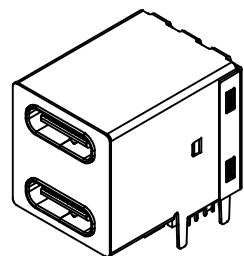
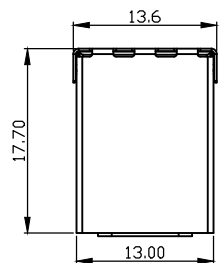

NOTES:

1. HOUSING: LCP, UL 94V-0, COLOR- BLACK
2. BOTTOM COVER: LCP, UL 94V-0, COLOR- BLACK
3. CONTACT: USB3 C2680-H T=0.25mm ; USB2 C5191-H T=0.25mm
GOLD-FLASH PLATED ON CONTACT AREA, 120μ" MIN. MATTE TIN
PLATED ON SOLDERING TAIL, 80μ" MIN. NICKEL UNDER-PLATED OVERALL
4. FRONT SHELL: SUS304-1/2H, T=0.25mm, 30μ" MIN. NICKEL PLATED OVER ALL,
100μ" MIN. MATTE TIN PLATED ON SOLDERING TAIL,
5. MIDDLE SHELL: SUS304-1/2H, T=0.25mm,
6. REAR SHELL: SUS304-1/2H, T=0.20mm,
7. THIS PRODUCT DOESN'T CONTAIN ENVIRONMENTAL HAZARDOUS
PER DIRECTIVE 2011/65/EU FOR RoHS COMPLIANT. OR PER IEC
61249-2-21 FOR HALOGEN-FREE COMPLIANT.
8. PACKAGE: TRAY
9. CURRENT: 5A

B

C

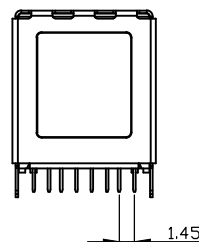
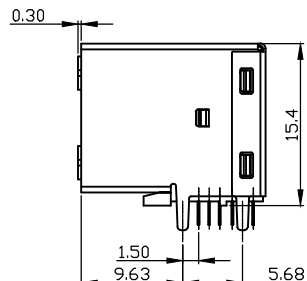
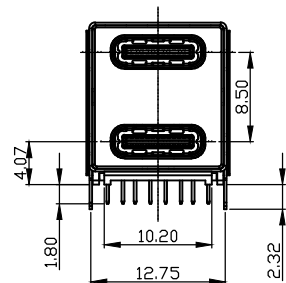

D

E

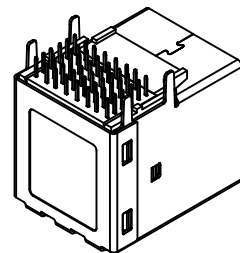
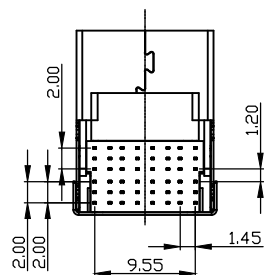

F

G

RoHS compliant
Unit: mm

Scale Free

TOLERANCE

X.X ±0.35

X.XX ±0.25

X.XXX ±0.15

DIM TOL

X° ±5°

①

Drawn

11.05.2022

Luca

Id.

Modification

Date

Name

Date

Name

Description: USB Connector

TYPE C / USB3.2 GEN1 / FEMALE / Daul port

ASSMANN WSW-No.

A-USBC-32F1-DA-GTP01

Drawing-No.

ASS 9376 CO

rev00

Customer-No.

Sheet
1/2

ASSMANN
WSW components

1

2

3

4

5

6

7

SV5151

