

DO NOT SCALE FROM THIS PRINT

Ⓟ THIS PRODUCT MANUFACTURED WITH LEAD-FREE PROCESSING

DESIGNED & DIMENSIONED IN MILLIMETERS [INCHES]

SMB5-P-C-XX-RA-CA1

GENDER
-P: PLUG

TYPE
-C: CABLE

TERMINATION
-CA1: CABLE (RG174 OR RG316)

ORIENTATION
-RA: RIGHT ANGLE

J

TABLE 1			
ITEM	COMPONENT	-HN	-H
1	OUTER FERRULE	SMA-FER-001-N	SMA-FER-001-F
2	SUB ASSEMBLY	SUB-SMB5-P-C-HN-RA-CA1	SUB-SMB5-P-C-H-RA-CA1
3	CAP	SMB5-CAP-001-N	SMB5-CAP-001-F

PLATING **J**

-HN: 30μ" GOLD CENTER CONTACT, 100μ" NICKEL OUTER CONTACT

-H: 30μ" GOLD CENTER CONTACT, 3μ" GOLD OUTER CONTACT (SEE TABLE 1)

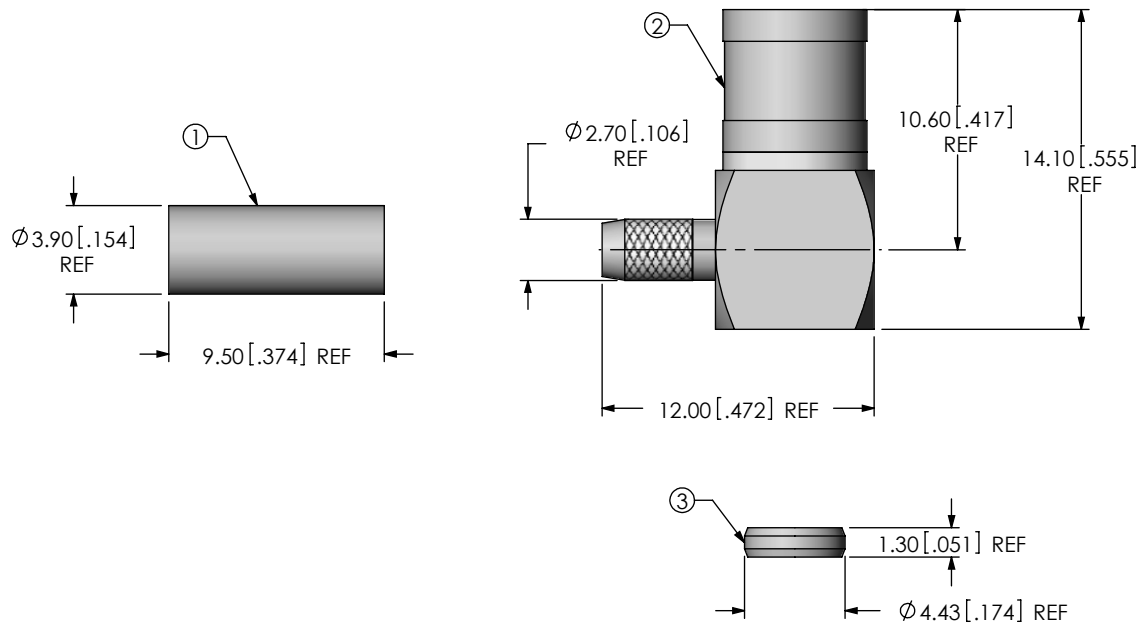

NOTES: **J**

- Ⓟ REPRESENTS A CRITICAL DIMENSION.
- CENTER CONTACT PUSHOUT FORCE = 17.79 N [4.0 LB] MIN.
- NOTE DELETED.
- NOTE DELETED.
- PRODUCT TO BE PACKAGED PER PACKAGING STANDARD CO-HD-WI-3040-M.
- NOTE DELETED.
- NOTE DELETED.
- NOTE DELETED.

UNLESS OTHERWISE SPECIFIED, DIMENSIONS ARE IN MILLIMETERS. TOLERANCES ARE:

DECIMALS ANGLES

.X: ±0.3 [.01] 5° **J**

.XX: ±0.13 [.005]

.XXX: ±0.051 [.0020]

PROPRIETARY NOTE

THIS DOCUMENT CONTAINS INFORMATION CONFIDENTIAL AND PROPRIETARY TO SAMTEC, INC. AND SHALL NOT BE REPRODUCED OR TRANSFERRED TO OTHER DOCUMENTS OR DISCLOSED TO OTHERS OR USED FOR ANY PURPOSE OTHER THAN THAT WHICH IT WAS OBTAINED WITHOUT THE EXPRESSED WRITTEN CONSENT OF SAMTEC, INC.



520 PARK EAST BLVD, NEW ALBANY, IN 47150
PHONE: 812-944-6733 FAX: 812-948-5047
e-Mail info@SAMTEC.com code 55322

MATERIAL: DO NOT SCALE DRAWING SHEET SCALE: 3:1

SHELL, FERRULE, CAP: BRASS
CONTACT: COPPER ALLOY
DIELECTRIC: PTFE

DESCRIPTION:
SMB RIGHT ANGLE CABLE PLUG, RG174 & RG316-50 OHM

DWG. NO.
SMB5-P-C-XX-RA-CA1

REVISION J



1.40±0.30 [.06±.012]



4.30±0.30 [.17±.012]



9.50±0.30 [.37±.012]



J
IN-PROCESS 1
STRIP AND TIN INNER CONDUCTOR

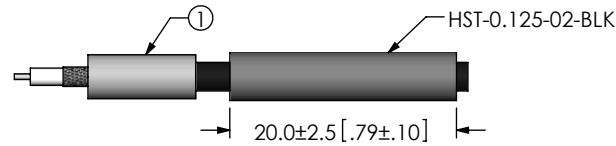

J
IN-PROCESS 2
ADD HEAT SHRINK TUBE AND FERRULE

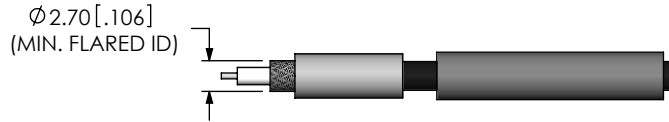

J
IN-PROCESS 3
FLARE SHIELD

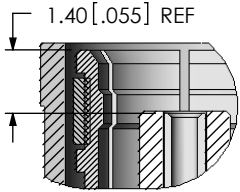

DETAIL 'A'
SCALE 6:1

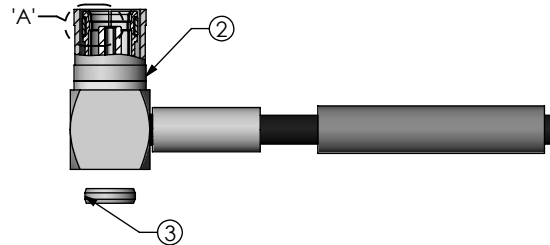

J
IN-PROCESS 4
ADD SUB ASSEMBLY

END OF CABLE DIELECTRIC SHOULD SEAT AGAINST CONTACT CUP

CABLE CENTER CONDUCTOR SHOULD NOT PROTRUDE OUTSIDE CONTACT CUP AFTER FERRULE IS CRIMPED

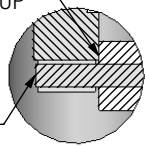

DETAIL 'C'
SCALE 6:1

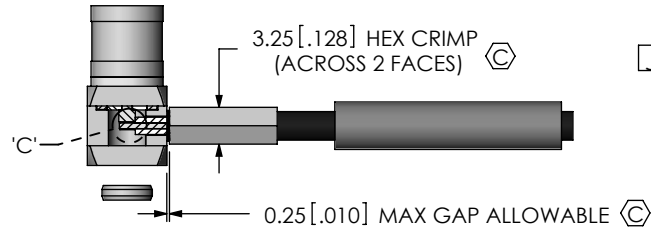

J
IN-PROCESS 5
CRIMP FERRULE AND SOLDER SIGNAL PIN
(USE RF CRIMP HAND TOOL # CAT-HT-126667-21 OR EQUIVALENT)

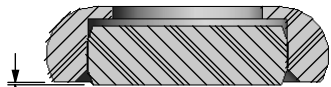

0.00±0.10 [.000±.004]

DETAIL 'B'
SCALE 6:1

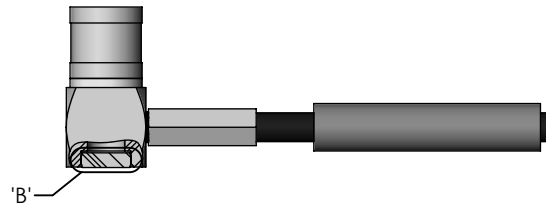

J
IN-PROCESS 6
INSERT CAP

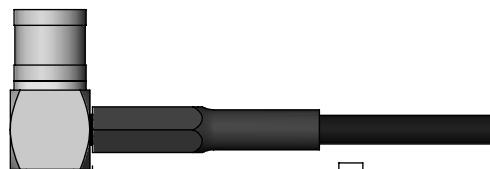

0.6 [.03] MAX GAP ALLOWABLE

J
IN-PROCESS 7
APPLY HEAT SHRINK TUBING

PROPRIETARY NOTE

THIS DOCUMENT CONTAINS INFORMATION CONFIDENTIAL AND PROPRIETARY TO SAMTEC, INC. AND SHALL NOT BE REPRODUCED OR TRANSFERRED TO OTHER DOCUMENTS OR DISCLOSED TO OTHERS OR USED FOR ANY PURPOSE OTHER THAN THAT WHICH IT WAS OBTAINED WITHOUT THE EXPRESSED WRITTEN CONSENT OF SAMTEC, INC.



520 PARK EAST BLVD, NEW ALBANY, IN 47150
PHONE: 812-944-6733 FAX: 812-948-5047
e-Mail: info@SAMTEC.com code 55322

DO NOT SCALE DRAWING

SHEET SCALE: 2:1

DESCRIPTION:
SMB RIGHT ANGLE CABLE PLUG, RG174 & RG316-50 OHM

DWG. NO.

SMB5-P-C-XX-RA-CA1

BY: G.HERMAN

12/11/2007

SHEET 2 OF 2