

REV.	ECN NO.	DATE	SIGN	DESCRIPTION
A	Initial Release	2012/08/13	Yulong	Change Rve.01 To Rve.A
B	LEN1580260	2015/05/28	Jinhai	Change Logo

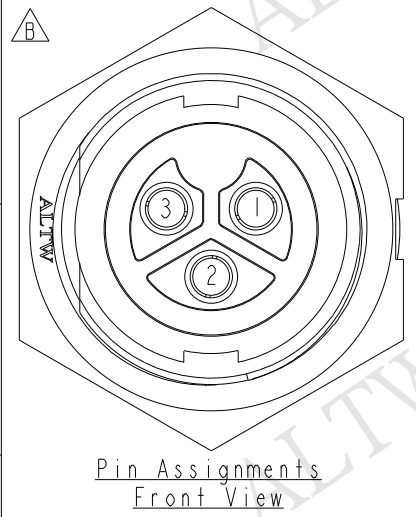
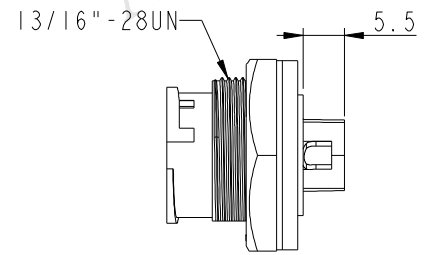
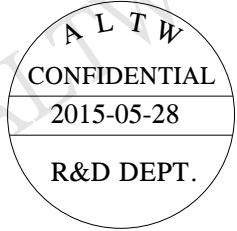
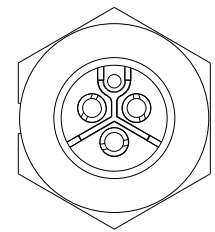
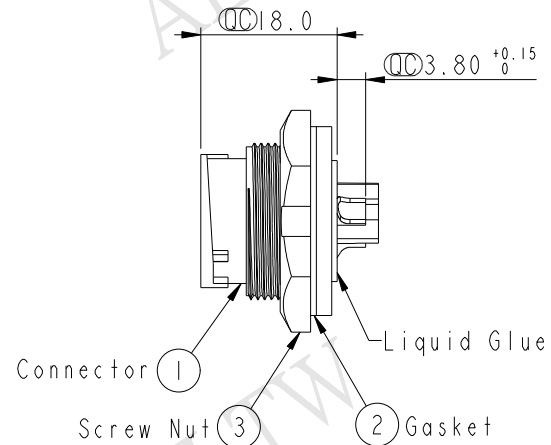
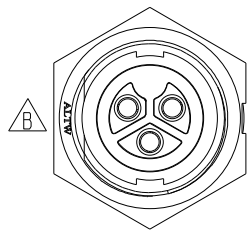
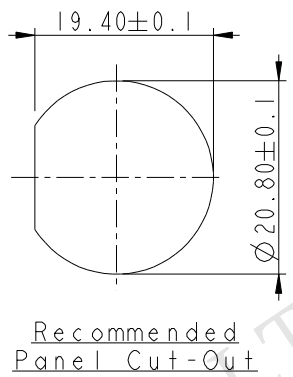

- Note:
- \*  $\text{CC}$  Important Dimension To Check.
  - \* Waterproof Rate: IP67
  - \* Connector: Nylon+GF, Black.
  - \* Female Pin: Copper Alloy, Gold Plated.
  - \* Screw Nut: Nylon+GF, Black.
  - \* Gasket: Silicone, UL94V-0, Gray.
  - \* Maximum Panel Thickness: 4.5mm.

UNIT: mm		
TOLERANCE		
.X	±0.25	
.XX	±0.1	
.XXX	±0.05	
ANGLES	±1°	

TITLE POWER PANEL LOCK 3PIN M CONN F PIN			
SCALE 1:1	SIZE A4	SHEET 1 OF 1	
REV. B	WC-REV. A.2	$\text{CC}$ : Inspection item	

**Amphenol LTW**  
安費諾亮泰企業股份有限公司

ITEM NO. PWC-03PMFS-LC7001	DRAWN BY Jinhai	DATE 2015-05-28
DWG NO. PWC-03PMFS-LC7001	CHECKED BY Tom	DATE 2015-05-28
CUSTOMER ALTW	APPROVED BY Jerry	DATE 2015-05-28

THIS DOCUMENT IS SUBJECT TO CHANGE WITHOUT NOTICE. IT IS CONFIDENTIAL AND A PROPERTY OF AMPHENOL LTW. DISCLOSURE TO THIRD PARTY HAS TO BE AUTHORIZED BY AMPHENOL LTW.