

THIS DOCUMENT IS SUBJECT TO CHANGE WITHOUT NOTICE. IT IS CONFIDENTIAL AND A PROPERTY OF Amphenol LTW. DISCLOSURE TO THIRD PARTY HAS TO BE AUTHORIZED BY Amphenol LTW.

REV.	ECN NO.	DATE	SIGN	DESCRIPTION
B	C210561	2021/04/15	Vicky	$\triangle B$ X4
C	C221877	2022/12/09	Ruru	$\triangle C$ XI

$\triangle B$   
MSAS-XXBFFB-SL7001

XX: No. Of Pin

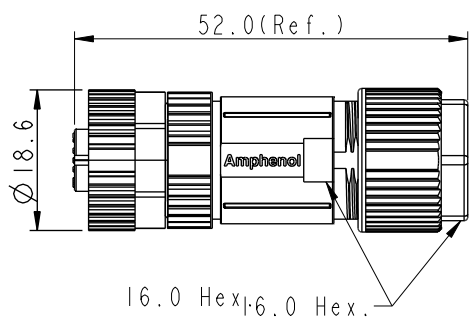
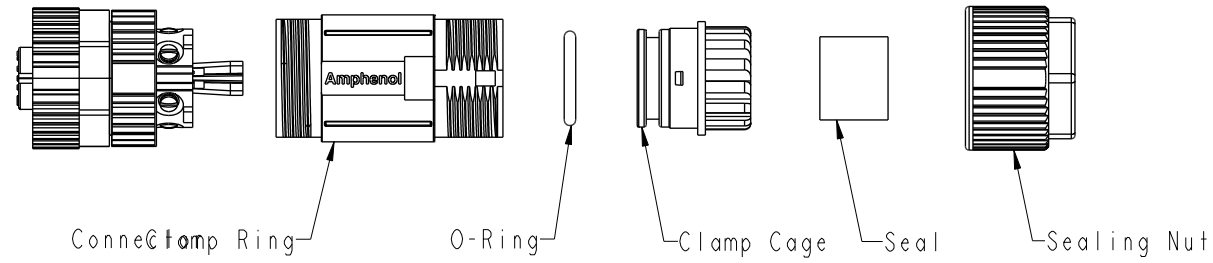

- $\triangle B$   
Note:
- \* RoHS Compliant
  - \*  $\odot$  Important Dimension
  - \*  $\triangle C$  Waterproof rate: IP67, mated Connector
  - Housing: Thermoplastic, Black
  - Pin: Copper alloy, Gold plated
  - Extension Nut: Metal
  - Nut: Metal
  - O-Ring: Rubber, Gray
  - \* Clamp Ring: Metal
  - \* O-Ring: Rubber, Gray
  - \* Clamp Cage: Thermoplastic, Black
  - \* Sealing Nut: Metal
  - \* Seal: Rubber, Gray, OD:  $\phi$ 4.0mm~ $\phi$ 7.5mm
  - \* One set unassembled in one pe bag

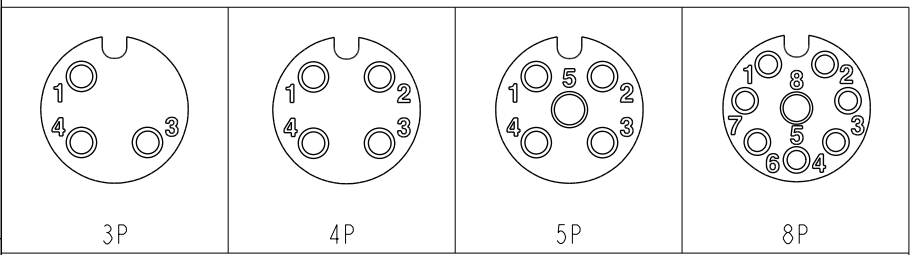

Pin Assignments Front View

UNIT: mm	$\odot$	$\triangle B$	TITLE N SEN, M12 A -SHLD, SCREW CABLE W/O SR, F, F, FI SCREW IN
TOLERANCE .X $\pm 0.25$ .XX $\pm 0.1$ .XXX $\pm 0.05$ ANGLES $\pm 1^\circ$	$\triangle B$	SCALE 1:1	SIZE A4
		REV. C	WC-REV. A.3
			$\odot$ : Inspection item

**Amphenol LTW**  
安費諾亮泰企業股份有限公司

ITEM NO.	DRAWN BY Mila	DATE 2015-09-23
DWG NO. MSAS-XXBFFB-SL7001	CHECKED BY Cary	DATE 2015-09-23
CUSTOMER ALTW	APPROVED BY Jerry	DATE 2015-09-23