

REV.	ECN NO.	DATE	SIGN	DESCRIPTION
A	Initial Release	2017/04/08	Frank Deng	Rev.01 To Rev.A
B	LE317B0191	2017/11/18	Frank Deng	Update Drawing
C	C231296	2023/10/13	Vicky	$\triangle C$ X2

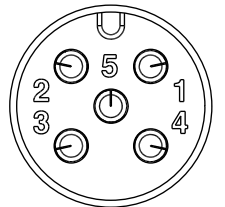
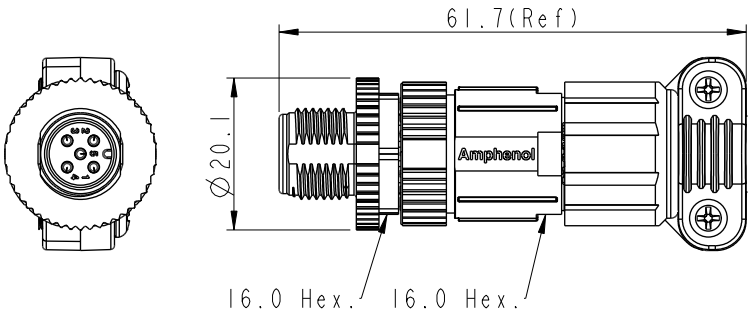
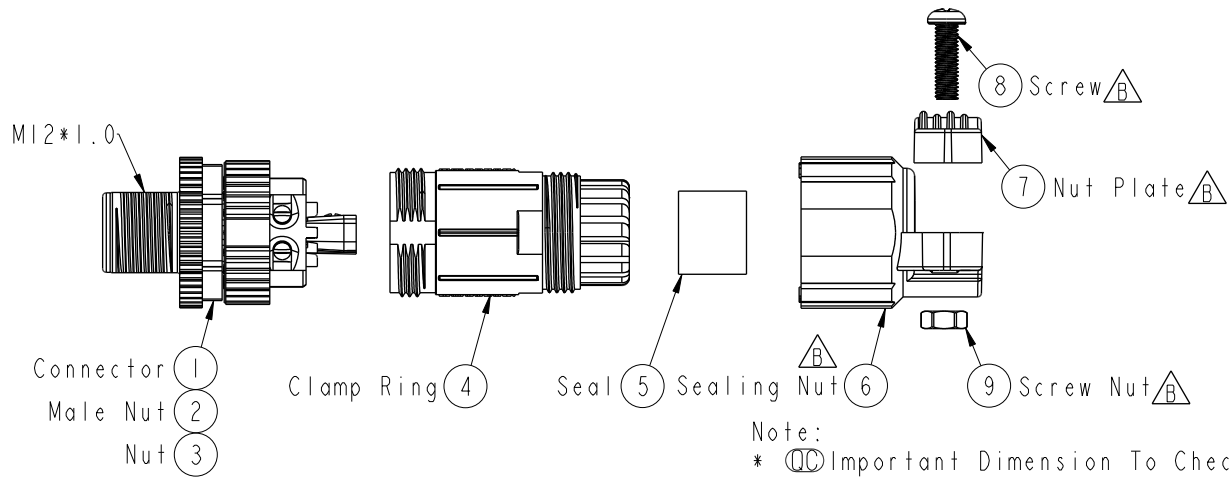

Pin Assignments
Front View

- Note:
- * \odot Important Dimension To Check.
 - * Waterproof Rate: IP67
 - * Housing: Nylon, Black
 - * Male Pin: Copper Alloy, Gold Plated
 - * Male Nut: Zinc Alloy, Nickel Plated
 - * Nut: PBT+PC, Black
 - * O-Ring: Silicon, Grey
 - * Clamp Ring: Nylon, Black
 - * Seal: Silicon, Grey
 - * Sealing Nut: Nylon+GF, Black
 - * Nut Plate: Nylon+GF, Black
 - * Seal For Cable OD: $\phi 4.0\text{mm} \sim \phi 8.0\text{mm}$
 - * Screws for Wire connection recommended tightening torque: 0.61~0.84 kgf.cm / 0.059~0.082 N.m
 - * Applicable Wire gauge (Stranded wire cross section) 0.14mm² (26AWG) ~ 0.82mm² (18AWG)
 - * Mating Recommended tightening torque: 4~6 kgf.cm / 0.39~0.59 N.m
 - * Sealing-Nut Recommended tightening torque: 4~6 kgf.cm / 0.39~0.59 N.m
 - * Detailed applicable wire specifications may vary depending on the actual wire construction.
 - * $\triangle C$ One set unassembled in one pe bag

UNIT:mm	\varnothing	∇
TOLERANCE		
.X	± 0.25	
.XX	± 0.1	
.XXX	± 0.05	
ANGLES	$\pm 1^\circ$	

TITLE NMEA, MC HEX. NUT 4A (APP) $\triangle C$ CABLE W/O SR, M, M, FI SCREW IN			
SCALE	SIZE	SHEET	OF
1:1	A4	1	1
REV.	WC-REV.	\odot : Inspection item	
C	A.2		

Amphenol LTW
安費諾亮泰企業股份有限公司

ITEM NO	DRAWN BY	DATE
HMC-05BMMB-SL7001	Frank Deng	2017-11-18
DWG NO	CHECKED BY	DATE
HMC-05BMMB-SL7001	Fisher Wang	2017-11-18
CUSTOMER	APPROVED BY	DATE
ALTW	Kevin Hu	2017-11-18

THIS DOCUMENT IS SUBJECT TO CHANGE WITHOUT NOTICE. IT IS CONFIDENTIAL AND A PROPERTY OF Amphenol LTW. DISCLOSURE TO THIRD PARTY HAS TO BE AUTHORIZED BY Amphenol LTW.