

# SMD Power Inductor

## CDEIR10D50ME



### Description

- Metal alloy core construction
- Magnetically shielded
- L×W×H: 11.5×10.7×5.2mm Max.
- Product weight : 2.7 g (Ref.)
- Moisture Sensitivity Level: 1

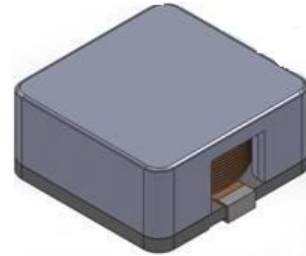

### Applications

- Ideally used in Notebook, PDA and other high current application

### Environmental Data

- Operating temperature range: -40°C ~ +125°C (including coil's self temperature rise)
- Storage temperature range: -40°C ~ +125°C

### Packaging

- Carrier tape and reel packaging.
- 13.0" diameter reel
- 500pcs per reel

### Dimension - [mm]

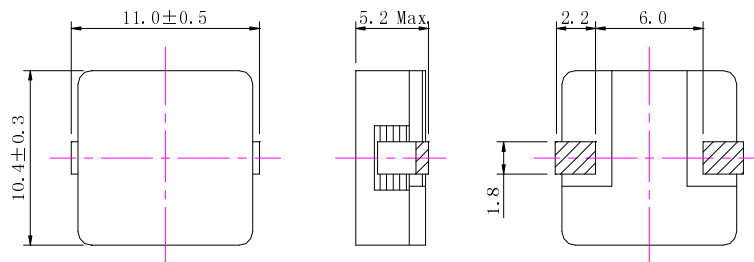

### Land pattern and Schematics - [mm]

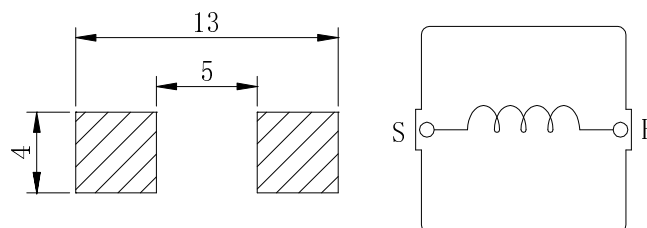

Note: This specification is subject to change without notice. Please contact your nearest sales office for updated information when placing an order.

# SMD Power Inductor

## CDEIR10D50ME



### Electrical Characteristics

Part No.	Stamp	Inductance ( $\mu$ H) [Within]※1	D.C.R.(m $\Omega$ ) [Max.] (Typ.) (at 20°C)	Saturation Current (A) Typ. (at 20°C) ※2	Temperature Rise Current (A) Typ. ※3
CDEIR10D50MENP-R22MC	R22	0.22 $\pm$ 20%	1.2 (1.0)	70.0	22.0
CDEIR10D50MENP-R47MC	R47	0.47 $\pm$ 20%	1.9 (1.6)	60.0	20.0
CDEIR10D50MENP-1R0MC	1R0	1.00 $\pm$ 20%	3.0 (2.5)	34.0	17.0
CDEIR10D50MENP-2R2MC	2R2	2.20 $\pm$ 20%	6.2 (5.0)	26.0	12.5
CDEIR10D50MENP-3R3MC	3R3	3.30 $\pm$ 20%	10.2 (8.5)	20.0	8.2
CDEIR10D50MENP-4R7MC	4R7	4.70 $\pm$ 20%	12.0 (10.0)	18.0	7.8
CDEIR10D50MENP-6R8MC	6R8	6.80 $\pm$ 20%	19.2 (16.0)	14.0	5.8
CDEIR10D50MENP-100MC	100	10.0 $\pm$ 20%	25.2 (21.0)	12.0	5.0

※1 Measuring conditions Inductance at 100kHz 1V.

※2 Saturation current: the actual value of D.C. current when inductance is above 80% of its nominal value.

※3 Temperature rise current: the actual value of D.C. current when temperature of coil increased  $\Delta T=40^{\circ}\text{C}$   
( $T_a=20^{\circ}\text{C}$ )

Note: This specification is subject to change without notice. Please contact your nearest sales office for updated information when placing an order.

# SMD Power Inductor

## CDEIR10D50ME



### Saturation Current & Temperature Rise Graph

— L (20°C) —  $\Delta T$

1. CDEIR10D50MENP-R22MC

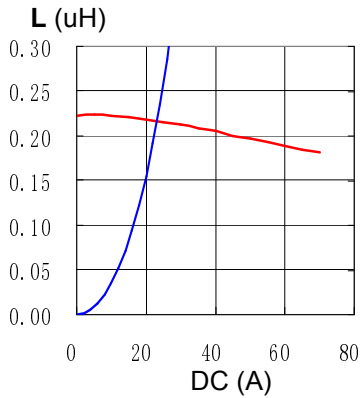

2. CDEIR10D50MENP-R47MC

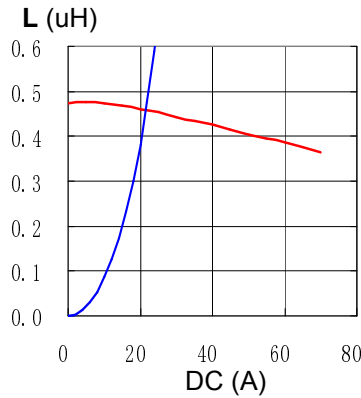

3. CDEIR10D50MENP-1R0MC

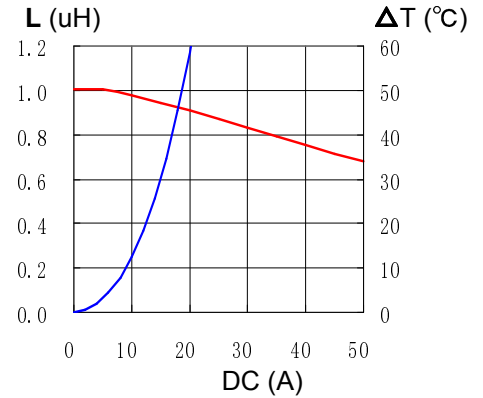

4. CDEIR10D50MENP-2R2MC

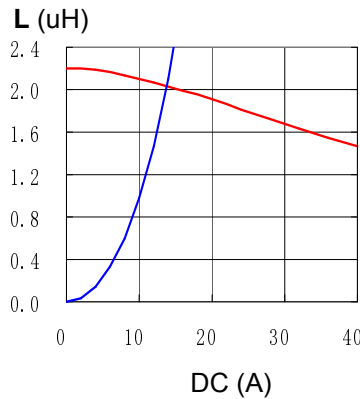

5. CDEIR10D50MENP-3R3MC

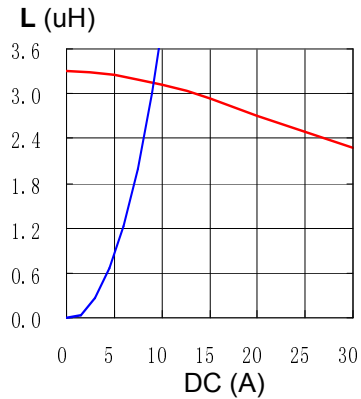

6. CDEIR10D50MENP-4R7MC

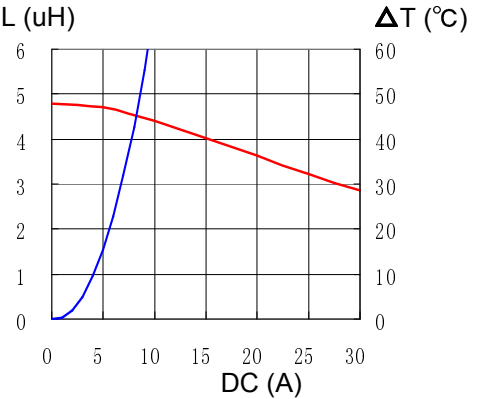

7. CDEIR10D50MENP-6R8MC

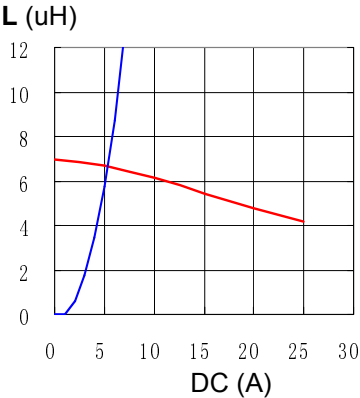

8. CDEIR10D50MENP-100MC

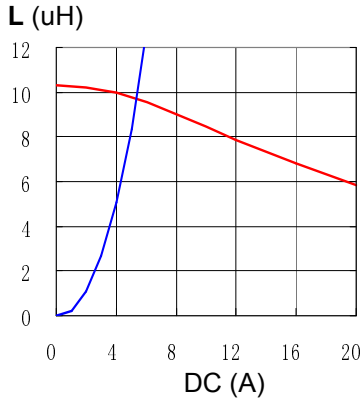

Note: This specification is subject to change without notice. Please contact your nearest sales office for updated information when placing an order.

# SMD Power Inductor CDEIR10D50ME



## Solder Reflow Condition

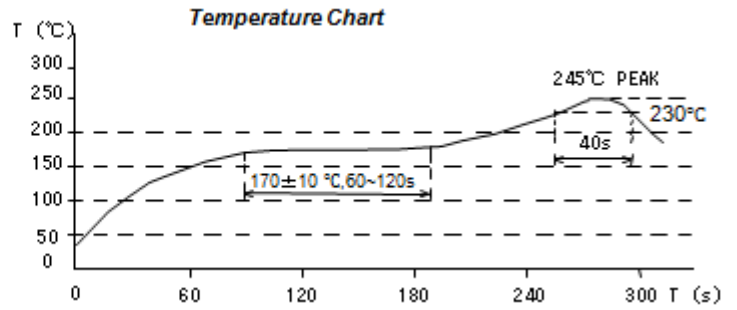
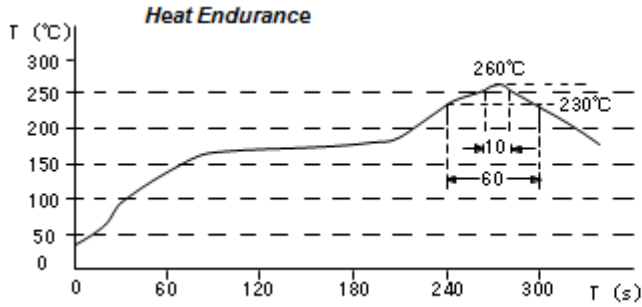

For sales office information, please [click here](#) to visit our website.

Note: This specification is subject to change without notice. Please contact your nearest sales office for updated information when placing an order.