

RoHS Compliant

REV	SIGN	DATE	DESCRIPTION	APPROVER
A0		2021.03.08	Initial Release	LENA

*THIS IS CAD DRAWING, DO NOT REVISE MANUALLY!!!*

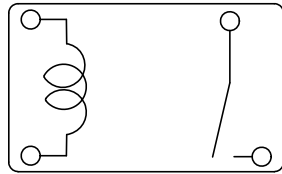
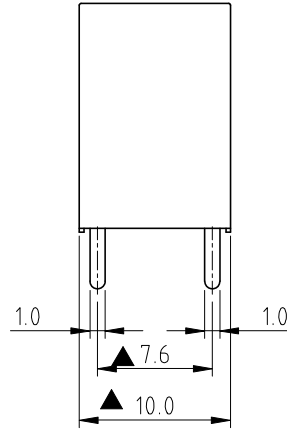
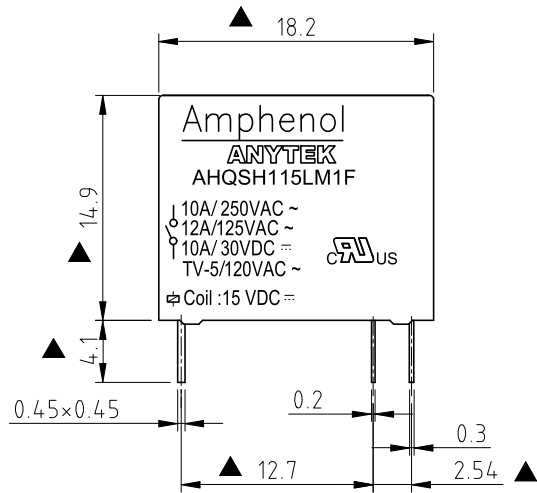

**COIL SPECIFICATION**

- Coil Nominal Voltage: 15V DC
- Coil Nominal Current: 13.3mA
- Coil Resistance: 1,125Ω ±10%
- Coil Power Consumption: Abt. 0.2W
- Pull-In Voltage(VDC): 12V Max
- Drop-Out Voltage(VDC): 0.75V Min
- Maximum Allowable Voltage: 16.5V
- Operate Time: 10 mSec. Max.
- Release Time: 5 mSec. Max.

**CONTACT RATING**

- Rated Load(Resistive): 10A 250V AC, 12A 125VAC, 10A 30V DC,
- Rated Carrying Current: 10A
- Max. Allowable Voltage: AC 250V / DC 30V
- Max. Allowable Current: 12A
- Max. Allowable Power Force: 2,500VA 300W
- Contact Material: Ag Alloy
- Contact Form: SPST

**ELECTRICAL**

- Dielectric Strength:
  - Between Coil & Contact: 4,000V AC (50/60 Hz for 1 minute)
  - Between Contact: 1,000V AC (50/60 Hz for 1 minute)
- Contact Resistance: 100mΩ Max. at 1A, 6V DC
- Insulation Resistance: 100MΩ Min at 500V DC

**MECHANICAL**

- Life Expectancy(Operations):
  - Electrical: 1 x 10<sup>5</sup> operations at Rated Resistive load
  - Mechanical: 1 x 10<sup>7</sup> operations at No Resistive load
- Operating Temperature: -40°C ~ 105°C
- Safety Approval: UL

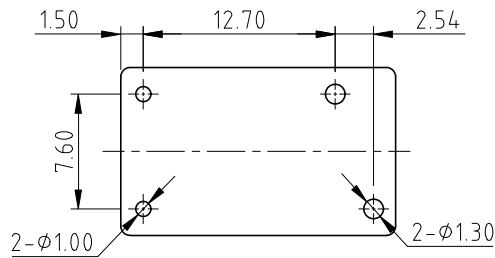

P.C.B. LAYOUT  
Bottom View

Part No. AHQ SH 1 15 L M 1 F 00G

- Insulation System: F : Class F
- Rated Carrying Current: 1 : 10A
- Contact Form: M : One Form A
- Coil Type: L : High DC
- Coil Voltage: 15: 15V(VDC)
- Number of pole, 1: One Pole
- Type of sealing : SH:RT III wash tight
- TYPE : AMI

**Amphenol ANYTEK**

**CUSTOMER COPY**

ALL RIGHTS RESERVED. REPRODUCTION OR ISSUE TO THIRD PARTIES IN ANY FORM WHATSOEVER IS NOT PERMITTED WITHOUT WRITTEN AUTHORITY FROM THE PROPRIETOR. PROPERTY OF ANYTEK TECHNOLOGY CO., LTD

TITLE	AHQ Series Relay, 15V DC, RT III Wash Tight				DWG NO.		8AHQ0002	
PART NO.	AHQSH115LM1F00G				CUST NO.			
APPROVED	CHECKED	DESIGNED	DRAWN	Tolerance				
		LENA	LENA	X. ±0.50				
		2021.03.08	2021.03.08	X.X ±0.30				
				UNIT: mm				
				SCALE: 2:1				
				SHEET: 01/01				
				REV: A0				
				X.XX ±0.10				
				X° ±1°				