

# 10. 外形图/Outside View

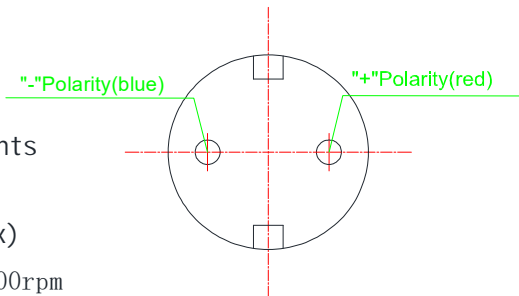
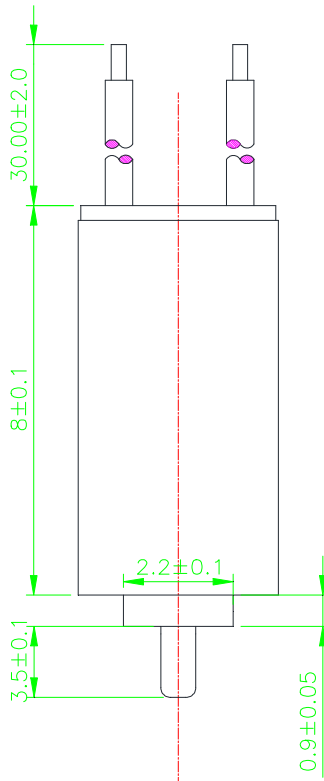
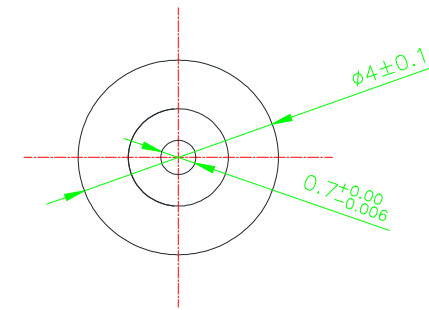

## 电机技术指标/Technical requirements

1. 额定电压/Rated voltage: 2.0 V
2. 额定电流/Rated current: 100 mA (Max)
3. 额定转速/Rated speed: 13000 ± 3000 rpm
4. 启动电压/Starting Voltage: 1.5V (Max)
5. 线圈阻抗/Terminal Resistance: 31 ± 15% Ω

旋转方向/Rotation: CW/CCW 7.

轴间串量: 0.2 ± 0.1 mm

硬度	投影角 第一角	未注公差 ±0.05/±0.5	材料	比例 10/1	日期 2018/07/02
设计	审核	批准	名称		
JIE YI ELECTRONICS LIMITED			型号	JYD040811	
			图号		