

REV.	ECR/N NO./DESCRIPTION	DATE	DRAWN	CHECKED	APPROVE
1	SN15101	09/05'15	Victor	Vito	Barney
2	SN16004	01/21'16	Victor	Vito	Gear
3	SN19053	05/13'19	Rover	Vito	Frank

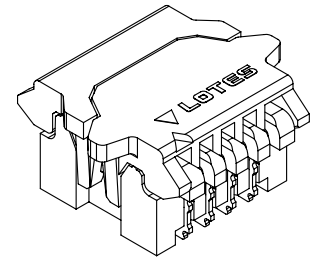

- NOTES:
- MATERIAL:
 - HOUSING:LCP,UL94V-0,BLACK.
 - COVER:LCP,UL94V-0,BLACK.
 - CONTACT:Phosphor Bronze.
 - FINISH:SEE TABLE 1
 - RoHS COMPLIANT. HF COMPLIANT.
 - ELECTRICAL PERFORMANCE
 - Contact resistance:30mΩ MAX.
 - Insulation resistance:1000MΩ MIN
 - MECHANICAL PERFORMANCE
 - Durability:25 cycles
 - IR REFLOW TEMPERATURE:260°C FOR 10 SECONDS.
 - PRODUCT NUMBER NOTE

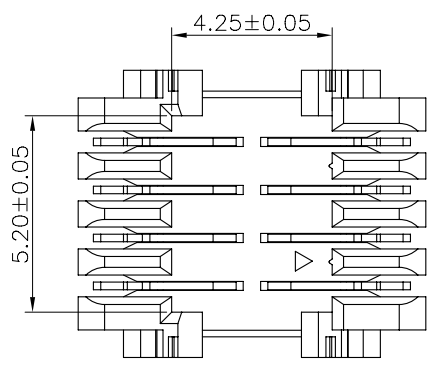
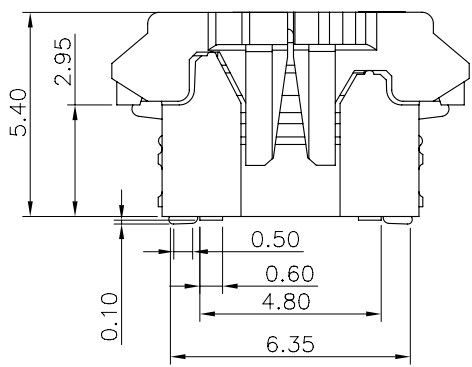
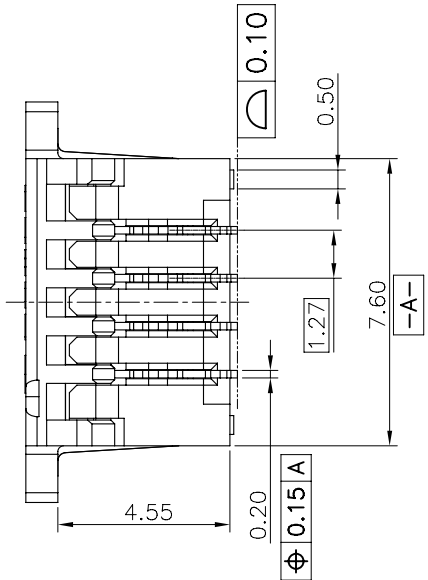
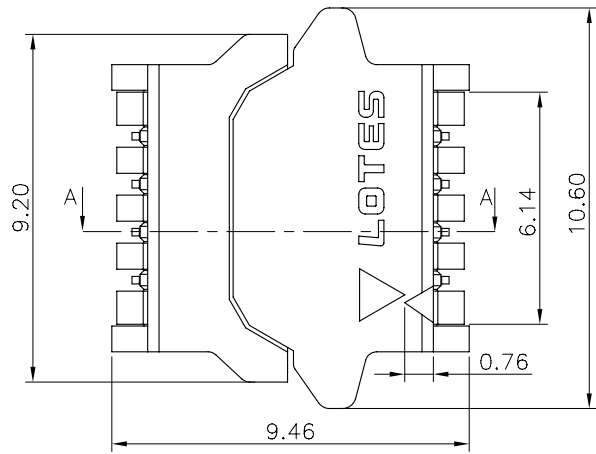
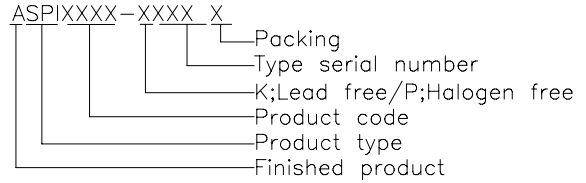

THE TOP VIEW WITHOUT COVERS

TABLE 1

2	ASPI0001-P002A	Ni 50u" MIN, Au 15 u" min ON CONTACT, G/F ON SOLDER AREA;
1	ASPI0001-P001A	Ni 50u" MIN,G/F 1 u" min ON CONTACT AREA AND SOLDER AREA;

NO.	PART NO.	DESCRIPTION	
GENERAL TOLERANCES UNLESS SPECIFIED		<div style="text-align: center;">LOTES</div> TITLE SPI FLASH SOCKET FOR SOIC 8PIN 150 Mil	
.X ±0.35	X.° ±3°		DWG NO. AP-ASPI0001-P
.XX ±0.25	.X° ±2°		
.XXX ±0.15	.XX° ±1°		
CUSTOMER DRAWING		SHEET 1/3 SCALE 5:1 REV 3	
SIZE A4	UNITS MM [INCH]	DRAWN BY SKY CHECKED BY Vito APPROVED BY Barney PART NO. SEE TABLE 1	

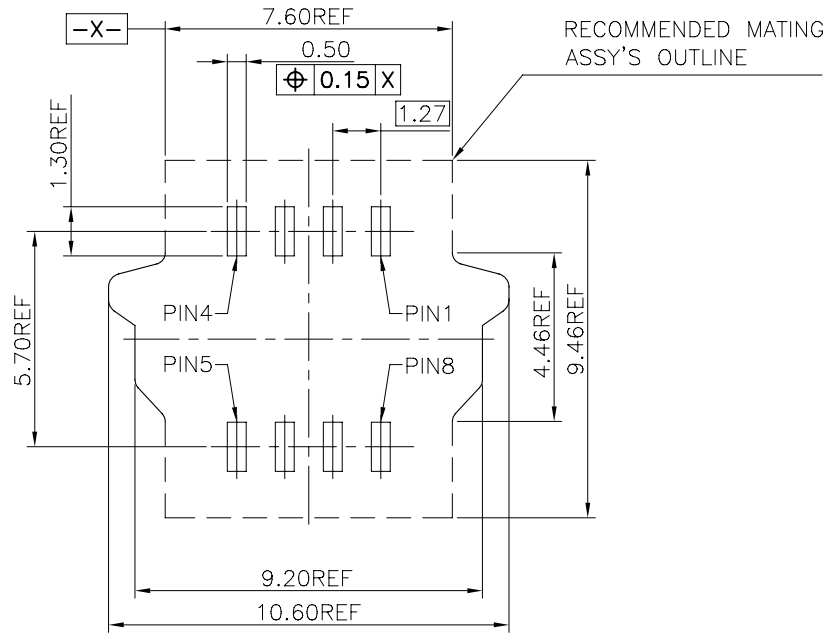

RECOMMENDED PCB LAYOUT FOR USE
TOLERANCE:±0.05mm

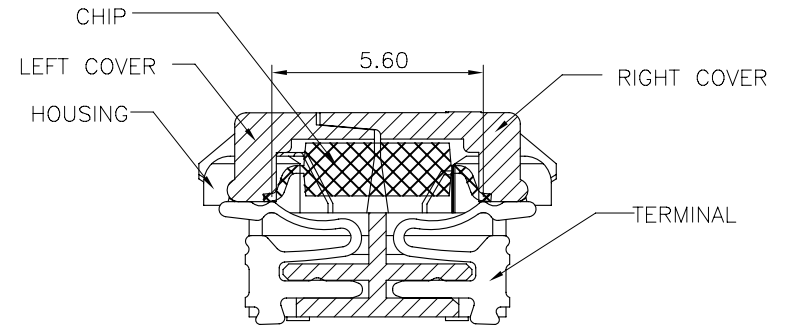
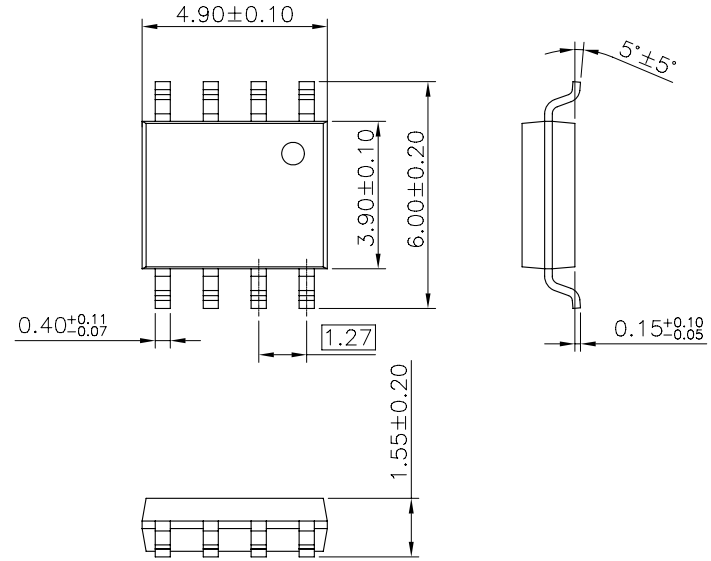
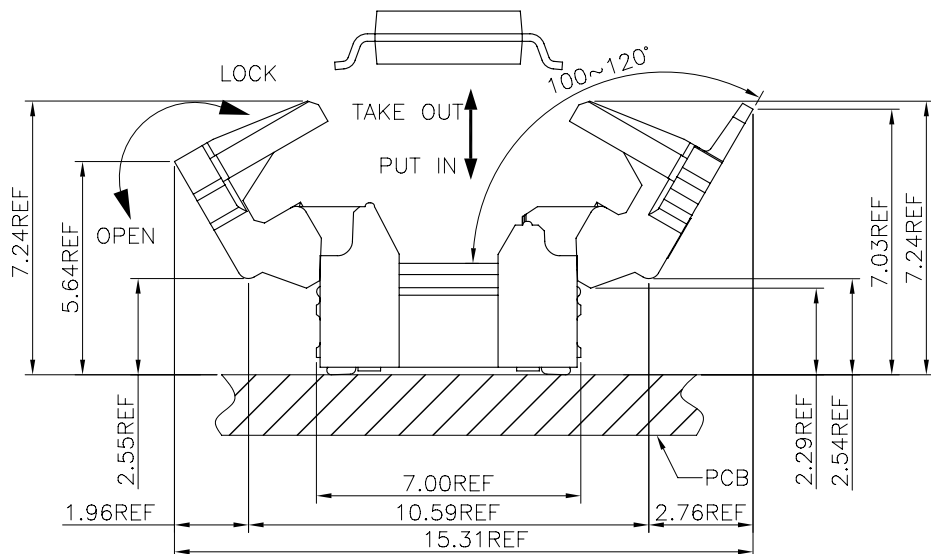

SECTION A-A

GENERAL TOLERANCES UNLESS SPECIFIED		PART NO. SEE TABLE 1	LOTES				
.X ±0.35	X.° ±3°						APPROVED BY Barney
.XX ±0.25	.X° ±2°		CHECKED BY Vito	DWG NO. AP-ASPI0001-P			
.XXX ±0.15	.XX° ±1°	CUSTOMER DRAWING	DRAWN BY SKY	REV			
SIZE A4	UNITS MM [INCH]	DRAWN BY SKY		SHEET		SCALE	REV
				2/3		5:1	3

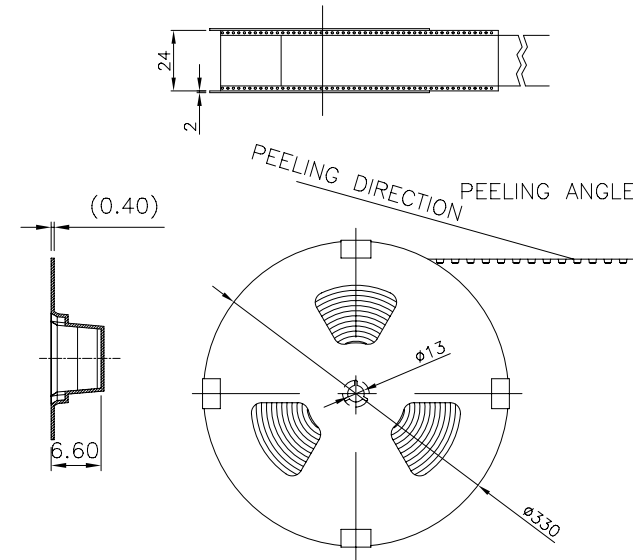
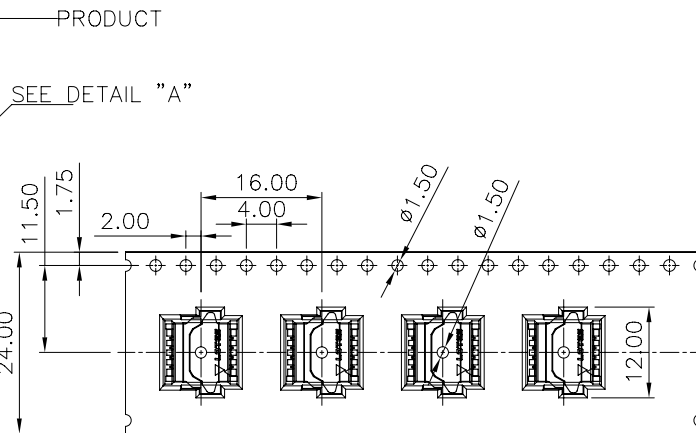
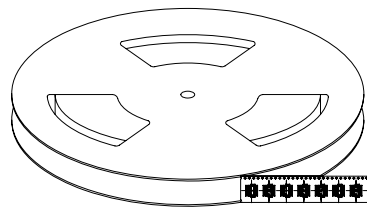

THE HEAD EMPTY 10 PCS AND
TAIL EMPTY 15 PCS

GATHER MATERIAL
DIRECTION

DETAIL "A"

INPUT MATERIAL
DIRECTION

(THE DIRECTION FOR
CUSTOMER USING)

PE BAG

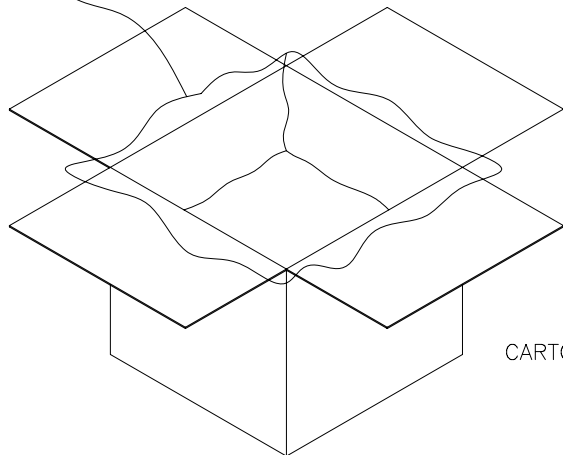

CARTON

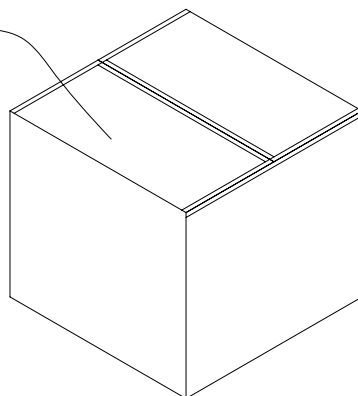

NOTES:

1. THE OPERATION OF PACKING REFER THE LEFT PROCESS.
2. PACKING LIST.

DESCRIPTION	P/N	SPECIFICATION	QT'Y(PCS)
PRODUCT	SEE TABLE 1	SEE TABLE 1	2100
CARTON	S09-1-30014-K01	340*340*113;K=K	1
REEL	G09-04-30002-02	W=24.4;13"	3
CARRY TAPE	S09-5-10010-P01	24*16*6;PS_CLARITY	11.6*3M
COVER TAPE	G09-05-20032-P01	20.7*0.05	11.6*3M
PE BAG	G09-06-50002-02	520*520*460;T=0.05mm	1
DUNK COTTON	S09-3-30009-K01	335*335*10;material EPE	2
DESICCANT	G09-07-00001-01	2g/BAG	4BAG

GENERAL TOLERANCES
UNLESS SPECIFIED

.X ±0.35	X.° ±3°
.XX ±0.25	X.° ±2°
.XXX ±0.15	.XX° ±1°

PART NO.
SEE TABLE 1

APPROVED BY
Barney

CHECKED BY
Vito

DRAWN BY
SKY

LOTES
TITLE
SPI FLASH SOCKET FOR
SOIC 8PIN 150 MII

DWG NO.
AP-ASPI0001-P

	SHEET	SCALE	REV
	3/3	1:1	3

SIZE	UNITS
A4	MM [INCH]