

## 1210 AWG Vinyl Insulated Spade Terminals with Support Sleeve

**Material:** Tin Plated Copper with Butted Seam

**Insulation Material:** Yellow Vinyl with Funnel Entry Copper Support Sleeve

**Maximum Electrical Current:** 50 Amps

**Barrel ID (d1):** .134

**Maximum Electrical Rating:** 75°C, 600V

**Barrel OD (D):** .268

**Material Thickness (T):** .039

**Barrel Length (E):** .531

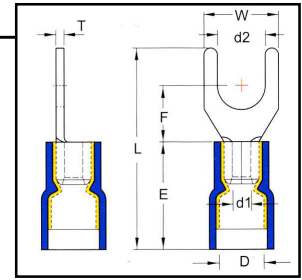

HOFFMAN PART NO.	STUD SIZE	DIMENSIONS (INCHES)				UL	TAPE MOUNTED REEL QTY	DIE FOR TAPE MOUNTED	HAND TOOL
		STUD DIAMETER d2	TONGUE WIDTH W	STUD CLEARANCE F	LENGTH L				
FVD1210S3A	6	.146	.283	.295	.980	Y	1000	3V1210	YNM2210D
FVD1210S4A	8	.169	.327	.276	1.024	Y	1000	3V1210	YNM2210D
FVD12105A	10	.209	.354	.276	1.024	Y	1000	3V1210	YNM2210D
FVD12106A	1/4	.252	.472	.472	1.260	Y	1000	3V1210	YNM2210D

## Nylon Insulated Spade Terminals

### 2622 AWG Nylon Insulated Spade with Support Sleeve

**Material:** Tin Plated Copper with Butted Seam

**Insulation Material:** Yellow 6/6 Nylon with Funnel Entry Copper Support Sleeve

**Maximum Electrical Current:** 8 Amps

**Barrel ID (d1):** .039

**Maximum Electrical Rating:** 75°C, 600V

**Barrel OD (D):** .091

**Material Thickness (T):** .197

**Barrel Length (E):** .315

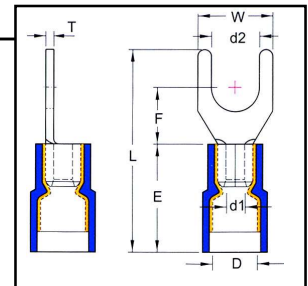

HOFFMAN PART NO.	STUD SIZE	DIMENSIONS (INCHES)				UL	TAPE MOUNTED REEL QT	DIE FOR TAPE MOUNTED	HAND TOOL
		STUD DIAMETER d2	TONGUE WIDTH W	STUD CLEARANCE F	LENGTH L				
FND26222A/J	4	0.126	0.181	0.177	0.673	N	NA	NA	YNT2622
FND26223.7A/J	6	0.146	0.252	0.303	0.760	N	NA	NA	YNT2622
FND26224A/J	8	0.169	0.276	0.248	0.801	N	NA	NA	YNT2622