

PART NO.	A79429-001	REV	ECO	DATE	APP
		A	102788	08-08-16	HV

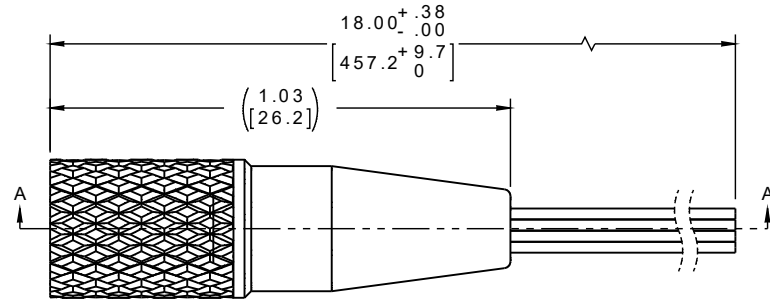

SOCKET #	COLOR
1, 11	BLACK
2	BROWN
3	RED
4	ORANGE
5	YELLOW
6	GREEN
7	BLUE
8	VIOLET
9	GRAY
10	WHITE

INTERNAL USE ONLY  
USE MFG LOADING  
PROCEDURE NC-11S

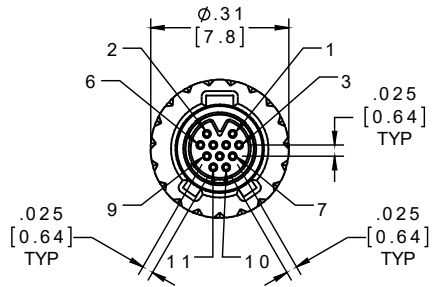
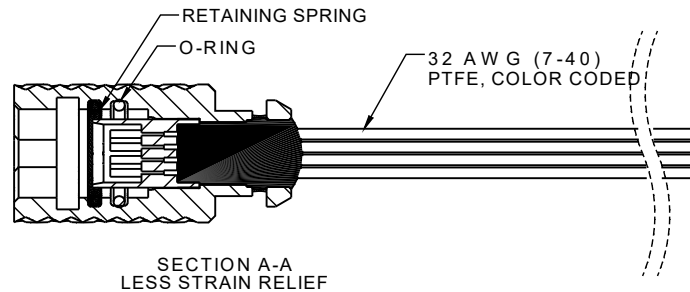
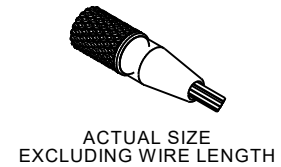

SECTION A-A  
LESS STRAIN RELIEF

NOTES:

1. DIMENSIONS IN [ ] ARE IN MILLIMETERS UNLESS OTHERWISE NOTED AND ARE FOR REFERENCE ONLY.

THIRD ANGLE DIMENSIONS UNLESS OTHERWISE NOTED DIMENSIONS IN INCHES 2 PL DEC: .01 3 PL DEC: .005 4 PL DEC: .0005 ANGLES ± 1°	THIS DRAWING CONTAINS CONFIDENTIAL AND PROPRIETARY INFORMATION WHICH IS THE PROPERTY OF OMNETICS CONNECTOR CORP. THIS DOCUMENT MAY NOT, IN WHOLE OR IN PART, BE DUPLICATED, OR DISCLOSED FOR ANY PURPOSE, WITHOUT WRITTEN PERMISSION FROM OMNETICS CONNECTOR CORP.	<b>OMNETICS</b> <b>CONNECTOR CORPORATION</b> 7260 COMMERCE CIRCLE EAST MINNEAPOLIS, MN 55432 WWW.OMNETICS.COM	CAGE CODE 61873 DWG NO. A79429-001 SHEET 1 OF 2 SCALE: 3:1	
	DFTM. ERB CHK'D. APP'D.	DATE 03-07-16	TITLE: (11) SOCKET FEMALE KEYED NANO BREAK AWAY CIRCULAR CONNECTOR	REV A