

NOTES:  
1 - BURNISH TO BREAK SHARP EDGES.

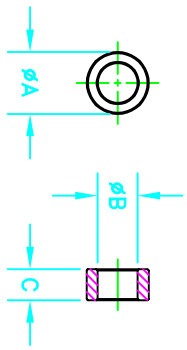

**A** 12.45/12.95      **B** 8.00/8.40      **C** 6.10/6.60  
 .500                      .323                      .250

ELECTRICAL SPECIFICATIONS

$\Sigma I / A(\text{mm}^{-1})$	$l_e$ (mm)	$A_e$ (mm <sup>2</sup> )	$V_e$ (mm <sup>3</sup> )	$L_o$ (nH)	$A_L$ (nH) @10kHz <10gauss	$\tan \delta / 4$ @1MHz 1gauss
2.2618	31.8	14.06	447	0.556	68±25%	≤75X10 <sup>-6</sup>

SIZE	PART NO.	REV.
B	5961004101	2

Bold numbers are in millimeters\*\*, light numbers are in inches

REV.	DATE	DESCRIPTION	DRFT
2	06-22-05	D.S. 06-22-05	
1	06-10-02	D.S. 06-10-02	
REVISIONS ECN      AL TOLERANCE WAS ±20% ADDED LOSS FACTOR SPECIFICATION			
APPLICABLE SPECS		DRAWING CLASS	
Tolerances Unless Otherwise Indicated		FR# 61	
3PL 2PL FRACT ANGLE		FINISH	
TITLE		TOROID	
FAIR-RITE PRODUCTS CORP.		SCALE NONE	
DRAWN BY K. ROOSA		DATE 03-26-1998	
CHKD BY		SIZE PART NO. B 5961004101	
APPRVD BY		REV. 2	
SHEET 1		of 1	