

order number	lens name	f-stop
0009-194-000-40	Macro-CCD-Lens -4x	5.2

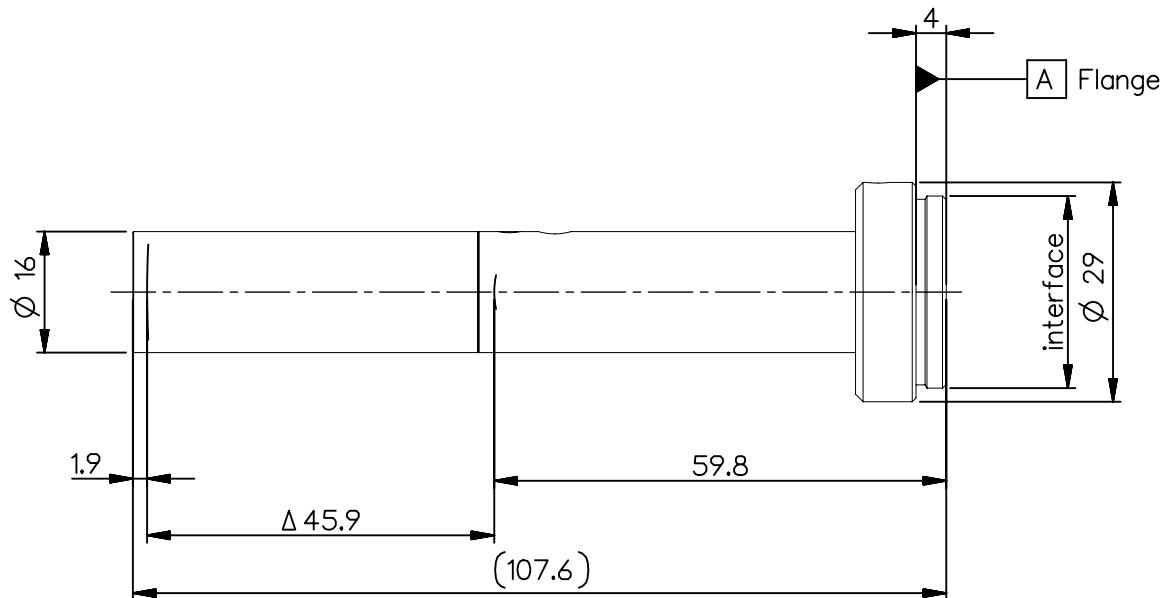

Specification		ON	
image circle max. (mm)	11	working distance (mm)	75
focal length f' (mm)	19.8	interface	C-mount
magnification β' [range]	-4	filter thread	-
spectral range λ (nm)	400 - 750	weight (g)	40
schematic diagram *) in air 		design includes CCD cover glass: no	
		SF (mm)	-72.0
		S'F' (mm) *)	-5.9
		HH' (mm) *)	72.3
		SH (mm)	-52.2
		S'H' (mm) *)	-25.8
		SEnP (mm)	
		S'ExP (mm) *)	
		f-stop	
		\varnothing EnP	
		\varnothing ExP	

NX PROTECTIVE NOTE "DIN ISO 16016" TO BE OBSERVED	EU-D		AL-T1A		US-D		US-ML		not export controlled	
	REV		ECC		DATE		APPROVED		GENERAL TOLERANCE OF DIMENSION, FORM, POS.	
	a		Neuausg						SCALE 1:1	
	b		11-0358		20.07.11		Kuehne		MATERIAL	
c		14-0184		17.09.14		Schiff e		TITLE		
d		17-0915		20.03.18		Denk		Macro-CCD-Lens 4x		
								BASIC TOLERANCING PRINCIPLE		
								FIRST DATE NAME		
								ISSUE 17.09.14 Schifferer		
								CHKD 17.09.14 Stauder		
								DRAWING NO.		
								0009-194-100-40-0001d		
								SHEET 1		
								OF 1		
DIN A 4		ALL DIMENSIONS ARE IN MM AND INCLUDE SURFACE TREATMENT						REPLACES		