

REV.	EN. NO.	DESCRIPTION	SIGN	DATE
C1	N/A	INITIAL DRAWING	Liu	2019/08/13

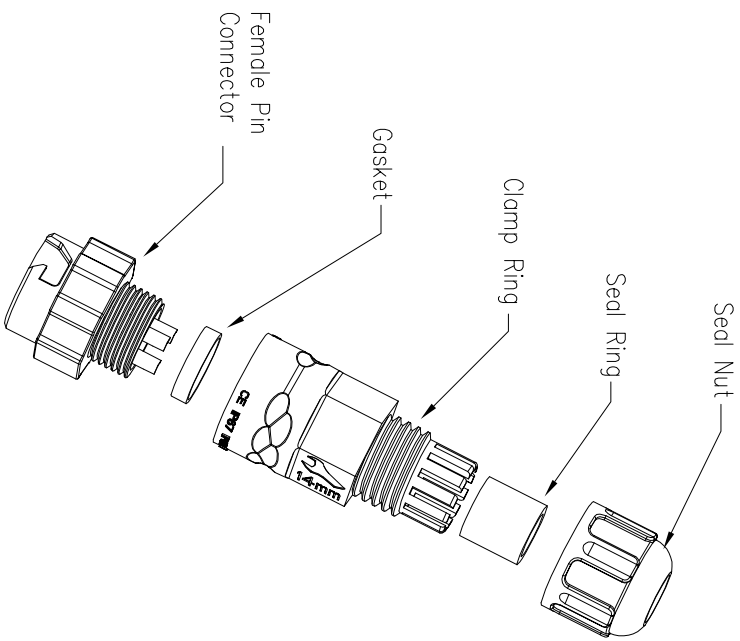
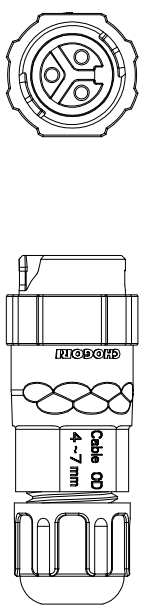
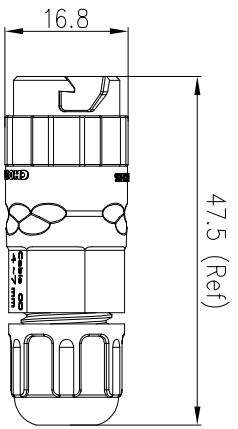

- Specification:
- 1.Operation Temperature: -45°C~105°C.
  - 2.Insulation Resistance: 100MΩ at DC500V.
  - 3.Contact Resistance: <10mΩ
  - 4.Withstand Voltage: 2000V AC
  - 5.Operating Current:10A
  - 6.Operating Voltage: AC 300V
  7. Waterproof Rate: IP67 (Mated)
  8. Seal Nut: Nylon, Black
  9. Seal Ring: Silicon, Black.
  10. Clamp Ring: Nylon, Black
  11. Gasket: Silicon, Red
  12. Female Pin: Copper Alloy, Gold Plated
  13. Connector: Nylon+GF, Black
  14. RoHS Compliant.
  15. UL Compliant.
  16. Cable Range OD: φ3.5mm~φ6.8mm
  17. Mating Cap: 806-00062-00

22XXX431-01

Pin Number

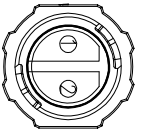

2 Pin

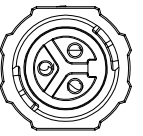

3 Pin

P/N: 22002431-01 P/N: 22003431-01

Pin Assignments Front View

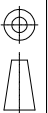

UNIT: mm  
 TOLERANCE  
 X ±0.25  
 XX ±0.15  
 XXX ±0.05  
 ANGLES ±1°

DESCRIPTION

Standard Series Push Lock  
 Female Plug With Female Pin

SCALE: 1:1  
 REV: C1 SIZE: A4  
 SHEET: 1 OF 1  
 \* : Inspection Item

**CHOGORI**

PART NO 22XXX431-01

DRAWN BY Liu

DATE 2019/08/13

DWG NO

CHECKED BY Mo

DATE 2019/08/13

CUSTOMER

APPROVED BY Pansson

DATE 2019/08/13