

REV.	EN. NO.	DESCRIPTION	SIGN	DATE
C1	N/A	INITIAL DRAWING	Liu	2019/08/13

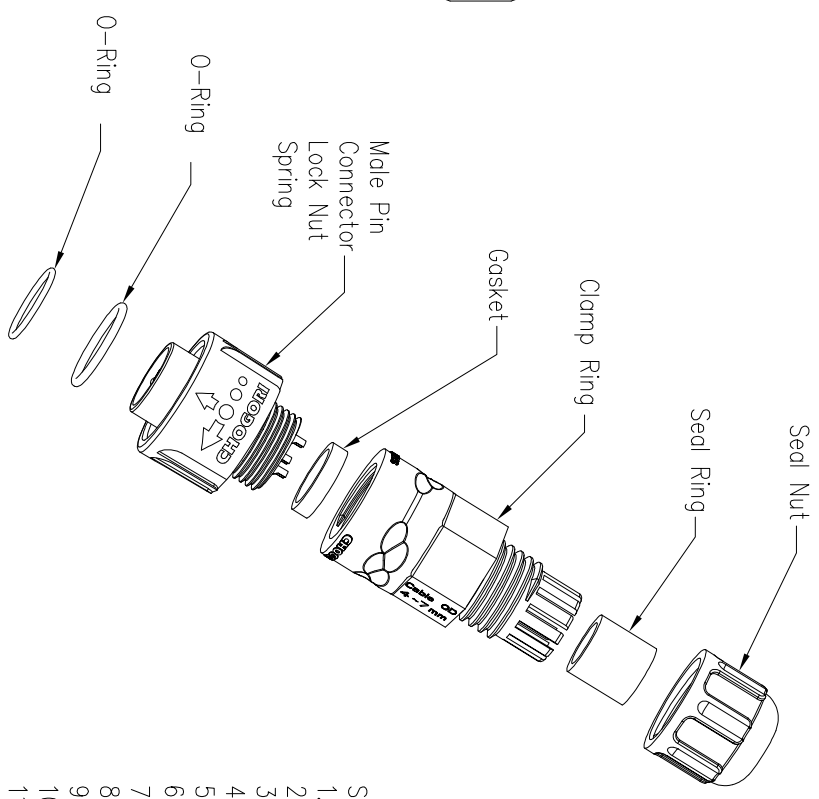

- Specification:
- 1.Operation Temperature: -45°C~105°C.
  - 2.Insulation Resistance: 100MΩ at DC500V.
  - 3.Contact Resistance: <10mΩ
  - 4.Withstand Voltage: 2000V AC
  - 5.Operating Current: 10A
  - 6.Operating Voltage: AC 300V
  7. Waterproof Rate: IP67 (Mated)
  8. Seal Nut: Nylon, Black
  9. Seal Ring: Silicon, Black
  10. Clamp Ring: Nylon, Black
  11. Gasket: Silicon, Red
  12. Male Pin: Copper Alloy, Gold Plated
  13. Connector: Nylon+GF, Black
  14. Lock Nut: Nylon, Blue
  15. Spring: SUS
  16. O-Ring: Silicon, Red
  17. RoHS Compliant.
  18. UL Compliant.
  19. Cable Range OD: φ3.5mm~φ6.8mm
  20. Mating Cap: 804-00009-00

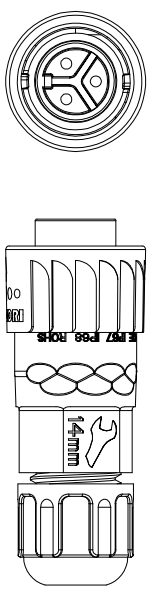
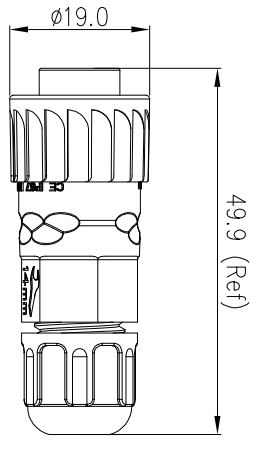
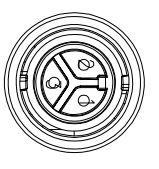
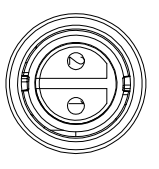
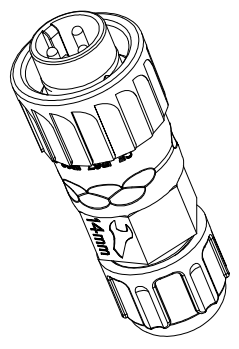

UNIT: mm		DESCRIPTION	
		Standard Series Push Lock Male Plug With Male Pin	
SCALE:	1:1	SHEET:	1 OF 1
REV:	C1	SIZE:	A4
* : Inspection Item			

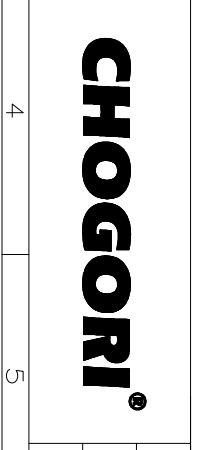

PART NO	22XXX131-01	DRAWN BY	Liu	DATE	2019/08/13
DWG NO		CHECKED BY	Mo	DATE	2019/08/13
CUSTOMER		APPROVED BY	Panison	DATE	2019/08/13