

# Speaker Box

with Grand speaker inside

**Order No.: BOX1-15121-L**

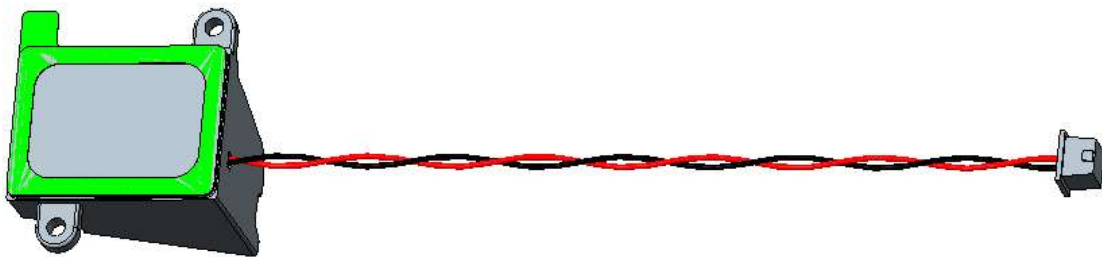

## Revision

<b>Date</b>	<b>Version</b>	<b>Status</b>	<b>Changes</b>	<b>Approver</b>
2016/08/08	V0.1	draft	First release	Jay
2017/10/11	V0.2	draft	Use new template	Jay

# 1. Mechanical Characteristics

## 1.1. Mechanical Drawing for speaker box (in mm)

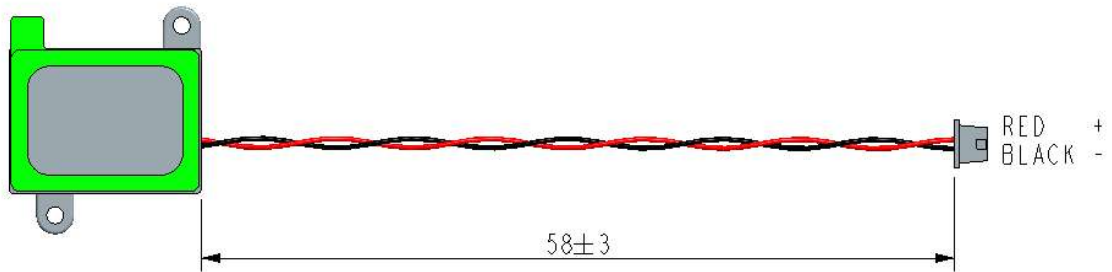
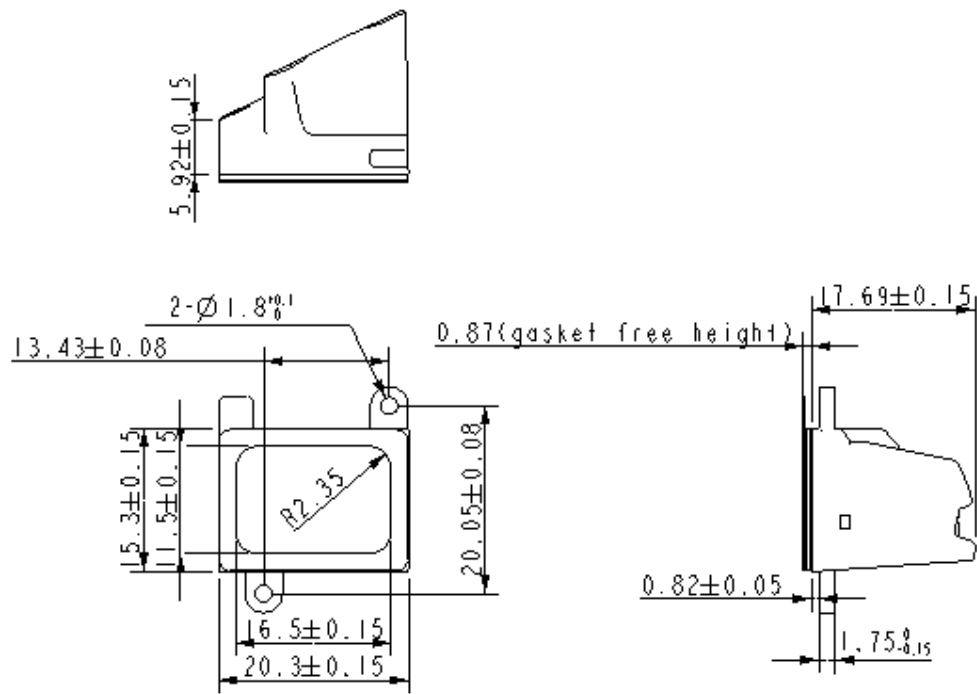

## 1.2. Exploded view

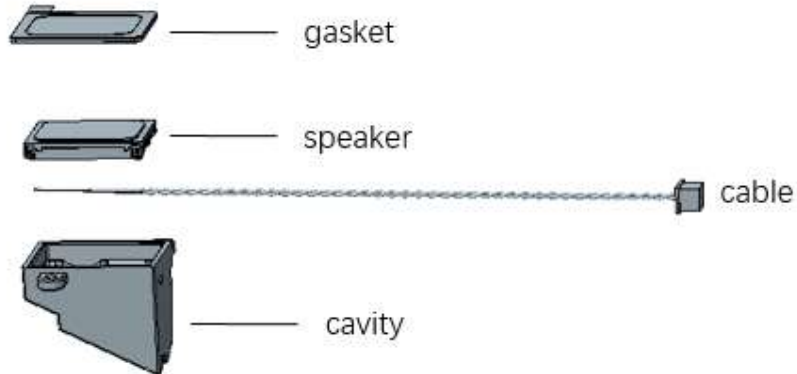

Missing information see specification Knowles Doc. 2403-260-00071

## 1.3. Stamp on Product

T.B.D

## 1.4. Material List

Speaker see specification	2403-260-00071
Gasket	Nitto 5605 & B045 & 92-25021
Cable	MOLEX-2P-1.25
Cavity	ABS/PC

## 2. Electro-acoustic Characteristics

### 2.1. Frequency Response & THD

Typical frequency response & THD test in baffle according to 2.2.

(Sine sweep @400mW, 3.16cm)

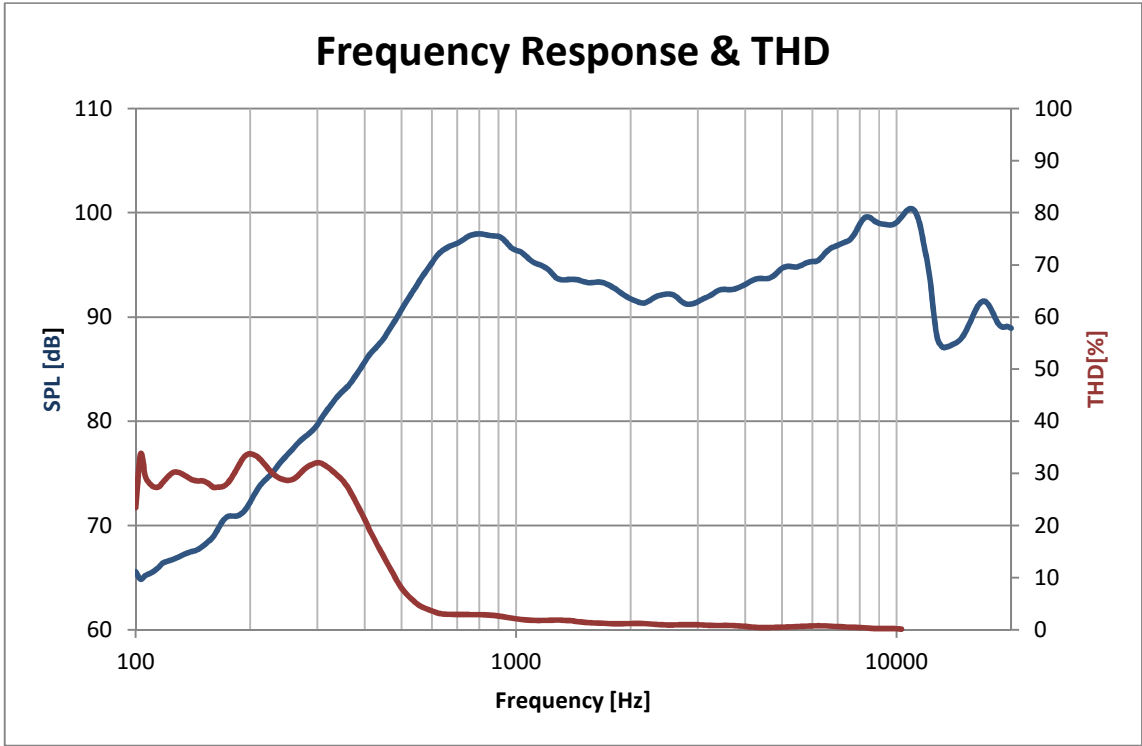

## 2.2. Measurement Setup

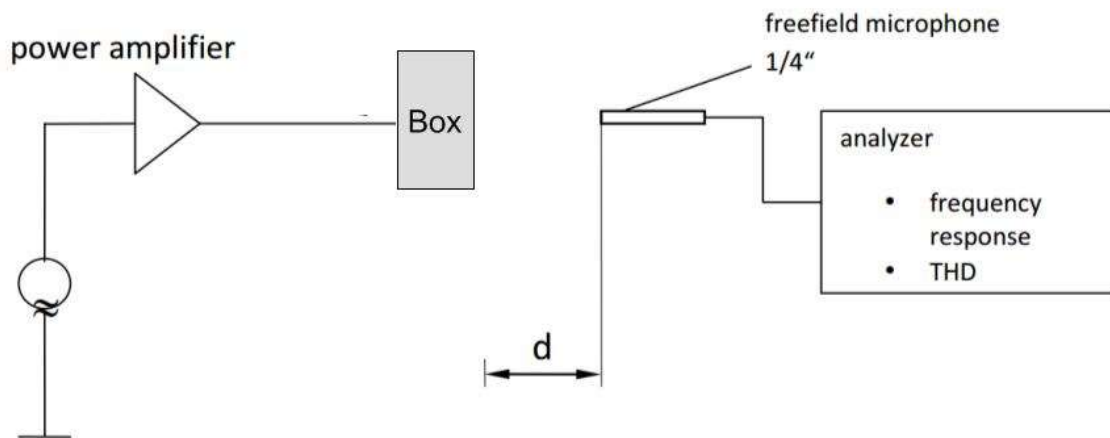

## 2.3. Electro-acoustic characteristics

- |   |                                   |
|---|-----------------------------------|
| 1. Rated impedance                        | Z: 8 $\Omega$                     |
| 2. Core speaker resonance frequency(1ccm) | f <sub>0</sub> : 700Hz $\pm$ 7.5% |
| 3. THD                                    | ACC. To 2.1.                      |
| 4. Rub & Buzz (at 350Mw)                  | no audible Rub & Buzz             |