

## TYPICAL SWITCH ORDERING EXAMPLE

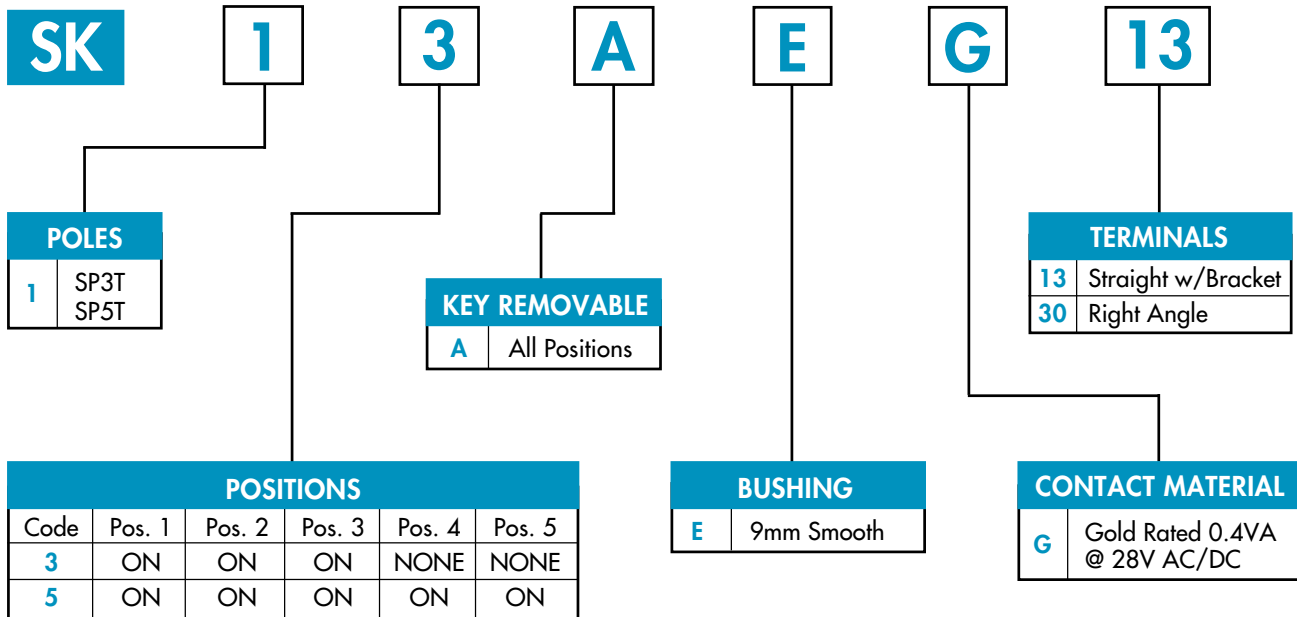

### DESCRIPTION FOR TYPICAL ORDERING EXAMPLE

#### SK13AEG13

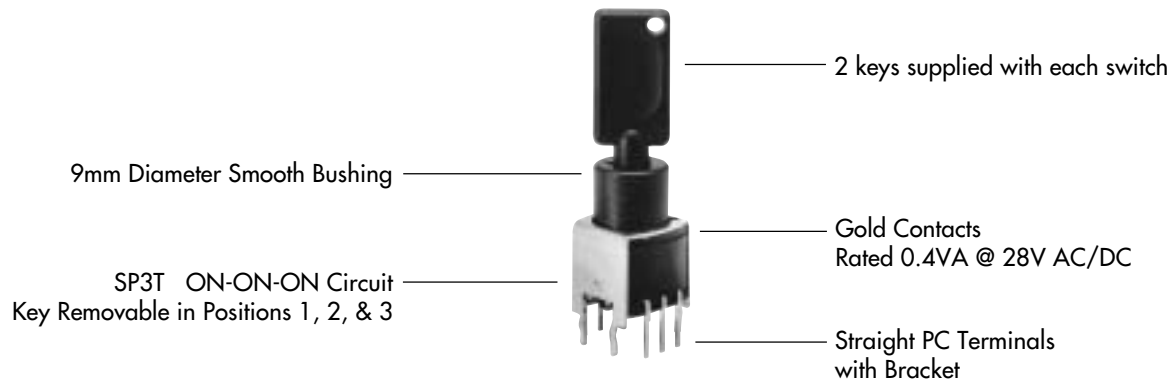

**GENERAL SPECIFICATIONS****Electrical Capacity (Resistive Load)**

**Power Level:** 0.4VA @ 28V AC/DC  
(Applicable Range 0.1mA ~ 0.1A @ 20mV ~ 28V)

**Other Ratings**

**Contact Resistance:** 100 milliohms maximum  
**Insulation Resistance:** 100 megohms minimum @ 500V DC  
**Dielectric Strength:** 500V AC minimum  
**Mechanical Life:** 30,000 cycles minimum  
**Electrical Life:** 20,000 cycles minimum  
**Static Capability:** Withstands 15 kilovolts ESD  
**Nominal Operating Torque:** 2.039 grams-cm (2.83 ounce-in)  
**Contact Timing:** Break before make  
**Angle of Throw:** 45° for 3-position & 5-position

**Materials & Finishes**

**Key:** Polyacetal  
**Housing/Bushing:** Glass fiber reinforced polyester (PBT)  
**Base:** Glass fiber reinforced polyamide  
**Rotor & Stopper:** Polyacetal  
**Tumbler Plate:** Brass  
**Movable Contactor:** Beryllium copper with gold plating over nickel  
**Stationary Contacts:** Phosphor bronze with tin-lead plating  
**Terminals:** Phosphor bronze with tin-lead plating  
**Mounting Bracket:** Steel with tin-lead plating

**Environmental Data**

**Operating Temp Range:** -25°C through +70°C (-13°F through +158°F)  
**Humidity:** 90 ~ 95% for 96 hours @ 40°C (104°F)  
**Vibration:** 10 ~ 55 Hz with peak-to-peak amplitude of 1.5mm traversing the frequency range & returning in 1 minute; 3 right angled directions for 2 hours  
**Shock:** 50g acceleration (tested in 6 right angled directions, with 5 shocks in each direction)

**Installation**

**Soldering Time & Temperature:** 3 seconds @ 350°C  
**Process Seal:** See Sealed Construction on Engineering Particulars.

## POLES, CIRCUITS, & KEY-REMOVABLE POSITIONS

Pole & Throw	Model	Key Positions					Connected Terminals (Terminal numbers are not on switch.)					Schematic	⊙ = Key Removable • = Not Removable ✓ = Maximum Arc
		Pos 1	Pos 2	Pos 3	Pos 4	Pos 5	Pos 1	Pos 2	Pos 3	Pos 4	Pos 5		
SP3T	SK13A	ON	ON	ON	----	----	COM-1	COM-2	COM-3	----	----		
SP5T	SK15A	ON	ON	ON	ON	ON	COM-1	COM-2	COM-3	COM-4	COM-5		

### KEY REMOVABLE

**A** All Positions (45° angular throw)

### BUSHING

**E** 9mm Smooth

## CONTACT MATERIAL & RATING

**G** Gold over Brass or Copper

Logic Level

0.4VA @ 28V AC/DC maximum

## TERMINALS

**13** Straight PC with Bracket

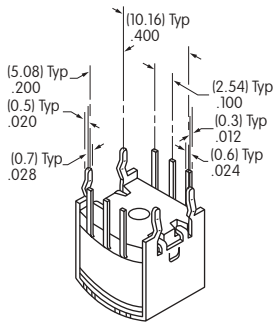

Single Pole

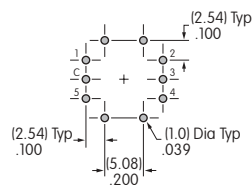

**30** Right Angle PC

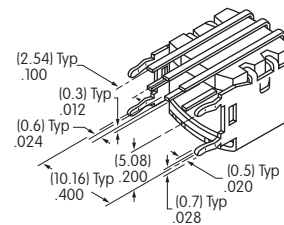

Single Pole

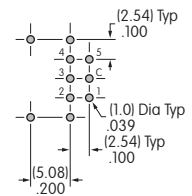

### KEY

#### AT4094 for Antistatic Subminiature Models

Polyacetal

2 keys provided with each switch  
(no master key available)

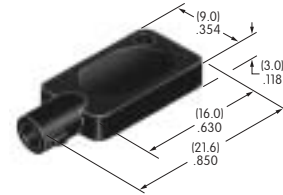

### TYPICAL SWITCH DIMENSIONS

#### Straight PC with Bracket

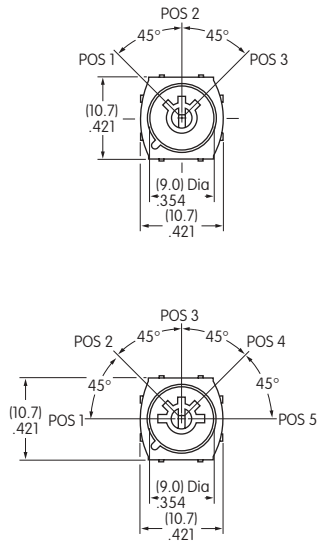

On 3-position models terminals 1 & 5 are support pins.

#### 3 Position

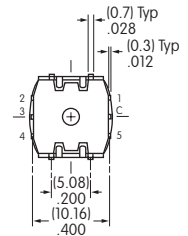
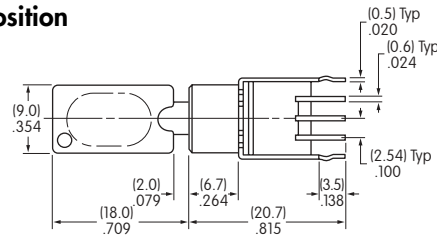

#### 5 Position

SK13AEG13

#### Right Angle PC

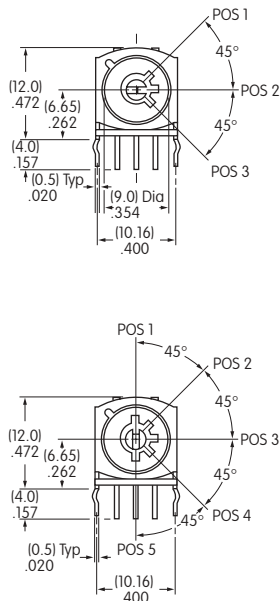
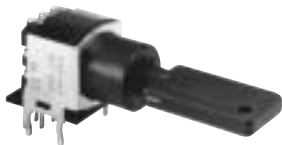

On 3-position models terminals 1 & 5 are support pins.

#### 3 Position

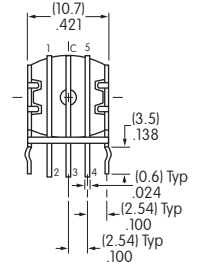
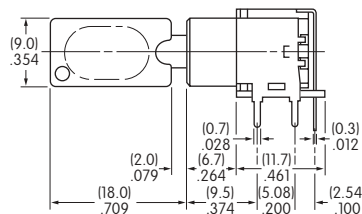

#### 5 Position

SK15AEG30